

WATER WELL RECORD Form WWC-5

Original Record Correction Change in Well Use

Division of Water Resources App. No.

Well ID

1 LOCATION OF WATER WELL: County: Reno Fraction: 1/4 SW 1/4 SW 1/4 SE 1/4 Section Number: 2 Township Number: T 26 S Range Number: R 10 E W

2 WELL OWNER: Last Name: Geising First: Gary Street or Rural Address where well is located (if unknown, distance and direction from nearest town or intersection): If at owner's address, check here:
 Business Address: 33909 W. Sun City Rd. From Turon go 2 1/2 EAST on W. Sun City Rd.
 City: Turon State: KS ZIP: 67583 Then 1/8 North & 100 ft East to well

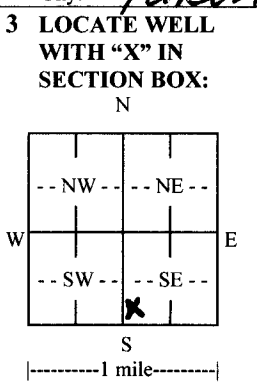

4 DEPTH OF COMPLETED WELL: 50 ft.
 Depth(s) Groundwater Encountered: 1) ft.
 2) ft. 3) ft., or 4) Dry Well
 WELL'S STATIC WATER LEVEL: 22 ft.
 below land surface, measured on (mo-day-yr).....
 above land surface, measured on (mo-day-yr) 12-30-15
 Pump test data: Well water was ft.
 after hours pumping gpm
 Well water was ft.
 after hours pumping gpm
 Estimated Yield 100 gpm
 Bore Hole Diameter: 9 5/8 in. to 50 ft. and
 in. to ft.

5 Latitude: (decimal degrees)
Longitude: (decimal degrees)
 Datum: WGS 84 NAD 83 NAD 27
 Source for Latitude/Longitude:
 GPS (unit make/model: (WAAS enabled? Yes No)
 Land Survey Topographic Map
 Online Mapper:

6 Elevation: ft. Ground Level TOC
 Source: Land Survey GPS Topographic Map
 Other

7 WELL WATER TO BE USED AS:

1. Domestic: Household Lawn & Garden Livestock
 2. Irrigation
 3. Feedlot
 4. Industrial
 5. Public Water Supply: well ID

6. Dewatering: how many wells?

7. Aquifer Recharge: well ID

8. Monitoring: well ID

9. Environmental Remediation: well ID

Air Sparge Soil Vapor Extraction
 Recovery Injection

10. Oil Field Water Supply: lease

11. Test Hole: well ID

Cased Uncased Geotechnical

12. Geothermal: how many bores?

a) Closed Loop Horizontal Vertical
 b) Open Loop Surface Discharge Inj. of Water

13. Other (specify):

Was a chemical/bacteriological sample submitted to KDHE? Yes No If yes, date sample was submitted:

Water well disinfected? Yes No

8 TYPE OF CASING USED: Steel PVC Other CASING JOINTS: Glued Clamped Welded Threaded
 Casing diameter 4 in. to 30 ft., Diameter in. to ft., Diameter in. to ft.
 Casing height above land surface 18 in. Weight 160 lbs./ft. Wall thickness or gauge No.

TYPE OF SCREEN OR PERFORATION MATERIAL:
 Steel Stainless Steel Fiberglass PVC Other (Specify)
 Brass Galvanized Steel Concrete tile None used (open hole)

SCREEN OR PERFORATION OPENINGS ARE:
 Continuous Slot Mill Slot Gauze Wrapped Torch Cut Drilled Holes Other (Specify)
 Louvered Shutter Key Punched Wire Wrapped Saw Cut None (Open Hole)

SCREEN-PERFORATED INTERVALS: From 30 ft. to 50 ft., From ft. to ft., From ft. to ft.
GRAVEL PACK INTERVALS: From 50 ft. to 21 ft., From ft. to ft., From ft. to ft.

9 GROUT MATERIAL: Neat cement Cement grout Bentonite Other

Grout Intervals: From 21 ft. to 0 ft., From ft. to ft., From ft. to ft.

Nearest source of possible contamination:
 Septic Tank Lateral Lines Pit Privy Livestock Pens Insecticide Storage
 Sewer Lines Cess Pool Sewage Lagoon Fuel Storage Abandoned Water Well
 Watertight Sewer Lines Seepage Pit Feedyard Fertilizer Storage Oil Well/Gas Well
 Other (Specify) Pasture

Direction from well? 999 Distance from well? 999 ft.

10 FROM	TO	LITHOLOGIC LOG	FROM	TO	LITHO. LOG (cont.) or PLUGGING INTERVALS
0	4	BIK TOP Soil			
4	13	Tan clay			
13	31	Fine Tan Sand			
31	44	COARSE SAND			
44	50	SMALL GRAVEL			

Notes:

11 CONTRACTOR'S OR LANDOWNER'S CERTIFICATION: This water well was constructed, reconstructed, or plugged under my jurisdiction and was completed on (mo-day-year) 12-30-15 and this record is true to the best of my knowledge and belief. Kansas Water Well Contractor's License No. 672 This Water Well Record was completed on (mo-day-year) 12-31-15 under the business name of Crowdis Water Well Serv.