

WATER WELL RECORD Form WWC-5

Division of Water Resources App. No.

MW4

Original Record Correction Change in Well Use

Well ID

1 LOCATION OF WATER WELL: County: RENO Fraction SW 1/4 SE 1/4 NE 1/4 SE 1/4 Section Number 5 Township Number T 26S S Range Number R 10 E W

2 WELL OWNER: Last Name: Business: KDHE-BER Address: 1000 SW JACKSON City: TOPEKA State: KS ZIP: 66612-1367 Street or Rural Address where well is located: 112 W. HWY 61, TURON, KS

3 LOCATE WELL WITH 'X' IN SECTION BOX: [Diagram] 4 DEPTH OF COMPLETED WELL: 35 ft. 5 Latitude: 37.81025 Longitude: 98.43054 Elevation: 1752.15 ft.

7 WELL WATER TO BE USED AS: 1. Domestic: 2. Irrigation 3. Feedlot 4. Industrial 5. Public Water Supply 6. Dewatering 7. Aquifer Recharge 8. Monitoring 9. Environmental Remediation 10. Oil Field Water Supply 11. Test Hole 12. Geothermal 13. Other

Was a chemical/bacteriological sample submitted to KDHE? Water well disinfected?

8 TYPE OF CASING USED: 2 in. to 35 ft. CASING JOINTS: Threaded TYPE OF SCREEN OR PERFORATION MATERIAL: Mill Slot SCREEN OR PERFORATION OPENINGS ARE: Mill Slot SCREEN-PERFORATED INTERVALS: 20 ft. to 35 ft. GRAVEL PACK INTERVALS: 18 ft. to 35 ft.

9 GROUT MATERIAL: Neat cement Cement grout Bentonite Concrete Surface Completion 0-1 Grout Intervals: 0 ft. to 1 ft. Nearest source of possible contamination: Septic Tank Lateral Lines Pit Privy Livestock Pens Insecticide Storage

Table with columns: 10 FROM, TO, LITHOLOGIC LOG, FROM, TO, LITHO. LOG (cont.) or PLUGGING INTERVALS. Rows: 0-.5 GRAVEL, .5-8 SILTY CLAY, 8-14 SANDY CLAY, 14-35 SAND.

11 CONTRACTOR'S OR LANDOWNER'S CERTIFICATION: This water well was constructed, reconstructed, or plugged under my jurisdiction and was completed on (mo-day-year) 1/22/19 and this record is true to the best of my knowledge and belief. Kansas Water Well Contractor's License No. 585 This Water Well Record was completed on (mo-day-year) 2/8/19 under the business name of ASSOCIATED ENVIRONMENTAL, INC. Signature [Signature]

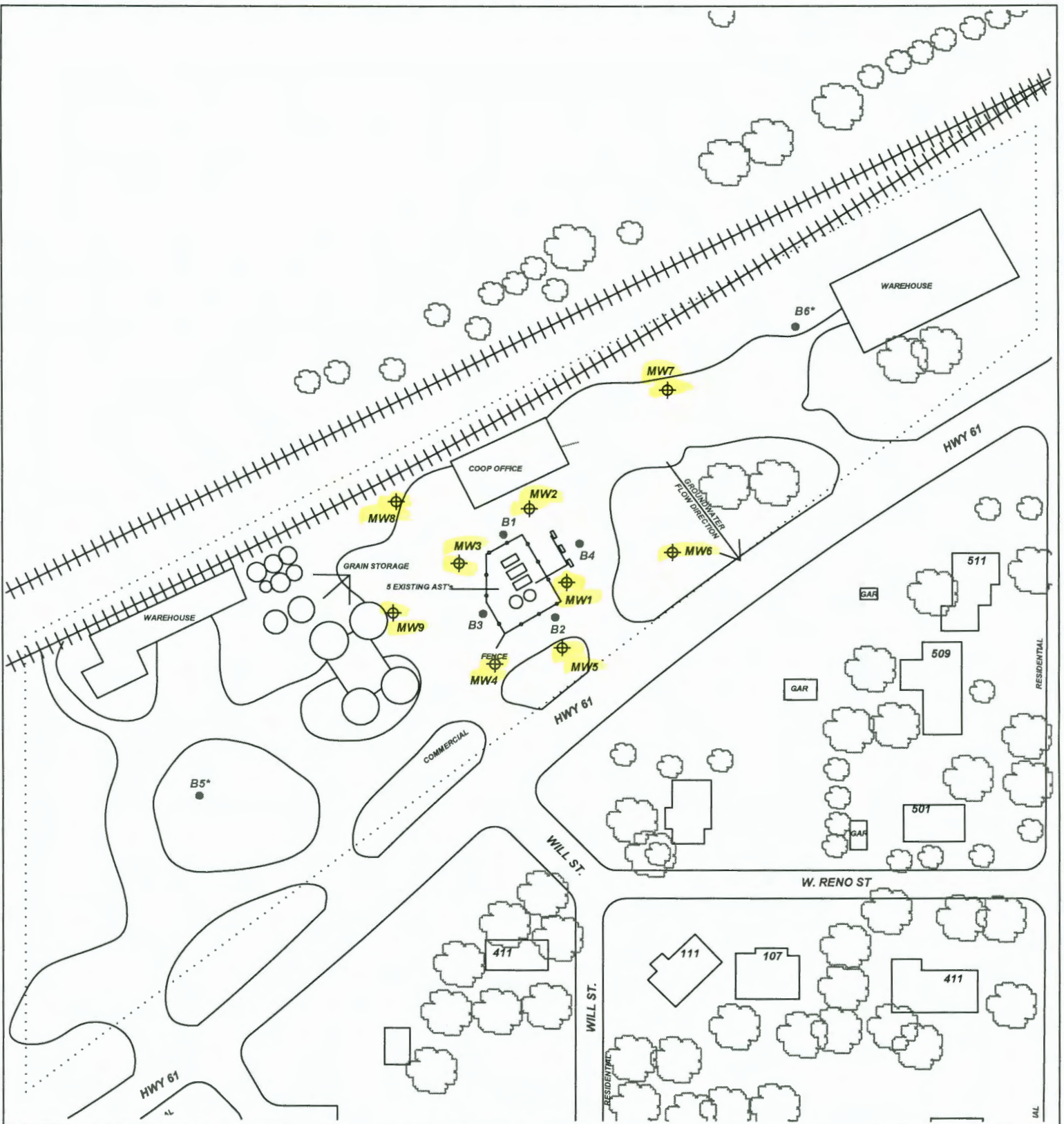

PROJECT: **TURON CARDTROL**

ADDRESS: **112 W HWY 61**

LOCATION: **TURON, KS**

DRAWN BY: **B. STALNAKER** DATE: **10/10/18**

REVISED BY: **B. STALNAKER** DATE: **1/24/19**

AEI JOB #: **TM242** KDHE JOB #: **A2-078-40488**

TITLE: **FIGURE 2.2
AREA BASE MAP
350' RADIUS**

AEI ASSOCIATED ENVIRONMENTAL INC.

LEGEND:

- = CURRENT PUMP ISLANDS
- = PROPOSED MONITORING WELL
- = PROPOSED SOIL BORING
- = SUBJECT PROPERTY

RECEIVED
FEB 26 2019
BUREAU OF WATER

SCALE: **1" = 100'**

NOTES: * = Indicates boring for unsaturated and saturated zone hydrologic data.
No basements observed within 500'.