

LOCATION OF WATER WELL		Fraction			Section Number	Township Number		Range Number	
County: <u>Pratt</u>		<u>SE 1/4</u>	<u>SE 1/4</u>	<u>SE 1/4</u>	<u>1</u>	<u>T 26 S</u>		<u>R 11 NW</u>	

Distance and direction from nearest town or city? TWO MI WEST OF TURON Street address of well if located within city?

WATER WELL OWNER: KGS/GWMD#5
 RR#, St. Address, Box # :
 City, State, ZIP Code :
 Board of Agriculture, Division of Water Resources
 Application Number: NA

DEPTH OF COMPLETED WELL... 48 ft. Bore Hole Diameter... 9 7/8 in. to ft., and in. to ft.
 Well Water to be used as:
 1 Domestic 3 Feedlot 5 Public water supply 8 Air conditioning 11 Injection well
 2 Irrigation 4 Industrial 6 Oil field water supply 9 Dewatering 12 Other (Specify below)
Research
 7 Lawn and garden only 10 Observation well
 Well's static water level 25.4 ft. below land surface measured on Jan month 28 day 1983 year
 Pump Test Data : Well water was ft. after hours pumping gpm
 Sust. Yield : gpm: Well water was ft. after hours pumping gpm

TYPE OF BLANK CASING USED:
 1 Steel 3 RMP (SR) 5 Wrought iron 8 Concrete tile Casing Joints: Glued Clamped
2 PVC 4 ABS 6 Asbestos-Cement 9 Other (specify below) Welded
 7 Fiberglass Threaded
 Blank casing dia 5.0 in. to 43 in. Dia in. to ft., Dia in. to ft.
 Casing height above land surface in., weight lbs./ft. Wall thickness or gauge No. Schd #40

TYPE OF SCREEN OR PERFORATION MATERIAL:
 1 Steel 3 Stainless steel 5 Fiberglass 8 RMP (SR) 10 Asbestos-cement
 2 Brass 4 Galvanized steel 6 Concrete tile 9 ABS 11 Other (specify)
 12 None used (open hole)
 Screen or Perforation Openings Are:
 1 Continuous slot 3 Mill slot 5 Gauzed wrapped 8 Saw cut 11 None (open hole)
 2 Louvered shutter 4 Key punched 7 Torch cut 10 Other (specify)
 Screen-Perforation Dia 5.0 in. to ft. Dia in. to ft., Dia in. to ft.
 Screen-Perforated Intervals: From 43 ft. to 45 ft., From ft. to ft.
 From ft. to ft., From ft. to ft.
 Travel Pack Intervals: From 43 ft. to 45 ft., From ft. to ft.
 From ft. to ft., From ft. to ft.

GROUT MATERIAL: 1 Neat cement 2 Cement grout 3 Bentonite 4 Other
 Grouted Intervals: From 0 ft. to 10 ft., From ft. to ft., From ft. to ft.

What is the nearest source of possible contamination: none known 10 Fuel storage 14 Abandoned water well
 1 Septic tank 4 Cess pool 7 Sewage lagoon 11 Fertilizer storage 15 Oil well/Gas well
 2 Sewer lines 5 Seepage pit 8 Feed yard 12 Insecticide storage 16 Other (specify below)
 3 Lateral lines 6 Pit privy 9 Livestock pens 13 Watertight sewer lines
 Direction from well How many feet ? Water Well Disinfected? Yes No
 Has a chemical/bacteriological sample submitted to Department? Yes No If yes, date sample
 is submitted month day year: Pump Installed? Yes No
 Yes: Pump Manufacturer's name Model No. HP Volts
 Depth of Pump Intake ft. Pumps Capacity rated at gal./min.
 Type of pump: 1 Submersible 2 Turbine 3 Jet 4 Centrifugal 5 Reciprocating 6 Other

CONTRACTOR'S OR LANDOWNER'S CERTIFICATION: This water well was (1) constructed, (2) reconstructed, or (3) plugged under my jurisdiction and was
 completed on 9 month 22 day 81 year
 and this record is true to the best of my knowledge and belief. Kansas Water Well Contractor's License No.
 This Water Well Record was completed on month day year under the business
 name of by (signature)

LOCATE WELL'S LOCATION WITH AN "X" IN SECTION BOX:			LITHOLOGIC LOG				LITHOLOGIC LOG	
	FROM	TO	FROM	TO	FROM	TO	FROM	TO

ELEVATION: 1767.2

Depth(s) Groundwater Encountered 1 ft. 2 ft. 3 ft. 4 ft. (Use a second sheet if needed)

INSTRUCTIONS: Use typewriter or ball point pen, please press firmly and PRINT clearly. Please fill in blanks, underline or circle the correct answers. Send top three copies to Kansas Department of Health and Environment, Division of Environment, Water Well Contractors, Topeka, KS 66620. Send one to WATER WELL OWNER and retain one for your records.

SITE NUMBER : 21
SITE LOCATION : SE SE SE
LEGAL LOCATION: SE1 T26S R11W
COUNTY : PRATT

LANDOWNER: RON SCHWERTFEGER
ADDRESS : RURAL ROUTE 1
TURON, KANSAS 67583
PHONE NO.: 316-497-6905

Elw. 1801

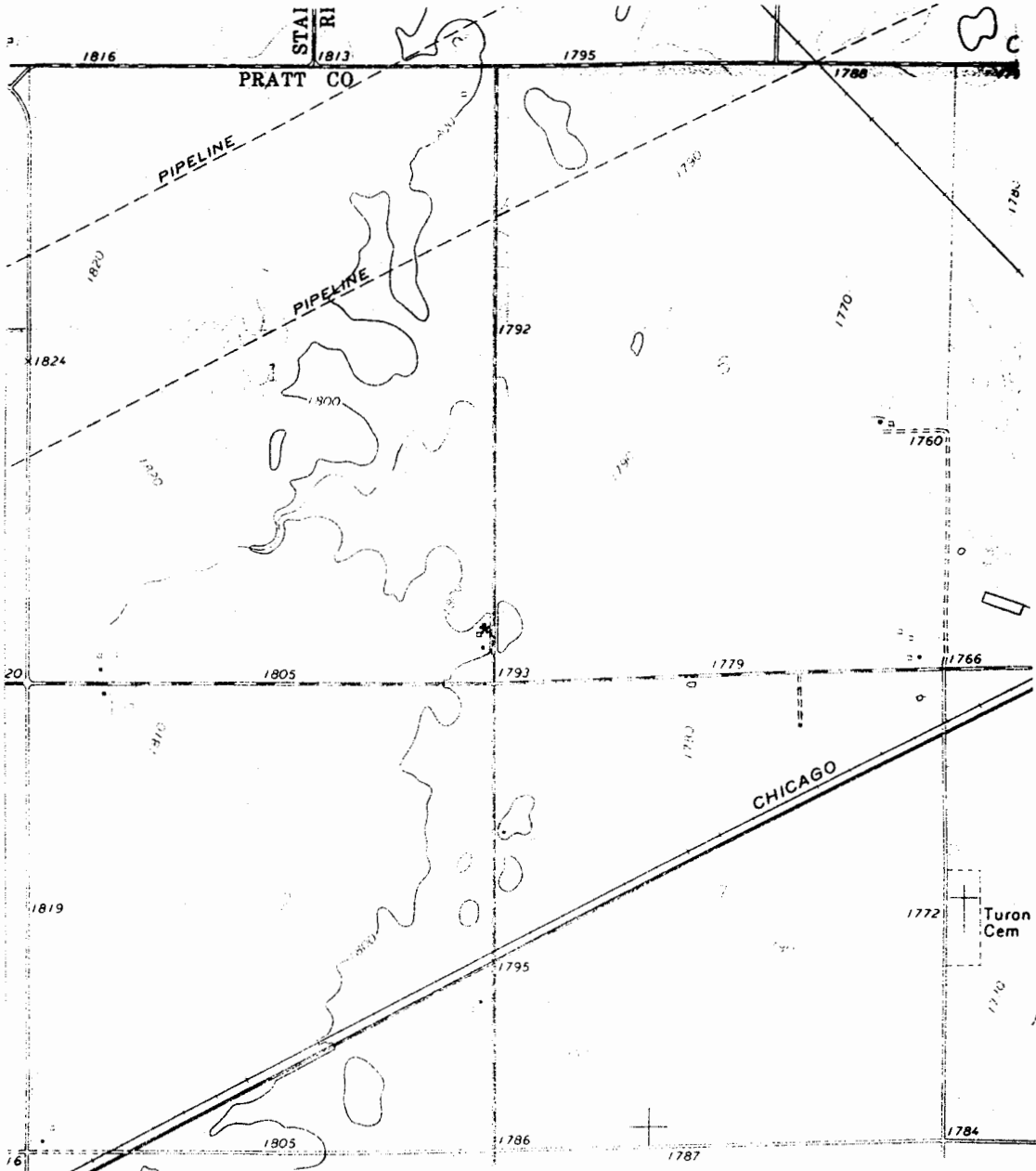

WELL LOCATION *

