

WATER WELL RECORD

Form WWC-5

Division of Water Resources App. No.

1 LOCATION OF WATER WELL: County: Pratt Fraction 1/4 NE 1/4 SW 1/4 NE 1/4 Section Number 27 Township No. T 26 S Range Number R 13 E W

Street/Rural Address of Well Location; if unknown, distance & direction from nearest town or intersection: If at owner's address, check here 1N of Iuka, KS Global Positioning System (GPS) information: Latitude: Longitude: Elevation: Datum: Collection Method: Est. Accuracy:

2 WATER WELL OWNER: Larry Briggeman RR#, Street Address, Box #: 50441 N Hwy 281 City, State, ZIP Code : Iuka, KS 67066

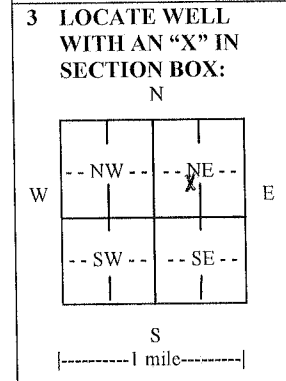

3 LOCATE WELL WITH AN "X" IN SECTION BOX: 4 DEPTH OF COMPLETED WELL 140 ft. Depth(s) Groundwater Encountered (1) 60 ft. (2) ft. (3) ft. WELL'S STATIC WATER LEVEL 60 ft. below land surface measured on mo/day/yr. 03/13/13. Pump test data: Well water was ft. after hours pumping gpm EST. YIELD 80 gpm. Well water was ft. after hours pumping gpm Bore Hole Diameter in. to ft., and in. to ft. WELL WATER TO BE USED AS: Public water supply Geothermal Injection well Domestic Feedlot Oil field water supply Dewatering Other (Specify below) Irrigation Industrial Domestic-lawn & garden Monitoring well Was a chemical/bacteriological sample submitted to Department? Yes No If yes, mo/day/yr sample was submitted. Water well disinfected? Yes No

5 TYPE OF CASING USED: Steel PVC Other CASING JOINTS: Glued Clamped Welded Threaded Casing diameter .5 in. to 120 ft., Diameter in. to ft., Diameter in. to ft. Casing height above land surface 12 in., Weight 2.8 lbs./ft., Wall thickness or gauge No. Sch. 40 TYPE OF SCREEN OR PERFORATION MATERIAL: Steel Stainless Steel PVC Brass Galvanized Steel None used (open hole) SCREEN OR PERFORATION OPENINGS ARE: Continuous slot Mill slot Gauze wrapped Torch cut Drilled holes None (open hole) Louvered shutter Key punched Wire wrapped Saw cut Other (specify) SCREEN-PERFORATED INTERVALS: From 120 ft. to 140 ft., From ft. to ft. GRAVEL PACK INTERVALS: From 23 ft. to 140 ft., From ft. to ft. From ft. to ft. From ft. to ft.

6 GROUT MATERIAL: Neat cement Cement grout Bentonite Other Grout Intervals: From 0 ft. to 23 ft., From ft. to ft., From ft. to ft. What is the nearest source of possible contamination: Septic tank Lateral lines Pit privy Livestock pens Insecticide storage Other (specify below) Sewer lines Cesspool Sewage lagoon Fuel storage Abandoned water well Watertight sewer lines Seepage pit Feedyard Fertilizer storage Oil well/gas well Direction from well South Distance from well 125

Table with columns: FROM, TO, LITHOLOGIC LOG, FROM, TO, LITHO. LOG (cont.) or PLUGGING INTERVALS. Rows include: 0-2 top soil, 2-65 clay, 65-110 sandy clay, 110-140 sand and gravel. Briggeman Farms 2-27, Sterling Drilling Company, P O Box 1006, Pratt, KS 67124.

7 CONTRACTOR'S OR LANDOWNER'S CERTIFICATION: This water well was constructed, reconstructed, or plugged under my jurisdiction and was completed on (mo/day/year) 03/13/13 and this record is true to the best of my knowledge and belief. Kansas Water Well Contractor's License No. 186 This Water Well Record was completed on (mo/day/year) 03/20/13 under the business name of Kelly's Water Well Service, Inc. by (signature) Kelly's Water Well Service, Inc.

INSTRUCTIONS: Use typewriter or ball point pen. PLEASE PRESS FIRMLY and PRINT clearly. Please fill in blanks and check the correct answers. Send three copies (white, blue, pink) to Kansas Department of Health and Environment, Bureau of Water, Geology Section, 1000 SW Jackson St., Suite 420, Topeka, Kansas 66612-1367. Telephone 785-296-5524. Send one copy to WATER WELL OWNER and retain one for your records. Include fee of \$5.00 for each constructed well. Visit us at http://www.kdheks.gov/waterwell/index.html.