

Cargill West Ag Well

1	LOCATION OF WATER WELL:	Fraction	Section Number	Township Number	Range Number
	County: <u>Ford</u>	<u>SE 1/4 NW 1/4 SE 1/4</u>	<u>32</u>	<u>26 S</u>	<u>24</u> E(N)

Distance and direction from nearest town or city street address of well if located within city?
From Intersection of HWY 400 + 114 Rd Go S 0.02 mile + W. 0.3/mile N 37° 44.371'
W 99° 57.956'

2	WATER WELL OWNER: <u>Cargill</u> RR #, St. Address, Box #: <u>3201 E. Trail P.O. box 1060</u> City, State, ZIP Code: <u>Dodge City KS, 67801</u>	Board of Agriculture, Division of Water Resources Application Number:
---	--	--

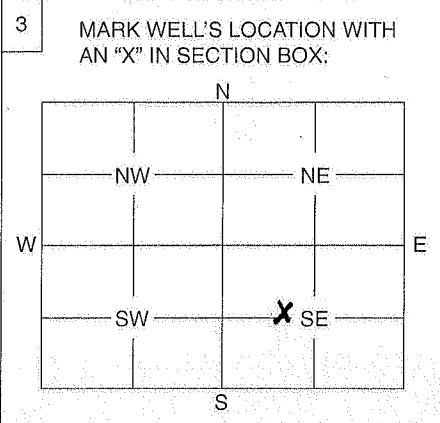

4	DEPTH OF WELL <u>144'</u> ft. WELL'S STATIC WATER LEVEL <u>60'</u> ft. WELL WAS USED AS: <table style="width: 100%; border: none;"> <tr> <td style="width: 33%;">1 Domestic</td> <td style="width: 33%;">5 Public Water Supply</td> <td style="width: 33%;">9 Dewatering</td> </tr> <tr> <td>2 Irrigation</td> <td>6 Oil Field Water Supply</td> <td>10 Monitoring Well</td> </tr> <tr> <td>3 Feedlot</td> <td>7 Domestic (Lawn & Garden)</td> <td>11 Injection Well</td> </tr> <tr> <td>4 Industrial</td> <td>8 Air Conditioning</td> <td>12 Other</td> </tr> </table> <p>Was a chemical / bacteriological sample submitted to Department? Yes No <u>X</u> If yes, mo/day/yr sample was submitted</p> <p>Water Well Disinfected: Yes <u>X</u> No</p>	1 Domestic	5 Public Water Supply	9 Dewatering	2 Irrigation	6 Oil Field Water Supply	10 Monitoring Well	3 Feedlot	7 Domestic (Lawn & Garden)	11 Injection Well	4 Industrial	8 Air Conditioning	12 Other
1 Domestic	5 Public Water Supply	9 Dewatering											
2 Irrigation	6 Oil Field Water Supply	10 Monitoring Well											
3 Feedlot	7 Domestic (Lawn & Garden)	11 Injection Well											
4 Industrial	8 Air Conditioning	12 Other											

5 TYPE OF BLANK CASING USED:

1 Steel	3 RMP (SR)	5 Wrought	7 Fiberglass	9 Other (Specify below)
2 PVC	4 ABS	6 Asbestos-Cement	8 Concrete Tile	

Blank casing diameter 16" in. Was casing pulled? Yes X No If yes, how much 4'
 Casing height above or below land surface 48 in.

6 GROUT PLUG MATERIAL: Neat cement Cement grout Bentonite Other

Grout Plug Intervals: From 4' BGL to 25' BGL ft., From ft. to ft., From to ft.

What is the nearest source of possible contamination:

1 Septic tank	6 Seepage pit	11 Fuel storage
2 Sewer lines	7 Pit privy	12 Fertilizer storage
3 Watertight sewer lines	8 Sewage lagoon	13 Insecticide storage
4 Lateral lines	9 Feedyard	14 Abandoned water well
5 Cess pool	10 Livestock pens	15 Oil well/Gas well

16 Other (specify below)
None known

Direction from well? How many feet?

FROM	TO	PLUGGING MATERIALS
<u>144'</u>	<u>25'</u>	<u>chlorinated Gravel</u>
<u>25'</u>	<u>4' BGL</u>	<u>cement Grout</u>
<u>4'</u>	<u>0'</u>	<u>Top Soil</u>

7 CONTRACTOR'S OF LANDOWNER'S CERTIFICATION: This water well was plugged under my jurisdiction and was completed on (mo/day/year) 8-11-92 8-12-11 and this record is true to the best of my knowledge and belief. Kansas Water Well Contractor's License No. 102 This Water Well Record was completed on (mo/day/year) under the business name of Layne Christensen Co. by (signature) [Signature]

INSTRUCTIONS: Use typewriter or ball point pen. Please press firmly and print clearly. Please fill in blanks, underline or circle the correct answers. Send top three copies to Kansas Department of Health and Environment, Bureau of Water, Geology Section, 1000 SW Jackson St., Ste. 420, Topeka, Kansas 66612-1367. Telephone: 785/296-5522. Send one to Water Well Owner and retain one for your records.

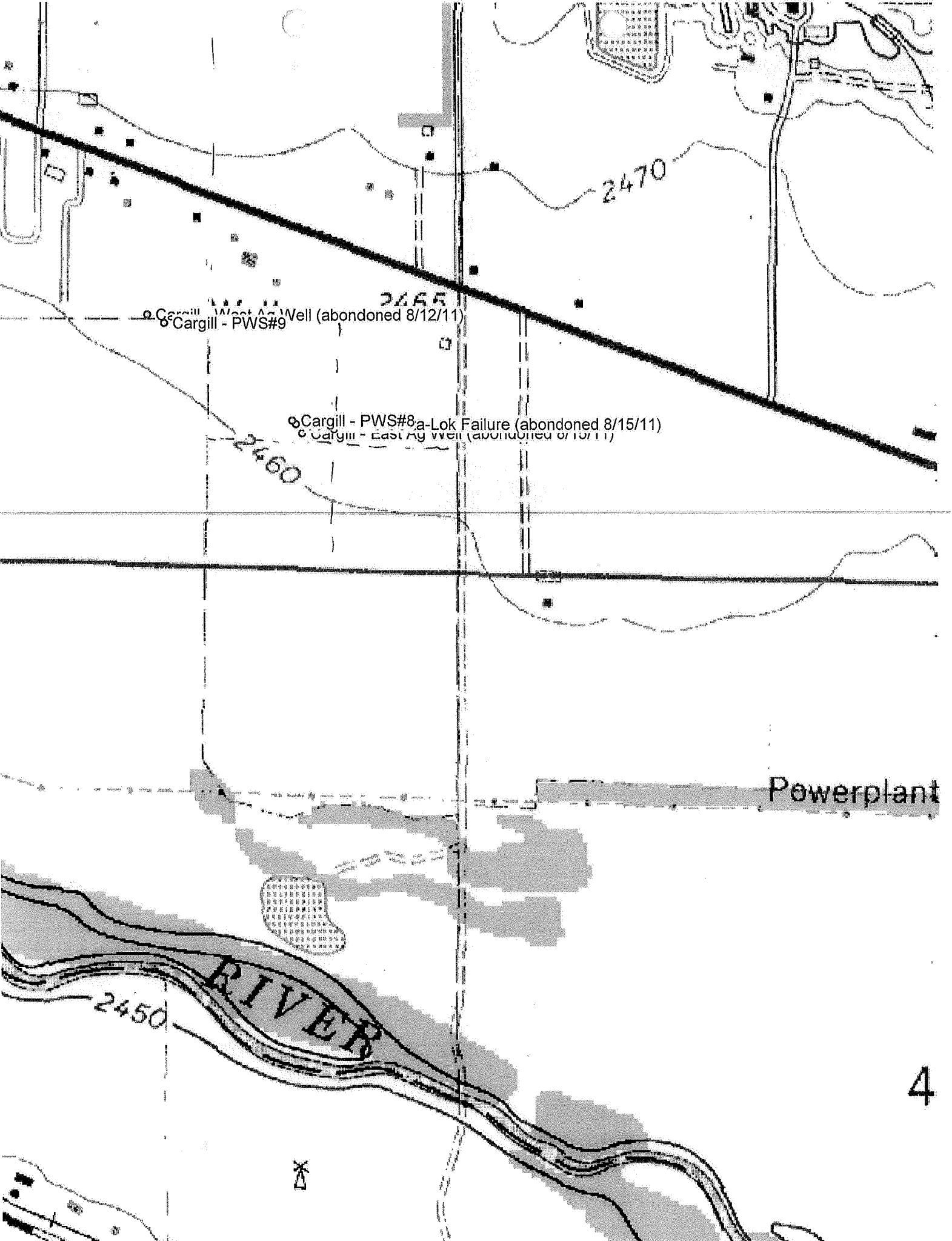

○ Cargill - West Ag Well (abandoned 8/12/11)
○ Cargill - PWS#9

○ Cargill - PWS#8 a-Lok Failure (abandoned 8/15/11)
○ Cargill - East Ag Well (abandoned 8/15/11)

Powerplant

RIVER

o Carill - West Ag Well (abandoned 8/12/11)
o Cargill - East Ag Well (abandoned 8/15/11)

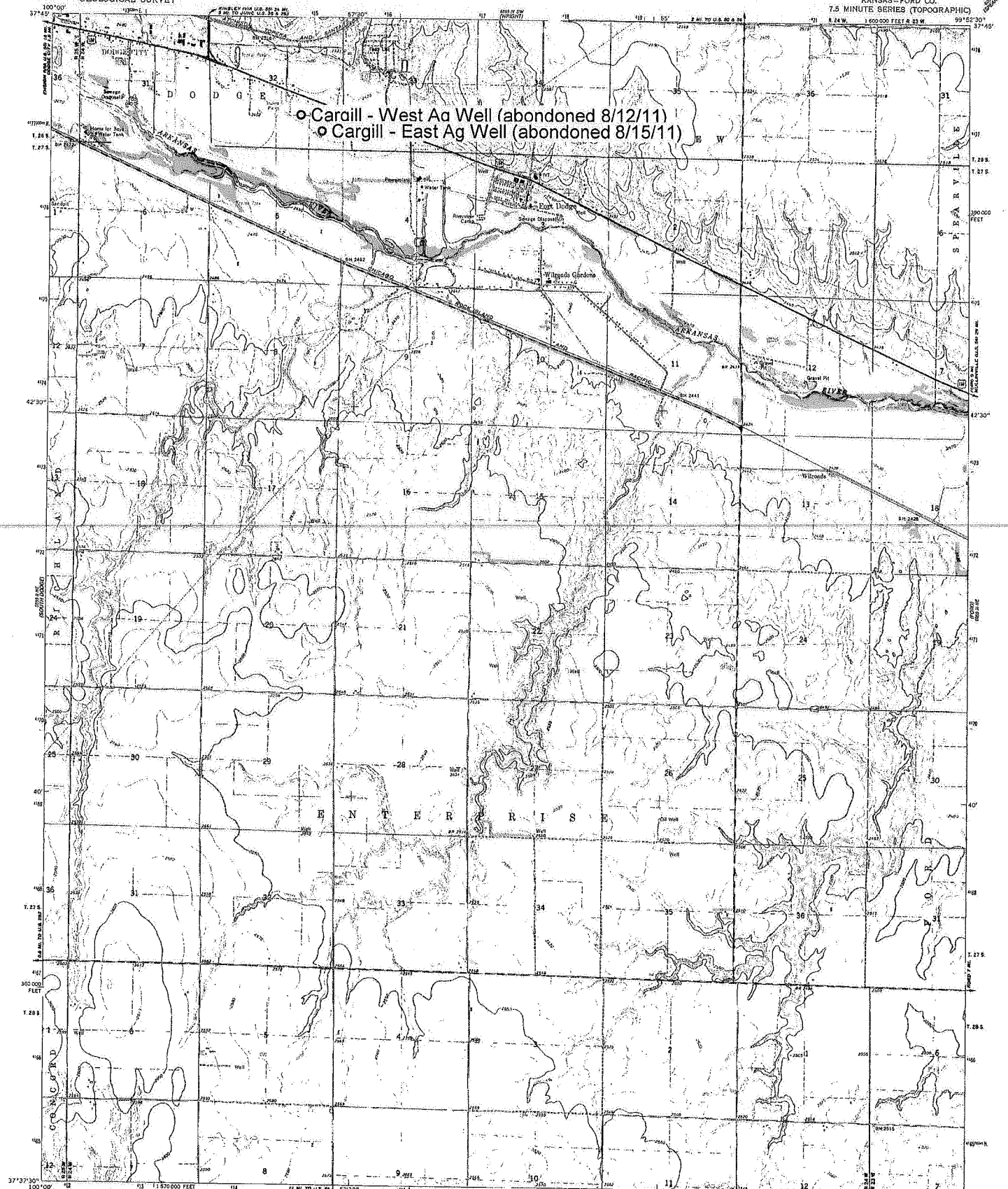

Mapped, edited, and published by the Geological Survey
Control by USGS and USCGS
Topography by photogrammetric methods from aerial
photographs taken 1965. Field checked 1969
Polyconic projection. 1927 North American datum
10,000-foot grid based on Kansas coordinate system, south zone
1,000-meter Universal Transverse Mercator grid ticks,
zone 14, shown in blue
Fine red dashed lines indicate selected fence and field lines where
generally visible on aerial photographs. This information is unchecked
and subject to change from aerial photography taken
1977. Map dated 1978. This information and field checked

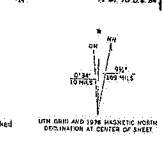

FORT DODGE SW
CORNER OF SW
SCALE 1:24,000
CONTOUR INTERVAL 10 FEET
NATIONAL GEODETIC VERTICAL DATUM OF 1929



ROAD CLASSIFICATION

Primary highway, all weather, hard surface	Light-duty road, all weather, improved surface
Secondary highway, all weather, hard surface	Unimproved road, fair or dry weather
U. S. Route	

THIS MAP COMPLETES WITH NATIONAL MAP ACCURACY STANDARDS
FOR SALE BY U. S. GEOLOGICAL SURVEY, DENVER, COLORADO 80225, OR RESTON, VIRGINIA 22092
AND STATE GEOLOGICAL SURVEY, LAWRENCE, KANSAS 66044
A FOLDER DESCRIBING TOPOGRAPHIC MAPS AND SYMBOLS IS AVAILABLE ON REQUEST

FORT DODGE, KANS.
N3737.5-W9952.5/7.5
1969
PUBLISHED BY THE GEOLOGICAL SURVEY
AND STATE GEOLOGICAL SURVEY