

East Well

1	LOCATION OF WATER WELL:	Fraction	Section Number	Township Number	Range Number
	County: <u>Ford</u>	<u>NW 1/4 SE 1/4 SE 1/4</u>	<u>32</u>	<u>26 S</u>	<u>24</u> <span style="float: right;">(EW)</span>

Distance and direction from nearest town or city street address of well if located within city?  
From Intersection of Hwy 400 + 11th Rd to S. 22nd St + W. 16 miles N 37° 44.277'  
W 99° 57.790'

2	WATER WELL OWNER:	Board of Agriculture, Division of Water Resources
	<u>CA-911</u>	Application Number:
	RR #, St. Address, Box #: <u>3201 E. Trail P.O. Box 1060</u>	
	City, State, ZIP Code: <u>Dodge City, KS, 67801</u>	

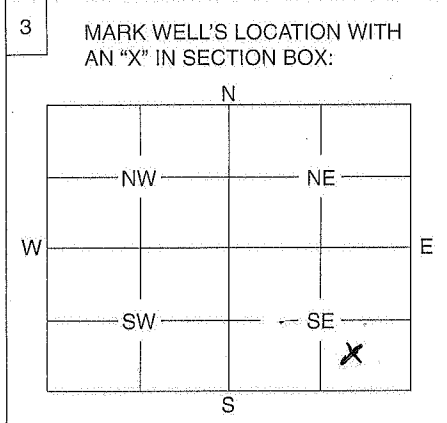

4	DEPTH OF WELL..... ft.												
	WELL'S STATIC WATER LEVEL..... ft. <u>60'</u>												
	WELL WAS USED AS:												
	<table border="0"> <tr> <td>1 Domestic</td> <td><input checked="" type="checkbox"/> 5 Public Water Supply</td> <td>9 Dewatering</td> </tr> <tr> <td>2 Irrigation</td> <td>6 Oil Field Water Supply</td> <td>10 Monitoring Well</td> </tr> <tr> <td>3 Feedlot</td> <td>7 Domestic (Lawn &amp; Garden)</td> <td>11 Injection Well</td> </tr> <tr> <td>4 Industrial</td> <td>8 Air Conditioning</td> <td>12 Other .....</td> </tr> </table>	1 Domestic	<input checked="" type="checkbox"/> 5 Public Water Supply	9 Dewatering	2 Irrigation	6 Oil Field Water Supply	10 Monitoring Well	3 Feedlot	7 Domestic (Lawn & Garden)	11 Injection Well	4 Industrial	8 Air Conditioning	12 Other .....
1 Domestic	<input checked="" type="checkbox"/> 5 Public Water Supply	9 Dewatering											
2 Irrigation	6 Oil Field Water Supply	10 Monitoring Well											
3 Feedlot	7 Domestic (Lawn & Garden)	11 Injection Well											
4 Industrial	8 Air Conditioning	12 Other .....											
	Was a chemical / bacteriological sample submitted to Department? Yes ..... No <input checked="" type="checkbox"/>												
	If yes, mo/day/yr sample was submitted .....												
	Water Well Disinfected: Yes <input checked="" type="checkbox"/> No .....												

5 TYPE OF BLANK CASING USED:

<input checked="" type="checkbox"/> 1 Steel	<input type="checkbox"/> 3 RMP (SR)	<input type="checkbox"/> 5 Wrought	<input type="checkbox"/> 7 Fiberglass	<input type="checkbox"/> 9 Other (Specify below)
<input checked="" type="checkbox"/> 2 PVC	<input type="checkbox"/> 4 ABS	<input type="checkbox"/> 6 Asbestos-Cement	<input type="checkbox"/> 8 Concrete Tile	

Blank casing diameter 16 in. Was casing pulled? Yes  No ..... If yes, how much 48"  
Casing height above or below land surface 4' in.

6 GROUT PLUG MATERIAL:  1 Neat cement  2 Cement grout  3 Bentonite  4 Other .....

Grout Plug Intervals: From ..... ft. to ..... ft., From 25' ft. to 4' ft., From ..... to ..... ft.

What is the nearest source of possible contamination:

<input type="checkbox"/> 1 Septic tank	<input type="checkbox"/> 6 Seepage pit	<input type="checkbox"/> 11 Fuel storage	<input checked="" type="checkbox"/> 16 Other (specify below)
<input type="checkbox"/> 2 Sewer lines	<input type="checkbox"/> 7 Pit privy	<input type="checkbox"/> 12 Fertilizer storage	<u>None known</u>
<input type="checkbox"/> 3 Watertight sewer lines	<input type="checkbox"/> 8 Sewage lagoon	<input type="checkbox"/> 13 Insecticide storage	
<input type="checkbox"/> 4 Lateral lines	<input type="checkbox"/> 9 Feedyard	<input type="checkbox"/> 14 Abandoned water well	
<input type="checkbox"/> 5 Cess pool	<input type="checkbox"/> 10 Livestock pens	<input type="checkbox"/> 15 Oil well/Gas well	

Direction from well? ..... How many feet? .....

FROM	TO	PLUGGING MATERIALS
<u>153</u>	<u>25</u>	<u>chlorinated gravel</u>
<u>25</u>	<u>4' BGL</u>	<u>cement</u>
<u>4</u>	<u>0</u>	<u>Top Soil</u>

7 CONTRACTOR'S OF LANDOWNER'S CERTIFICATION: This water well was plugged under my jurisdiction and was completed on (mo/day/year) 8-11-2011 and this record is true to the best of my knowledge and belief. Kansas Water Well Contractor's License No. 102 This Water Well Record was completed on (mo/day/year) 8-12-2011 under the business name of Caylak Christenson Co. by (signature) [Signature]

INSTRUCTIONS: Use typewriter or ball point pen. Please press firmly and print clearly. Please fill in blanks, underline or circle the correct answers. Send top three copies to Kansas Department of Health and Environment, Bureau of Water, Geology Section, 1000 SW Jackson St., Ste. 420, Topeka, Kansas 66612-1367. Telephone: 785/296-5522. Send one to Water Well Owner and retain one for your records.

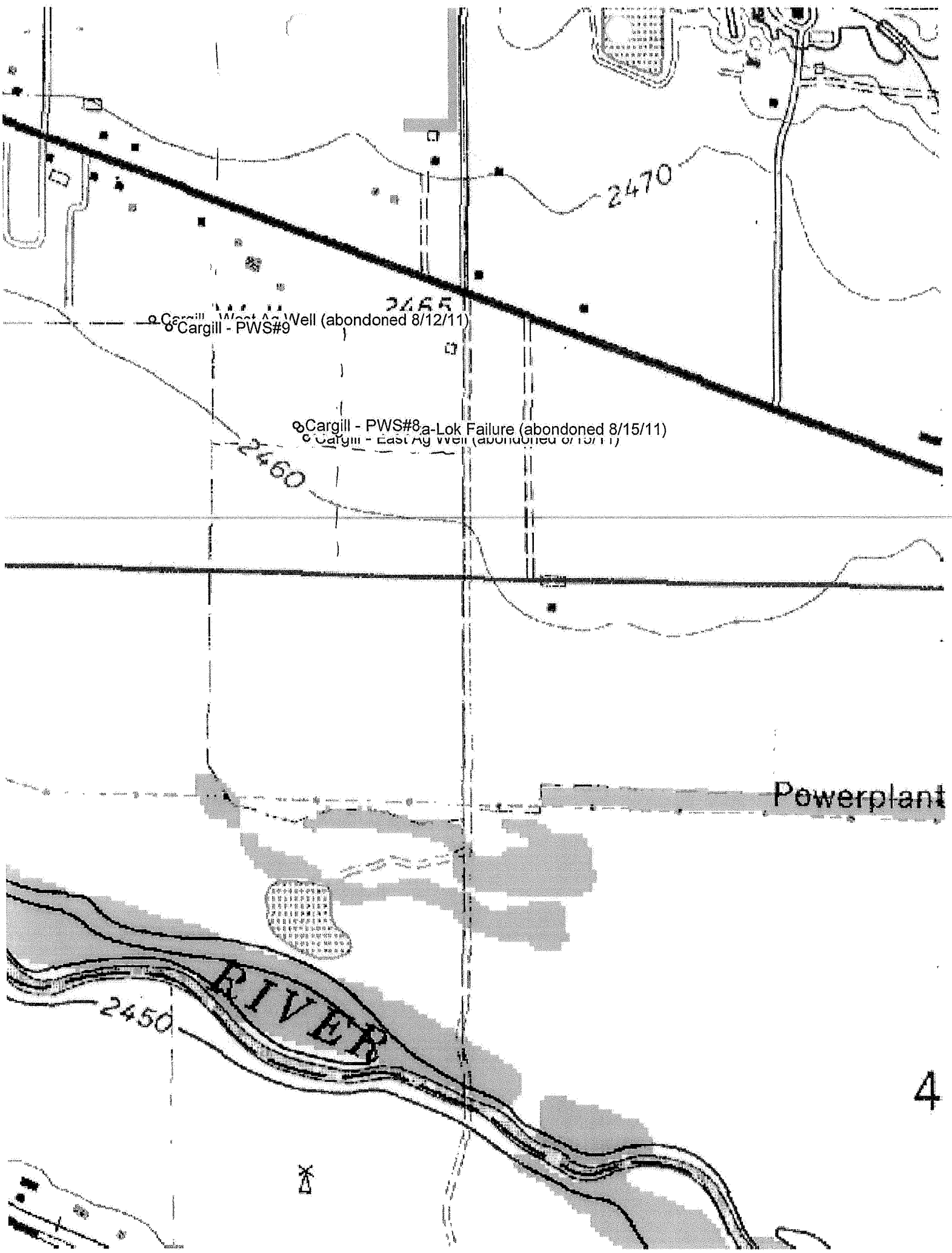

○ Cargill - West A Well (abandoned 8/12/11)  
○ Cargill - PWS#9

○ Cargill - PWS#8 a-Lok Failure (abandoned 8/15/11)  
○ Cargill - East A Well (abandoned 8/15/11)

Powerplant

RIVER

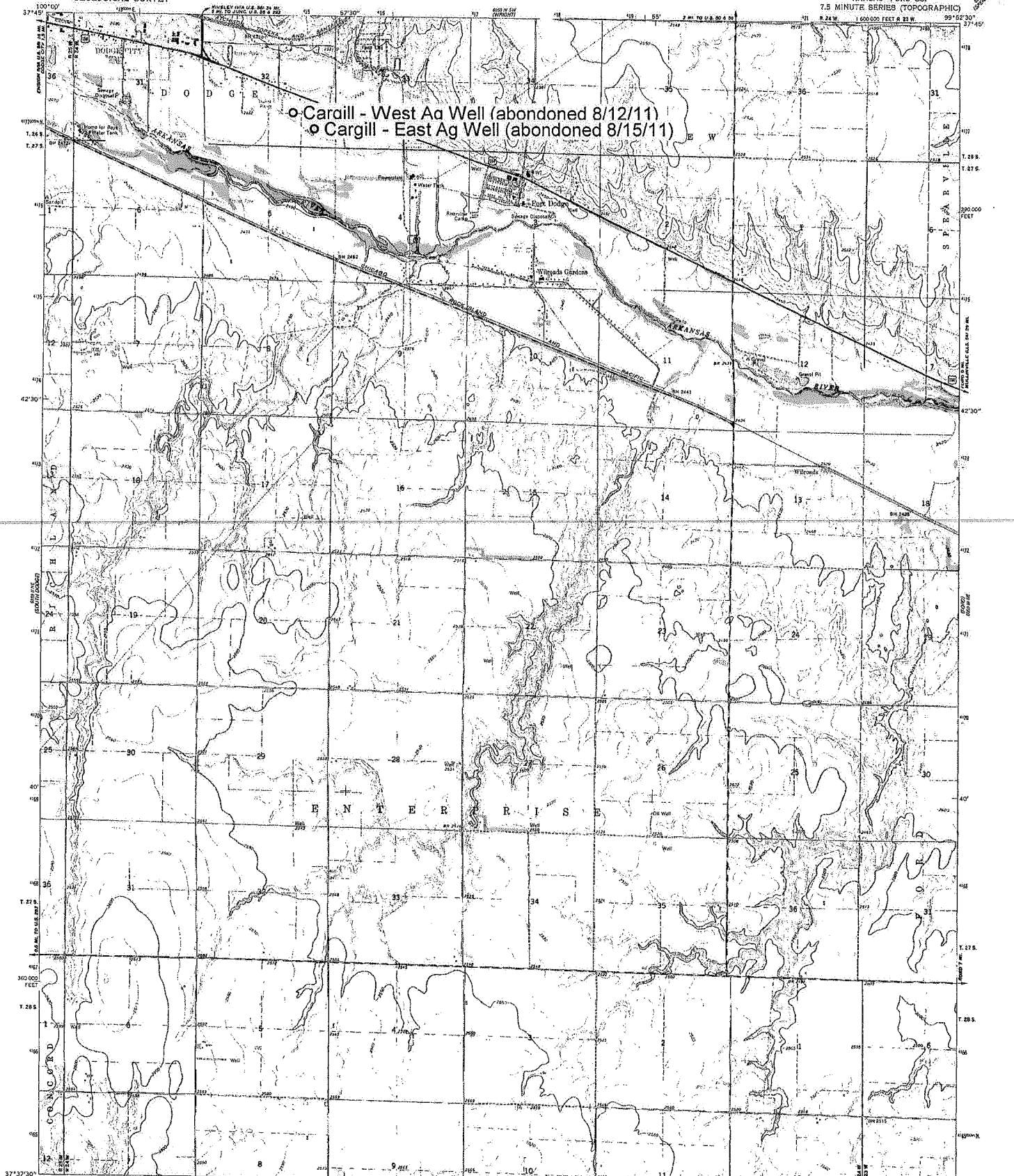

○ Carraill - West Ag Well (abandoned 8/12/11)  
○ Cargill - East Ag Well (abandoned 8/15/11)

Maped, edited, and published by the Geological Survey  
Control by USGS and USCGS  
Topography by photogrammetric methods from aerial  
photographs taken 1965. Field checked 1969.  
Polyconic projection, 1927 North American datum  
10,000-foot grid based on Kansas coordinate system, south zone  
1000 meter Universal Transverse Mercator grid ticks,  
zone 14, shown in blue.  
Fine red dashed lines indicate selected fence and field lines where  
generally visible on aerial photographs. This information is unclassified.  
Roads are shown in black. A color reference strip is available upon request.  
1977. Map without 1977. This data was not used in 1977.

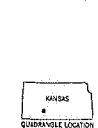
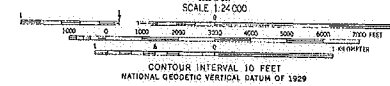
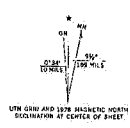

ROAD CLASSIFICATION  
Primary highway, all weather, hard surface  
Secondary highway, all weather, fair or dry hard surface  
Light duty road, all weather, improved surface  
Unimproved road, fair or dry weather  
U. S. Route

THIS MAP COMPLIES WITH NATIONAL MAP ACCURACY STANDARDS  
FOR SALE BY U. S. GEOLOGICAL SURVEY, DENVER, COLORADO 80225, OR RESTON, VIRGINIA 22092  
AND STATE GEOLOGICAL SURVEY, LAWRENCE, KANSAS 66044  
A FORTY-FIVE PERCENT DISCOUNT ON MAPS AND SYMBOLS IS AVAILABLE ON REQUEST

FORT DODGE, KANS.  
N3737.5—W9902.5/7.5

1969  
PUBLISHED BY THE GEOLOGICAL SURVEY  
AMS 6039 III NW—GEODESIC VERT