

PHS #9

WATER WELL RECORD

Form WWC-5

Division of Water Resources; App. No.

1 LOCATION OF WATER WELL: County: Ford Fraction: NE 1/4 SW 1/4 SE 1/4 Section Number: 32 Township Number: T 26 S Range Number: R 24 E

Distance and direction from nearest town or city street address of well if located within city? of Hwy 400 & 114 Rd 60 S. 12 mi/1/4 From intersection west .16 mi/1/4

Global Positioning Systems (decimal degrees, min. of 4 digits) Latitude: N 37° 44.3640 Longitude: W 99° 57.9370 Elevation: Datum: Data Collection Method:

2 WATER WELL OWNER: Cargill RR#: 3201 E. Trail P.O. Box 1060 City, State, ZIP Code: Dodge City KS 67801

3 LOCATE WELL'S LOCATION WITH AN "X" IN SECTION BOX:

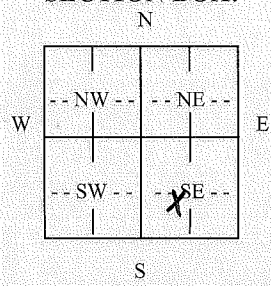

4 DEPTH OF COMPLETED WELL: 160 ft. Depth(s) Groundwater Encountered (1)..... ft. (2)..... ft. (3)..... ft. WELL'S STATIC WATER LEVEL..... 56.42 ft. below land surface measured on mo/day/yr. 8/11/2011 Pump test data: Well water was..... 74.6.....ft. after..... 8..... hours pumping..... 650..... gpm Est. Yield..... 500.....gpm: Well water was.....ft. after..... hours pumping..... gpm WELL WATER TO BE USED AS (C) Public water supply 8 Air conditioning 11 Injection well 1 Domestic 3 Feedlot 6 Oil field water supply 9 Dewatering 12 Other (Specify below) 2 Irrigation 4 Industrial 7 Domestic (lawn & garden) 10 Monitoring well Was a chemical/bacteriological sample submitted to Department? Yes (No); If yes, mo/day/yr Sample was submitted..... Water well disinfected? (Yes) No

5 TYPE OF CASING USED: 1 Steel 3 RMP (SR) 6 Asbestos-Cement 9 Other (specify below) CASING JOINTS: Glued..... Clamped..... 2 PVC 4 ABS 7 Fiberglass Welded..... Threaded.....

Blank casing diameter 17.4..... in. to 12.9..... ft., Diameter. 4.2..... in. to 20..... ft., Diameter in. to ft. Casing height above land surface..... in., Weight.....lbs./ft. Wall thickness or guage No. SR 17

TYPE OF SCREEN OR PERFORATION MATERIAL: 1 Steel (C) Stainless Steel 5 Fiberglass 7 PVC 9 ABS 11 Other (Specify) 2 Brass 4 Galvanized Steel 6 Concrete tile 8 RM (SR) 10 Asbestos-Cement 12 None used (open hole)

SCREEN OR PERFORATION OPENINGS ARE: 1 Continuous slot 3 Mill slot 5 Gauzed wrapped 7 Torch cut 9 Drilled holes 11 None (open hole) 2 Louvered shutter 4 Key punched (C) Wire wrapped 8 Saw Cut 10 Other (specify)

SCREEN-PERFORATED INTERVALS: From.... 12.9..... ft. to 15.9..... ft., From ft. to ft. From..... ft. to ft., From ft. to ft.

GRAVEL PACK INTERVALS: From.... 16.0..... ft. to 25..... ft., From ft. to ft. From..... ft. to ft., From ft. to ft.

6 GROUT MATERIAL: 1 Neat cement (C) Cement grout (C) Bentonite 4 Other Grout Intervals: From 0..... ft. to 20..... ft., From 20..... ft. to 25..... ft., From ft. to ft.

What is the nearest source of possible contamination: 1 Septic tank 4 Lateral lines 7 Pit privy 10 Livestock pens 13 Insecticide Storage (C) Other (specify below) 2 Sewer lines 5 Cess pool 8 Sewage lagoon 11 Fuel storage 14 Abandoned water well None known 3 Watertight sewer lines 6 Seepage pit 9 Feedyard 12 Fertilizer Storage 15 Oil well/gas well None known Direction from well? How many feet?

Table with columns: FROM, TO, LITHOLOGIC LOG, FROM, TO, PLUGGING INTERVALS. Content: See Attached

7 CONTRACTOR'S OR LANDOWNER'S CERTIFICATION: This water well was (1) constructed, (2) reconstructed, or (3) plugged under my jurisdiction and was completed on (mo/day/year) 10/25/11... and this record is true to the best of my knowledge and belief. Kansas Water Well Contractor's License No. 102..... This Water Well Record was completed on (mo/day/year) 10/26/11... under the business name of Lann Christensen Co. by (signature)

INSTRUCTIONS: Use typewriter or ball point pen. PLEASE PRESS FIRMLY and PRINT clearly. Please fill in blanks, underline or circle the correct answers. Send top three copies to Kansas Department of Health and Environment, Bureau of Water, Geology Section, 1000 SW Jackson St., Suite 420, Topeka, Kansas 66612-1367. Telephone 785-296-5522. Send one to WATER WELL OWNER and retain one for your records. Fee of \$5.00 for each constructed well. Visit us at http://www.kdhe.state.ks.us/geo/waterwells.

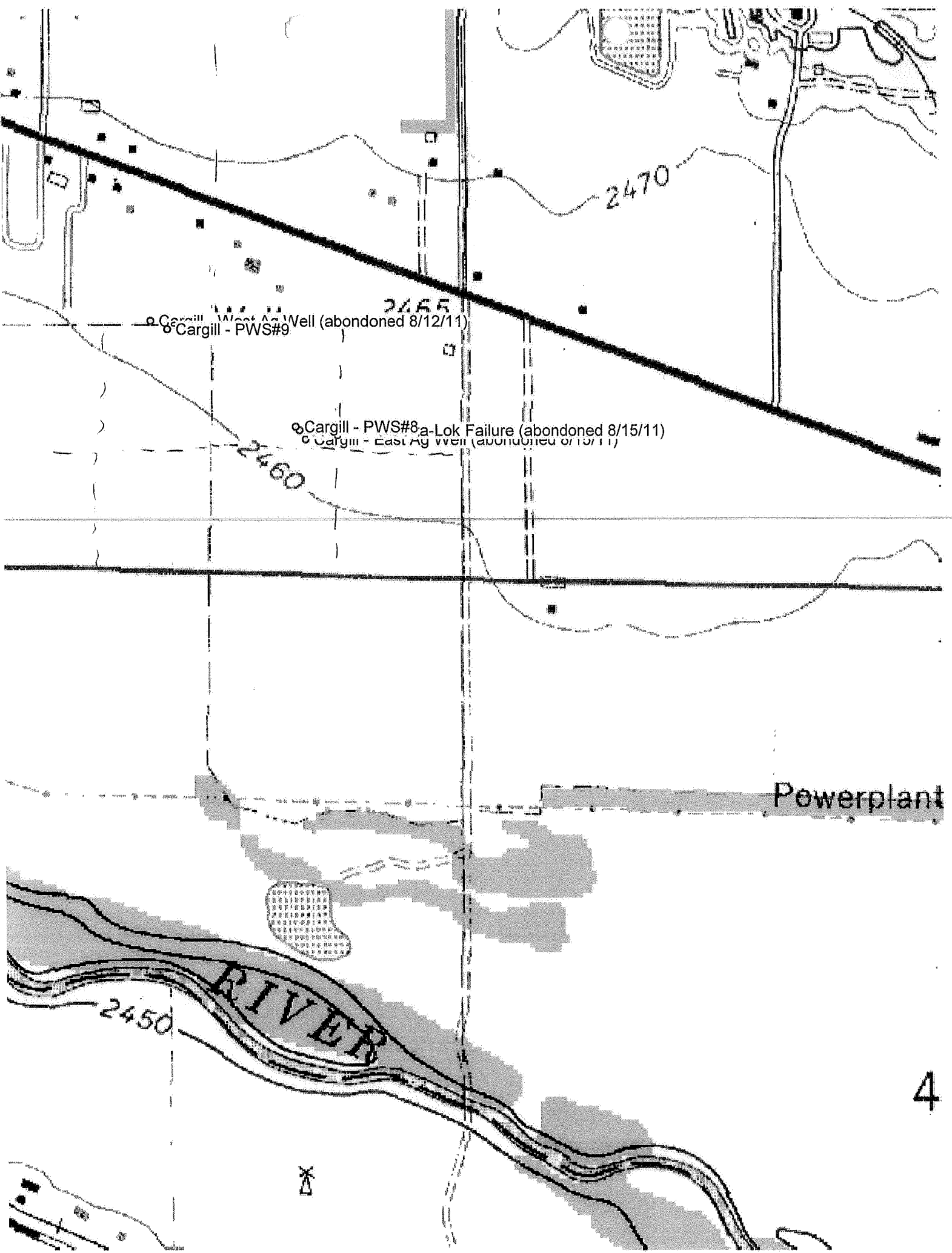

○ Cargill - West Ag Well (abandoned 8/12/11)
○ Cargill - PWS#9

○ Cargill - PWS#8
○ Cargill - East Ag Well (abandoned 8/15/11)

Powerplant

2450 RIVER

2470

2460

2455

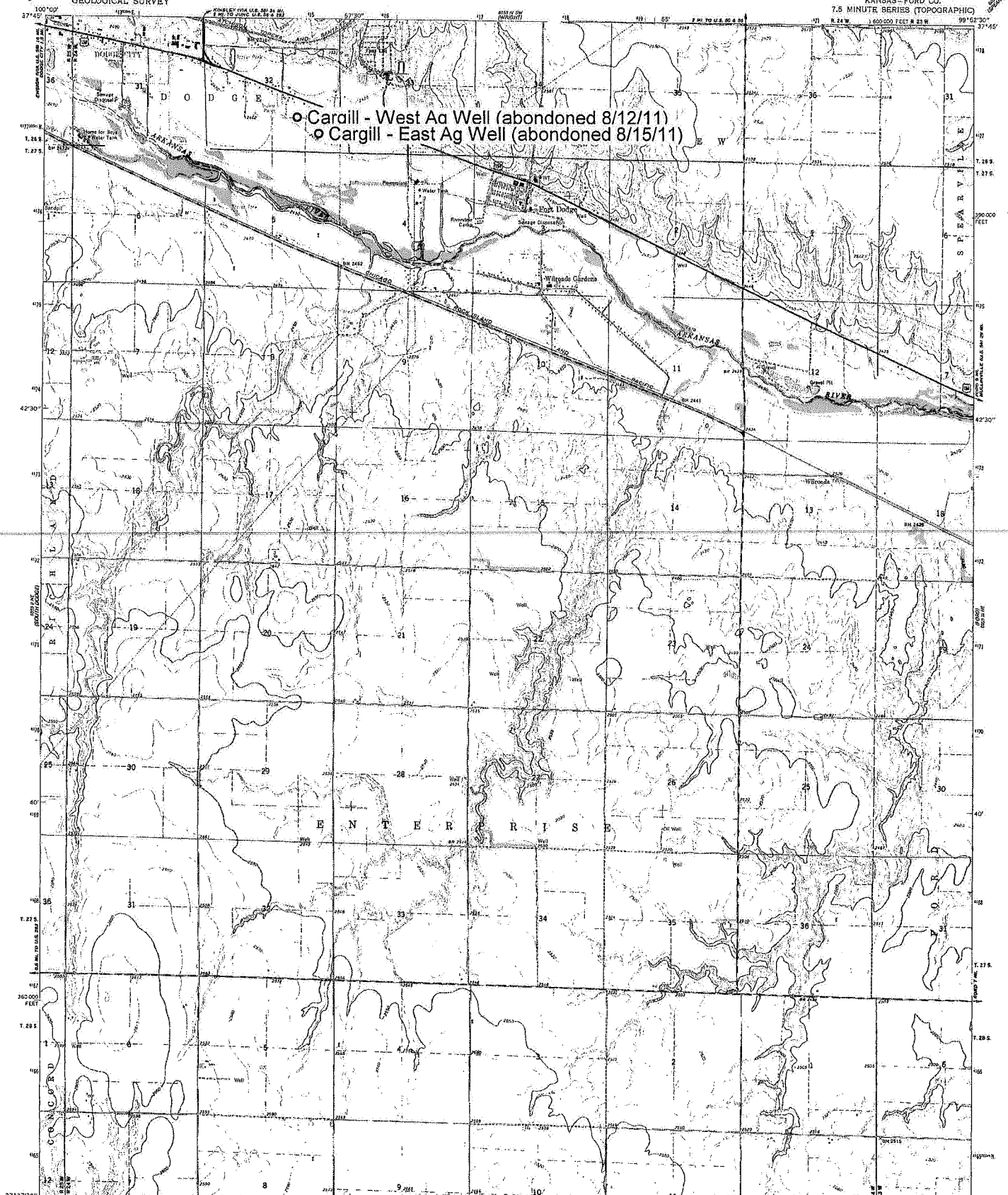

○ Carraill - West Ag Well (abandoned 8/12/11)
○ Cargill - East Ag Well (abandoned 8/15/11)

Maped, edited, and published by the Geological Survey
Control by USGS and USGS/OS

Topography by photogrammetric methods from aerial
photographs taken 1965 Field checked 1969

Polynomial projection, 1927 North American datum
10,000-foot grid based on Kansas spheroidal system, south zone
1000-meter Universal Transverse Mercator grid lines,
zone 14, shown in blue

Fine red dashed lines indicate selected fence and field lines where
generally visible on aerial photographs. This information is unchecked
Revisions to this map are shown in the following sequence:
1977 Map sheet 1976 The information for this sheet

UNIT GRID AND 1976 DATUM NORTH
DECLINATION AT CENTER OF SHEET

SCALE 1:24,000

CONTOUR INTERVAL 10 FEET
NATIONAL GEODETIC VERTICAL DATUM OF 1929

ROAD CLASSIFICATION
Primary highway, all weather Light-duty road, all weather,
hard surface Improved road, unimproved surface
Secondary highway, all weather Unimproved road, fair or dry
weather hard surface

U. S. Route

THIS MAP COMPLIES WITH NATIONAL MAP ACCURACY STANDARDS
FOR SALE BY U.S. GEOLOGICAL SURVEY, DENVER, COLORADO 80225, OR RESTON, VIRGINIA 22092
AND STATE GEOLOGICAL SURVEY, LAWRENCE, KANSAS 66044
A FOLDER DESCRIBING TOPOGRAPHIC MAPS AND SYMBOLS IS AVAILABLE ON REQUEST

FORT DODGE, KANS.
1969
PHOTOGRAPHIC 1965
AND 6653 IN NW-CORNER Vars