

**1 LOCATION OF WATER WELL:** Fraction SE 1/4 NE 1/4 NW 1/4 NE 1/4 Section Number 31 Township Number 26T S Range Number 24  E  W  
 County: Ford

Street/Rural Address of Well Location; if unknown, distance & direction from nearest town or intersection: If at owner's address, check here

**Global Positioning Systems (GPS) information:**  
 Latitude: 37.749223 (in decimal degrees)  
 Longitude: 99.993625 (in decimal degrees)  
 Elevation: 2496  
 Datum:  WGS84,  NAD83,  NAD27  
**Collection Method:**  
 GPS unit (Make/Model: \_\_\_\_\_)  
 Digital Map/Photo,  Topographic Map,  Land Survey  
 Est. Accuracy:  <3 m,  3-5 m,  5-15 m,  >15 m

**2 WATER WELL OWNER:** National Beef  
 RR#, St. Address, Box #: PO Box 539  
 City, State ZIP Code: Delage City KS 66780

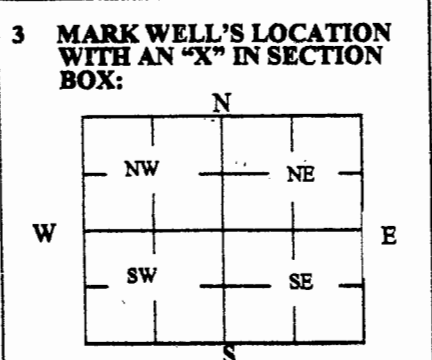

**4 DEPTH OF WELL** 135 ft.  
**WELL'S STATIC WATER LEVEL** 78 ft.  
**WELL WAS USED AS:**  
 Domestic  Public Water Supply  Dewatering  
 Irrigation  Oil Field Water Supply  Monitoring  
 Feedlot  Domestic (Lawn & Garden)  Injection Well  
 Industrial  Air Conditioning  Other \_\_\_\_\_  
 Was a chemical/bacteriological sample submitted to Department? Yes  No

**5 TYPE OF BLANK CASING USED:**  
 Steel  RMP (SR)  Wrought  Fiberglass  Other (Specify below)  
 PVC  ABS  Asbestos-Cement  Concrete Tile  
 Blank casing diameter 2 in. Was casing pulled? Yes  No  If yes, how much \_\_\_\_\_  
 Casing height above or below land surface 34 in.

**6 GROUT PLUG MATERIAL:**  Neat cement  Cement grout  Bentonite  Other \_\_\_\_\_  
 Grout Plug Intervals: From 0 ft. to 15 ft., From 13 ft. to 78 ft., From \_\_\_\_\_ ft. to \_\_\_\_\_ ft.  
 What is the nearest source of possible contamination:  
 Septic tank  Seepage pit  Fuel storage  Other (specify below)  
 Sewer lines  Pit privy  Fertilizer storage  
 Watertight sewer lines  Sewage lagoon  Insecticide storage  
 Lateral lines  Feedyard  Abandoned water well Direction from well? NORTH EAST  
 Cess pool  Livestock pens  Oil well/Gas well How many feet? 200

FROM	TO	PLUGGING MATERIALS	FROM	TO	PLUGGING MATERIALS
0	15	BENTONITE GROUT			
15	43	CLEAN FILL SAND			
43	78	BENTONITE GROUT			
78	135	CLEAN FILL SAND			

**7 CONTRACTOR'S OR LANDOWNER'S CERTIFICATION:** This water well was plugged under my jurisdiction and was completed on (mo/day/year) 11/30/2017 and this record is true to the best of my knowledge and belief. Kansas Water Well Contractor's License No. 3416 This Water Well Record was completed on (mo/day/year) 12/13/17 under the business name of NASH WATERWELL SERVICE, LLC by (signature) [Signature]

**INSTRUCTIONS:** Use typewriter or ballpoint pen. Please press firmly and print clearly. Please fill in blanks, underline or circle the correct answers. Send top three copies to Kansas Department of Health and Environment, Bureau of Water, Geology Section, 1000 SW Jackson St., Ste. 420, Topeka, Kansas 66612-1367. Telephone: 785/296-5524. Send one to Water Well Owner and retain one for your records. Visit us at <http://www.kdheks.gov/waterwell/index.html>.