

Send one copy to WATER WELL OWNER and retain one for your records. Fee of \$5.00 for each constructed well.  
KS Department of Health and Environment, Bureau of Water, Geology Section, 1000 SW Jackson St., Suite 420, Topeka, Kansas 66612-1367. Telephone 785-296-3565.  
Visit us at <http://www.kdheks.gov/waterwell/index.html> KSA 82a-1212

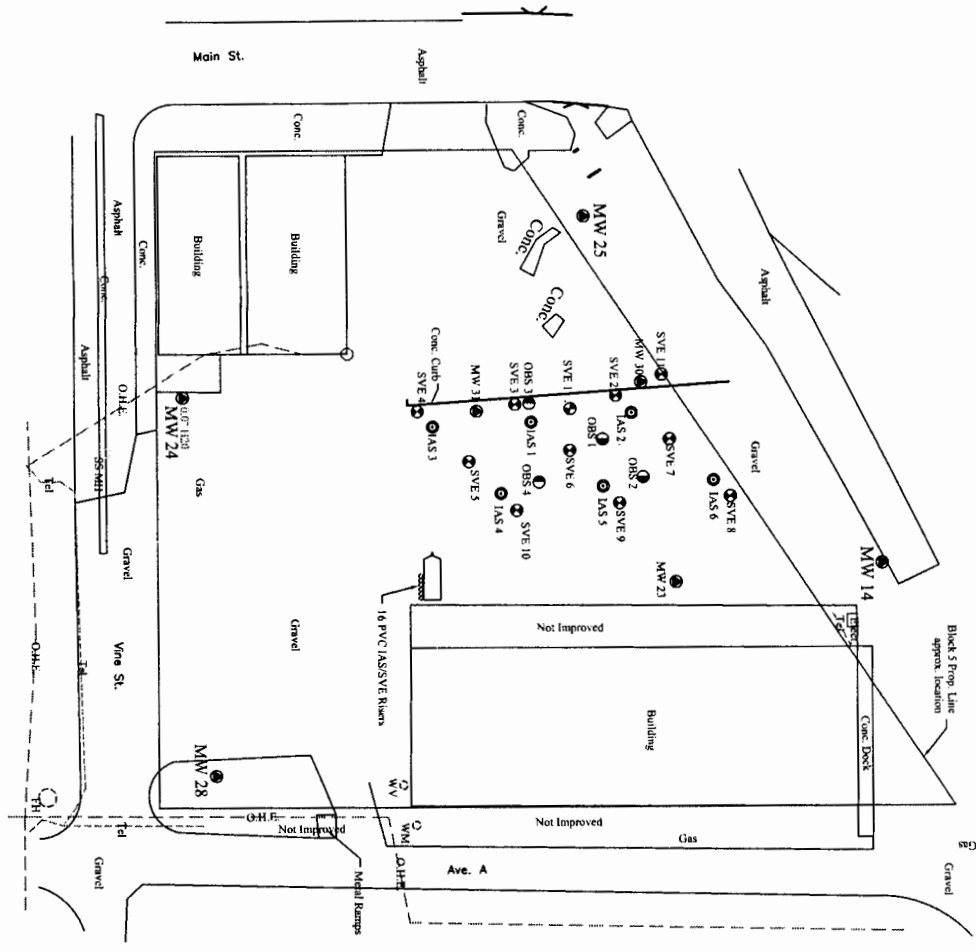

**Fig 1B - Remediation Site Base Map**  
**Right Coop**  
**Wright, Kansas**

Drawn By: <b>SGE II</b>	Date:
Reviewed By: <b>Sidney Edelbrock II, P.E.</b>	KDIIE Code: <b>A1-029-40375</b>
Scale: <b>1 inch = 60 Feet</b>	File: <b>Site Base Map.dwg</b>

**Legend**

- - Right Coop Monitoring Well
- - EPA Monitoring Well
- - Soil Vent Well
- - IAS Well
- - Observation Well 4-inch Shallow
- - Observation Well 2-inch Deep
- - Nested IAS / SVE Well
- Gas - Gas Line
- OH.E. - Overhead Electric Line
- V - Water Line
- SS - Sanitary Sewer Line
- Tel - Telephone Line
- Property Line

B: 1390 - Concentration in ppb

B: ND - Non-Detect

○ - Isoconcentration Line

B: NS - Not Sampled

▨ - Approximate Location of Former  
AST Bulk Storage Area

Scale In Feet  
 0 60 120