

Correction

WATER WELL RECORD Form WWC-5

Division of Water Resources App. No.

[]

SVE-8

[x] Original Record [] Correction [] Change in Well Use

Well ID

1 LOCATION OF WATER WELL: County: Ford Fraction NW 1/4 NW 1/4 SE 1/4 SE 1/4 Section Number 13 Township Number T 26 S Range Number R 24 [] E [x] W

2 WELL OWNER: Last Name: Business: Right Coop Address: PO Box 38 City: Wright State: KS ZIP: 67882 Street or Rural Address where well is located

3 LOCATE WELL WITH 'X' IN SECTION BOX: [Diagram] 4 DEPTH OF COMPLETED WELL: 100 ft. 5 Latitude: 37.78171 Longitude: 99.89140

7 WELL WATER TO BE USED AS: 1. Domestic 2. Irrigation 3. Feedlot 4. Industrial 5. Public Water Supply 6. Dewatering 7. Aquifer Recharge 8. Monitoring 9. Environmental Remediation 10. Oil Field Water Supply 11. Test Hole 12. Geothermal 13. Other

Was a chemical/bacteriological sample submitted to KDHE? [] Yes [x] No Water well disinfected? [] Yes [x] No

8 TYPE OF CASING USED: [] Steel [x] PVC [] Other CASING JOINTS: [x] Glued [] Clamped [] Welded [] Threaded Casing diameter 4 in. to 50 ft. Casing height above land surface 0 in. Weight 2.071 lbs./ft. Wall thickness or gauge No. 237

9 GROUT MATERIAL: [] Neat cement [x] Cement grout [x] Bentonite [] Other Grout intervals: From 0 ft. to 2 ft. From 2 ft. to 45 ft. From 45 ft. to 100 ft. From 100 ft. to 45 ft.

Nearest source of possible contamination: [] Septic Tank [] Lateral Lines [] Pit Privy [] Livestock Pens [] Insecticide Storage [] Sewer Lines [] Cess Pool [] Sewage Lagoon [] Fuel Storage [] Abandoned Water Well [] Watertight Sewer Lines [] Seepage Pit [] Feedyard [] Fertilizer Storage [] Oil Well/Gas Well

Table with 6 columns: 10 FROM, TO, LITHOLOGIC LOG, FROM, TO, LITHO. LOG (cont.) or PLUGGING INTERVALS. Rows show depth intervals from 0 to 100 ft with lithology descriptions like 'surface', 'clay & caliche w/sandy clay strks', etc.

11 CONTRACTOR'S OR LANDOWNER'S CERTIFICATION: This water well was [x] constructed, [] reconstructed, or [] plugged under my jurisdiction and was completed on (mo-day-year) 10/31/2013

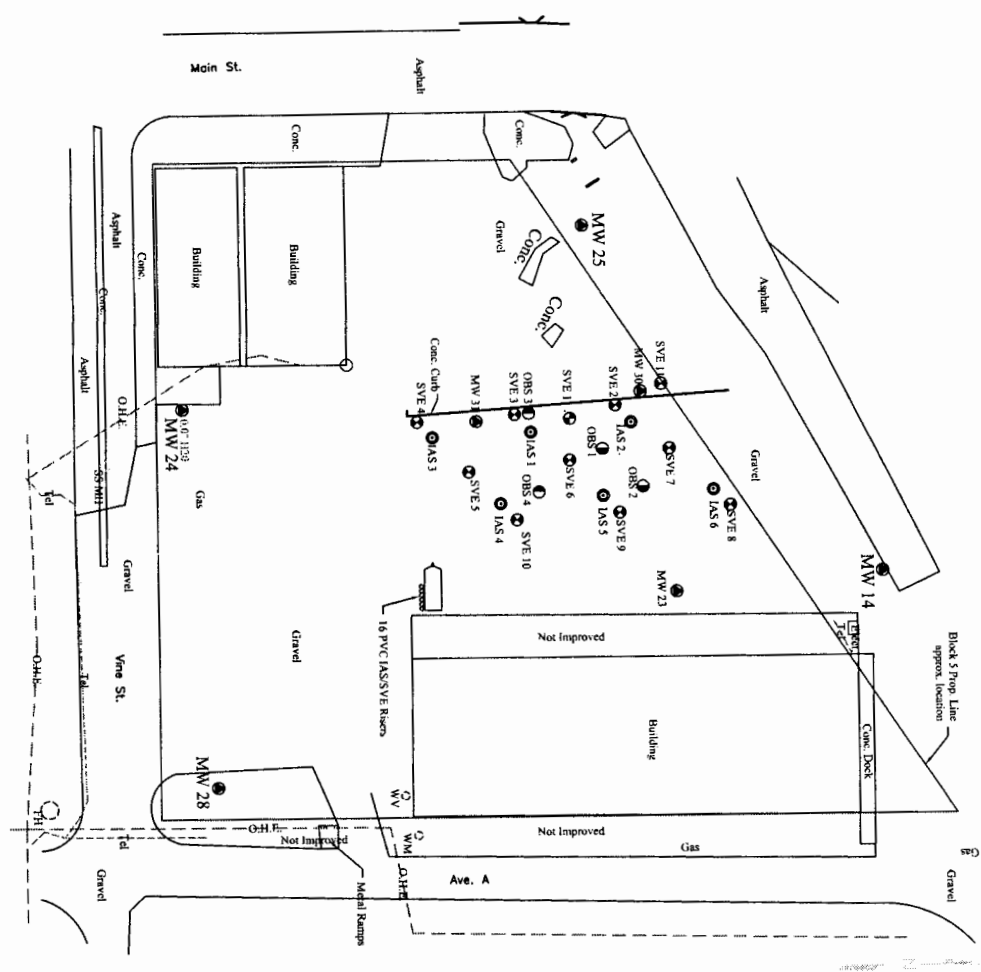

Fig 1B - Remediation Site Base Map

Right Coop Wright, Kansas

Drawn By: SGE II	Date:
Reviewed By: Sidney Edelbrock II, P.E.	KDHE Code: A1-029-40375
Scale: 1 inch = 60 Feet	File: Site Base Map.dwg

Legend

- - Right Coop Monitoring Well
- - EPA Monitoring Well
- - Soil Vent Well
- - IAS Well
- - Observation Well 4-Inch Shallow
- - Observation Well 2-Inch Deep
- - Nested IAS / SVE Well
- Gas - Gas Line
- O.H.E. - Overhead Electric Line
- W - Water Line
- SS - Sanitary Sewer Line
- Tel. - Telephone Line
- - Property Line

- B: 1390 - Concentration in ppb
- B: ND - Non-Detect
- - Isoconcentration Line
- B: NS - Not Sampled
- ▨ - Approximate Location of Former AST Bulk Storage Area

Scale In Feet

0 60 120