

WATER WELL RECORD

Form WWC-5

Division of Water Resources App. No.

1 LOCATION OF WATER WELL: County: FORD Fraction 1/4 NW 1/4 NE 1/4 SE 1/4 Section Number 30 Township No. T 26 S Range Number R 26 [] E [X] W

Street/Rural Address of Well Location; if unknown, distance & direction from nearest town or intersection: HOWELL-1 MILE SOUTH, 1 MILE WEST, 1 MILE SOUTH, 2,334 FT. NORTH & 691 FT. WEST Global Positioning System (GPS) information: Latitude: Longitude: Elevation: Datum: [] WGS 84, [] NAD 83, [] NAD 27

2 WATER WELL OWNER: GOETZ FARMS, INC. RR#, Street Address, Box #: 10950 101 ROAD City, State, ZIP Code : DODGE CITY, KANSAS 67801 Collection Method: [] GPS unit (Make/Model: [] Digital Map/Photo, [] Topographic Map, [] Land Survey Est. Accuracy: [] <3 m, [] 3-5 m, [] 5-15 m, [] >15 m

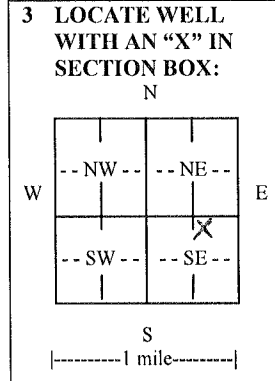

3 LOCATE WELL WITH AN 'X' IN SECTION BOX: N W E S 4 DEPTH OF COMPLETED WELL 224 ft. Depth(s) Groundwater Encountered (1) 105 ft. (2) ft. (3) ft. WELL'S STATIC WATER LEVEL 105 ft. below land surface measured on mo/day/yr. 7-3-14. Pump test data: Well water was ft. after hours pumping gpm EST. YIELD gpm. Well water was ft. after hours pumping gpm Bore Hole Diameter 30 in. to 224 ft., and in. to ft. WELL WATER TO BE USED AS: [] Public water supply [] Geothermal [] Injection well [] Domestic [] Feedlot [] Oil field water supply [] Dewatering [] Other (Specify below) [X] Irrigation [] Industrial [] Domestic-lawn & garden [] Monitoring well Was a chemical/bacteriological sample submitted to Department? [] Yes [X] No If yes, mo/day/yr sample was submitted. Water well disinfected? [] Yes [X] No

5 TYPE OF CASING USED: [X] Steel [] PVC [] Other CASING JOINTS: [] Glued [] Clamped [X] Welded [] Threaded Casing diameter 16 in. to 144 ft., Diameter 42.05 in. to ft., Diameter in. to ft. Casing height above land surface 12 in., Weight lbs./ft., Wall thickness or gauge No. 250 TYPE OF SCREEN OR PERFORATION MATERIAL: [X] Steel [] Stainless Steel [] PVC [] Brass [] Galvanized Steel [] None used (open hole) [] Other (Specify) SCREEN OR PERFORATION OPENINGS ARE: [] Continuous slot [] Mill slot [] Gauze wrapped [] Torch cut [] Drilled holes [] None (open hole) [] Louvered shutter [] Key punched [X] Wire wrapped [] Saw cut [] Other (specify) SCREEN-PERFORATED INTERVALS: From 144 ft. to 224 ft., From ft. to ft. From ft. to ft., From ft. to ft. GRAVEL PACK INTERVALS: From 35 ft. to 70 ft., From 130 ft. to 224 ft. From ft. to ft., From ft. to ft.

6 GROUT MATERIAL: [] Neat cement [X] Cement grout [] Bentonite [] Other Grout Intervals: From 0 ft. to 35 ft., From ft. to ft., From ft. to ft., From ft. to ft. What is the nearest source of possible contamination: [] Septic tank [] Lateral lines [] Pit privy [] Livestock pens [] Insecticide storage [] Other (specify below) [] Sewer lines [] Cesspool [] Sewage lagoon [] Fuel storage [] Abandoned water well [] Watertight sewer lines [] Seepage pit [] Feedyard [] Fertilizer storage [] Oil well/gas well N/A Direction from well Distance from well

Table with columns: FROM, TO, LITHOLOGIC LOG, FROM, TO, LITHO. LOG (cont.) or PLUGGING INTERVALS. Content: SEE ATTACHED LOG

7 CONTRACTOR'S OR LANDOWNER'S CERTIFICATION: This water well was [X] constructed, [] reconstructed, or [] plugged under my jurisdiction and was completed on (mo/day/year) 7-3-14 and this record is true to the best of my knowledge and belief. Kansas Water Well Contractor's License No. 208 This Water Well Record was completed on (mo/day/year) 7-7-14 under the business name of MINTER-WILSON DRILLING CO., INC. by (signature) Nora Keller

INSTRUCTIONS: Use typewriter or ball point pen. PLEASE PRESS FIRMLY and PRINT clearly. Please fill in blanks and check the correct answers. Send one copy to Kansas Department of Health and Environment, Bureau of Water, Geology Section, 1000 SW Jackson St., Suite 420, Topeka, Kansas 66612-1367. Telephone 785-296-5524. Send one copy to WATER WELL OWNER and retain one for your records. Include fee of \$5.00 for each constructed well. Visit us at

*The
Professionals*

MINTER-WILSON DRILLING CO.

INCORPORATED

Irrigation
and Domestic
Water Systems
Complete Installation
and Repairing

Phone 620-276-8269 • P.O. Box A • GARDEN CITY, KANSAS 67846

NAME GOETZ FARMS - CIRCLE # 15
COUNTY FORD
DATE 5-2-14

LOCATION: SE 1/4 30-26-26 - CIMARRON - 3 MILES SOUTH TO R ROAD, 6 MILES EAST,
2 MILES NORTH, 2 MILES EAST, 1-1/4 MILE SOUTH
- 1/4 MILE SOUTHWEST AROUND CIRCLE
- NORTHEAST EDGE OF CIRCLE

STATIC WATER LEVEL -

TEST # 2

0' TO 2' - TOP SOIL
2' TO 9' - BROWN SANDY CLAY & BROWN CLAY
9' TO 35' - FINE TO MEDIUM SAND & GRAVEL
35' TO 50' - BROWN CLAY
50' TO 75' - FINE TO MEDIUM SAND
75' TO 110' - BROWN CLAY - TRACES OF WHITE ROCK
110' TO 140' - BROWN CLAY
140' TO 150' - FINE TO MEDIUM SAND
150' TO 188' - BROWN CLAY
188' TO 224' - FINE TO MEDIUM SAND & GRAVEL
224' TO 232' - BROWN YELLOW CLAY WITH BROWN ROCK MIXED
232' TO 245' - SHALE - HARD