

1 LOCATION OF WATER WELL:	Fraction	Section Number	Township Number	Range Number
County: Gray	NE 1/4 NW 1/4 SE 1/4	11	T 26 S	R 28 EW

Distance and direction from nearest town or city street address of well if located within city?

Block 61

#5

2 WATER WELL OWNER: City of Cimarron	Board of Agriculture, Division of Water Resources
RR#, St. Address, Box # :	Application Number: SW#3 (30 of 168)
City, State, ZIP Code : Cimarron, Ks. 67835	

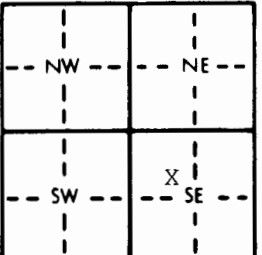
3 LOCATE WELL'S LOCATION WITH AN "X" IN SECTION BOX:	4 DEPTH OF COMPLETED WELL 135' ft. ELEVATION:
	Depth(s) Groundwater Encountered 1. ft. 2. ft. 3. ft.
	WELL'S STATIC WATER LEVEL 17' ft. below land surface measured on mo/day/yr
	Pump test data: Well water was ft. after hours pumping gpm
	Est. Yield gpm: Well water was ft. after hours pumping gpm
	Bore Hole Diameter in. to ft., and in. to ft.
	WELL WATER TO BE USED AS:
	1 Domestic 3 Feedlot 6 Oil field water supply 9 Dewatering 12 Other (Specify below)
	2 Irrigation 4 Industrial 7 Lawn and garden only 10 Observation well
	Was a chemical/bacteriological sample submitted to Department? Yes.....No.....; If yes, mo/day/yr sample was submitted
	Water Well Disinfected? Yes No

5 TYPE OF BLANK CASING USED:	5 Wrought iron	8 Concrete tile	CASING JOINTS: Glued Clamped
1 Steel	3 RMP (SR)	6 Asbestos-Cement	9 Other (specify below)
2 PVC	4 ABS	7 Fiberglass	10 Asbestos-cement
Blank casing diameter 6 in. to ft., Dia in. to ft., Dia in. to ft.			11 Other (specify)
Casing height above land surface in., weight lbs./ft. Wall thickness or gauge No.			12 None used (open hole)
TYPE OF SCREEN OR PERFORATION MATERIAL:	7 PVC	10 Asbestos-cement	
1 Steel	3 Stainless steel	5 Fiberglass	8 RMP (SR)
2 Brass	4 Galvanized steel	6 Concrete tile	9 ABS
SCREEN OR PERFORATION OPENINGS ARE: N/A	5 Gauzed wrapped	8 Saw cut	11 None (open hole)
1 Continuous slot	3 Mill slot	6 Wire wrapped	9 Drilled holes
2 Louvered shutter	4 Key punched	7 Torch cut	10 Other (specify)
SCREEN-PERFORATED INTERVALS: From N/A ft. to ft., From ft. to ft.			
GRAVEL PACK INTERVALS: From N/A ft. to ft., From ft. to ft.			

6 GROUT MATERIAL:	1 Neat cement	2 Cement grout	3 Bentonite	4 Other .. Chlorinated gravel
Grout Intervals: From 6' Below ground ft. to 13' ft., From 13' ft. to 17' ft., From 17' ft. to 135' ft.				
What is the nearest source of possible contamination:	10 Livestock pens	14 Abandoned water well		
1 Septic tank	4 Lateral lines	7 Pit privy	11 Fuel storage	15 Oil well/Gas well
2 Sewer lines	5 Cess pool	8 Sewage lagoon	12 Fertilizer storage	16 Other (specify below)
3 Watertight sewer lines	6 Seepage pit	9 Feedyard	13 Insecticide storage	17 River Flooding
Direction from well? Possible Sewer lines			How many feet? River 1/4 mile South	

FROM	TO	LITHOLOGIC LOG	FROM	TO	LITHOLOGIC LOG
		#5 of Battery of 5 wells			
0	8"	Cement			
8"	6'	Clay & Sandy Soil			
6'	13'	Neat Cement			
13'	17'	Bentonite			
17'	150'	Chlorinated gravel pack			
		This well is one of a battery of 5 wells. The pit is cement with a cement floor. The bottom of the pit was filled with neat cement to above the casing. The pit was filled with clay & sandy soil. The top end of the pit and man hole was cemented to prevent moisture collecting in the pit.			

7 CONTRACTOR'S OR LANDOWNER'S CERTIFICATION: This water well was (1) constructed, (2) reconstructed, or (3) plugged under my jurisdiction and was completed on (mo/day/year) 5/26/88 and this record is true to the best of my knowledge and belief. Kansas
Water Well Contractor's License No. 145 This Water Well Record was completed on (mo/day/yr) 6/7/88
under the business name of Henkle Drilling & Supply Company, Inc. by (signature) <i>Bruce Reichmuth</i>

INSTRUCTIONS: Use typewriter or ball point pen. PLEASE PRESS FIRMLY and PRINT clearly. Please fill in blanks, underline or circle the correct answers. Send top three copies to Kansas Department of Health and Environment, Bureau of Water Protection, Topeka, Kansas 66620-7320, Telephone: 913-862-9360. Send one to WATER WELL OWNER and retain one for your records.

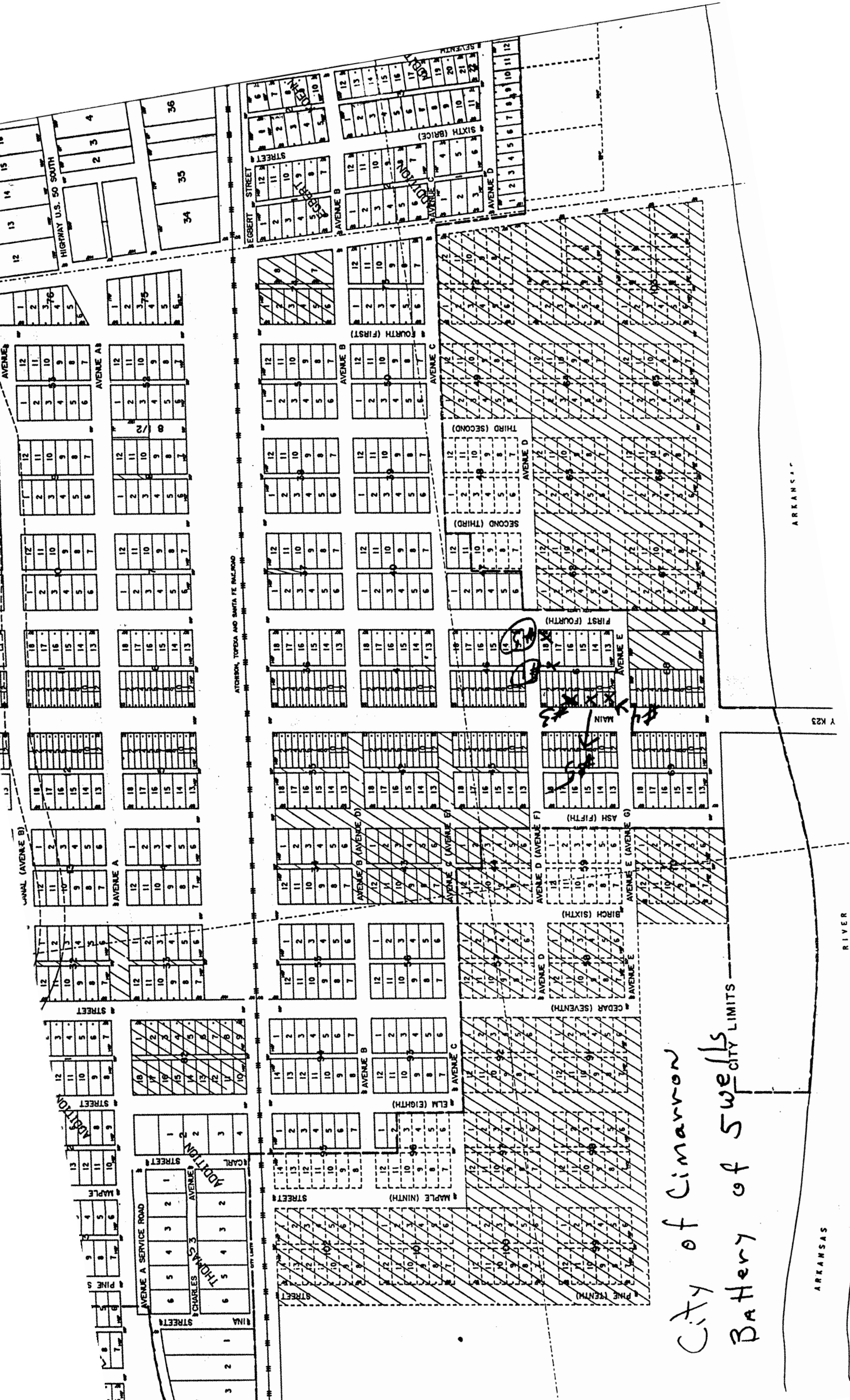

City of Cimarron
Battery of Swells

ARKANSAS

RIVER

Y K23

ARKANSAS