

| | | | | |
|---------------------------|--|----------------|-----------------|--------------|
| 1 LOCATION OF WATER WELL: | Fraction | Section Number | Township Number | Range Number |
| County: <u>-Gray-</u> | NE $\frac{1}{4}$ NW $\frac{1}{4}$ SE $\frac{1}{4}$ | 11 | T 26 S | R 28 EW |

Distance and direction from nearest town or city street address of well if located within city?

Block 61 #1

2 WATER WELL OWNER: City of Cimarron

RR#, St. Address, Box # :

Board of Agriculture, Division of Water Resources

City, State, ZIP Code : Cimarron, Ks. 67835

Application Number: SW#3 (30 of 168)

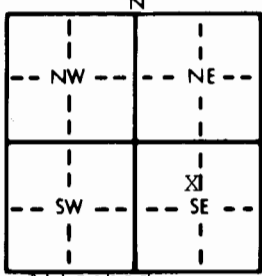
| | |
|---|---|
| 3 LOCATE WELL'S LOCATION WITH AN "X" IN SECTION BOX: | 4 DEPTH OF COMPLETED WELL: 104' ft. ELEVATION: |
|  | Depth(s) Groundwater Encountered 1. ft. 2. ft. 3. ft. |
| Map Attached | WELL'S STATIC WATER LEVEL 17' ft. below land surface measured on mo/day/yr |
| | Pump test data: Well water was ft. after hours pumping gpm |
| | Est. Yield gpm: Well water was ft. after hours pumping gpm |
| | Bore Hole Diameter in. to ft., and in. to ft. |
| | WELL WATER TO BE USED AS: 5 Public water supply 8 Air conditioning 11 Injection well |
| | 1 Domestic 3 Feedlot 6 Oil field water supply 9 Dewatering 12 Other (Specify below) |
| | 2 Irrigation 4 Industrial 7 Lawn and garden only 10 Observation well |
| | Was a chemical/bacteriological sample submitted to Department? Yes No; If yes, mo/day/yr sample was submitted |
| | Water Well Disinfected? Yes No |

| | | | | |
|--|--------------------|--------------------|--|--------------------------|
| 5 TYPE OF BLANK CASING USED: | 5 Wrought iron | 8 Concrete tile | CASING JOINTS: Glued Clamped | |
| 1 Steel | 3 RMP (SR) | 6 Asbestos-Cement | 9 Other (specify below) Welded | |
| 2 PVC | 4 ABS | 7 Fiberglass | Threaded | |
| Blank casing diameter 6" in. to ft., Dia. in. to ft., Dia. in. to ft. | | | | |
| Casing height above land surface in., weight lbs./ft. Wall thickness or gauge No. | | | | |
| TYPE OF SCREEN OR PERFORATION MATERIAL: | 7 PVC | 10 Asbestos-cement | | |
| 1 Steel | 3 Stainless steel | 5 Fiberglass | 8 RMP (SR) | 11 Other (specify) |
| 2 Brass | 4 Galvanized steel | 6 Concrete tile | 9 ABS | 12 None used (open hole) |
| SCREEN OR PERFORATION OPENINGS ARE: N/A | 5 Gauzed wrapped | 8 Saw cut | 11 None (open hole) | |
| 1 Continuous slot | 3 Mill slot | 6 Wire wrapped | 9 Drilled holes | |
| 2 Louvered shutter | 4 Key punched | 7 Torch cut | 10 Other (specify) | |
| SCREEN-PERFORATED INTERVALS: From N/A ft. to ft., From ft. to ft. | | | | |
| GRAVEL PACK INTERVALS: From N/A ft. to ft., From ft. to ft. | | | | |

| | | | | |
|--|-------------------|-------------------------|---|----------------------------|
| 6 GROUT MATERIAL: | 1 Neat cement | 2 Cement grout | 3 Bentonite | 4 Other Chlorinated gravel |
| Grout Intervals: From 6' ft. to 13' ft., From 13' ft. to 17' ft., From 17' ft. to 104' ft. | | | | |
| What is the nearest source of possible contamination: | 10 Livestock pens | 14 Abandoned water well | | |
| 1 Septic tank | 4 Lateral lines | 7 Pit privy | 11 Fuel storage | 15 Oil well/Gas well |
| 2 Sewer lines | 5 Cess pool | 8 Sewage lagoon | 12 Fertilizer storage | 16 Other (specify below) |
| 3 Watertight sewer lines | 6 Seepage pit | 9 Feedyard | 13 Insecticide storage | River Flooding |
| Direction from well? Possible sewer lines | | | How many feet? River $\frac{1}{4}$ mile South | |

| FROM | TO | LITHOLOGIC LOG | FROM | TO | LITHOLOGIC LOG |
|------|------|---|------|----|----------------|
| | | #1 of Battery of 5 wells | | | |
| 0 | 8" | Cement | | | |
| 8' | 6' | Clay & sandy soil. | | | |
| 6' | 13' | Neat cement | | | |
| 13' | 17' | Bentonite | | | |
| 17' | 150' | Chlorinated gravel pack | | | |
| | | This well is one of a battery of 5 wells. The pit is cement, with a cement floor. The bottom of the pit was also filled with neat cement. Above the casing the pit was filled completely with clay and sandy soil, and cemented to the top end of the pit and man hole to prevent moisture collecting in the pit. | | | |

7 CONTRACTOR'S OR LANDOWNER'S CERTIFICATION: This water well was (1) constructed, (2) reconstructed, or (3) plugged under my jurisdiction and was completed on (mo/day/year) 5/26/88 and this record is true to the best of my knowledge and belief. Kansas Water Well Contractor's License No. 145 This Water Well Record was completed on (mo/day/yr) 6/6/88 under the business name of Henkle Drilling & Supply Company, Inc. by (signature) *Henry Henkle*

INSTRUCTIONS: Use typewriter or ball point pen. PLEASE PRESS FIRMLY and PRINT clearly. Please fill in blanks, underline or circle the correct answers. Send top three copies to Kansas Department of Health and Environment, Bureau of Water Protection, Topeka, Kansas 66620-7320, Telephone: 913-862-9360. Send one to WATER WELL OWNER and retain one for your records.

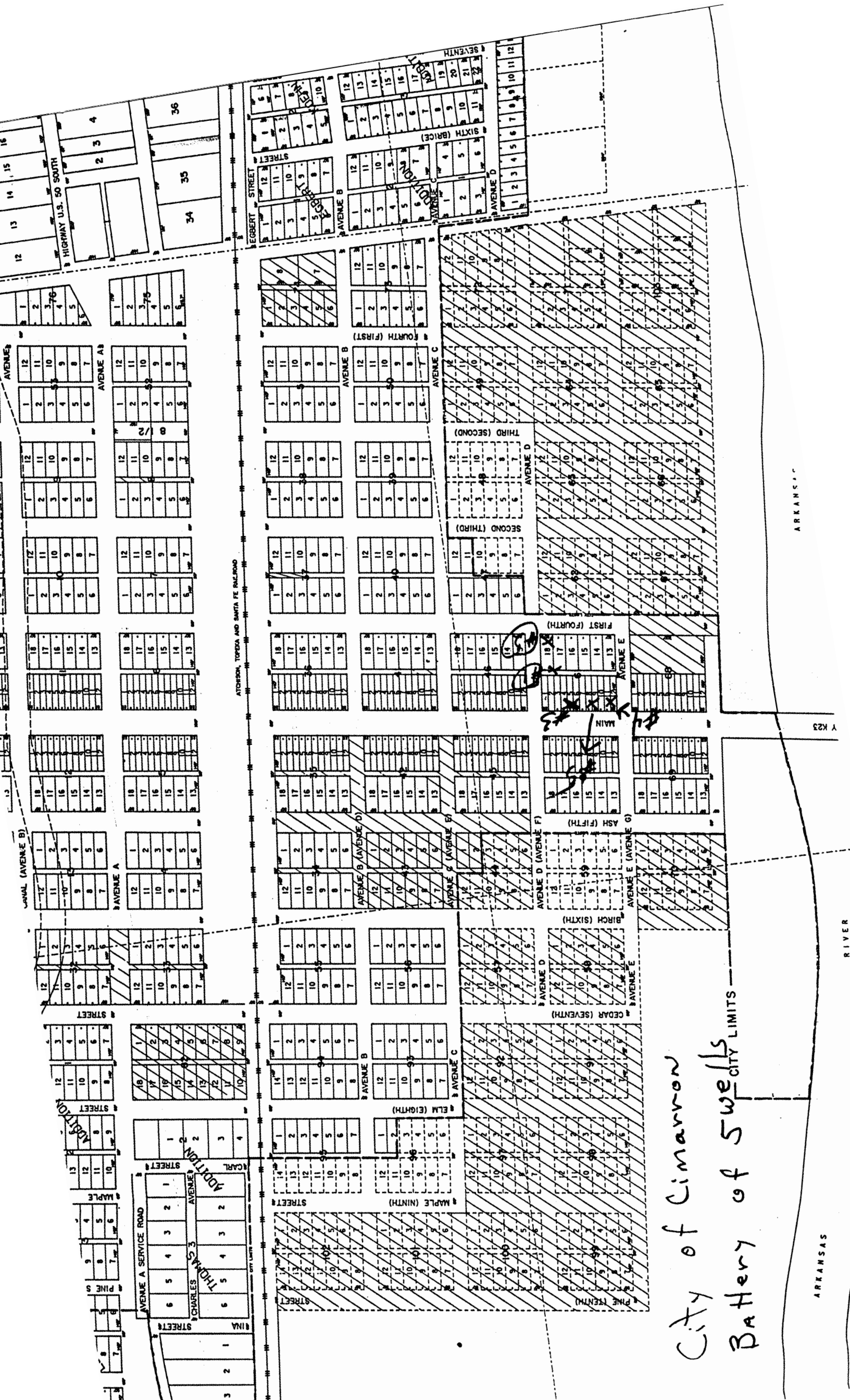

City of Cimarron
Battery of Swells

ARKANSAS

ARKANSAS

RIVER