

WATER WELL RECORD

Form WWC-5

Division of Water Resources App. No.

1 LOCATION OF WATER WELL: County: Sedgwick	Fraction ¼ ¼ ¼ NW ¼	Section Number 22	Township No. T 26 S	Range Number R 3 <input type="checkbox"/> E <input checked="" type="checkbox"/> W
--	----------------------------------	----------------------	------------------------	--

Street/Rural Address of Well Location; if unknown, distance & direction from nearest town or intersection: If at owner's address, check here .
26191 W. 53rd St. N.
Andale, KS 67001

Global Positioning System (GPS) information:
Latitude: (in decimal degrees)
Longitude: (in decimal degrees)
Elevation:
Datum: WGS 84, NAD 83, NAD 27
Collection Method:
 GPS unit (Make/Model:)
 Digital Map/Photo, Topographic Map, Land Survey
Est. Accuracy: <3 m, 3-5 m, 5-15 m, >15 m

2 WATER WELL OWNER: Comfort Homes
RR#, Street Address, Box #: 4313 N. 119th St. W.
City, State, ZIP Code : Maize, KS 67101

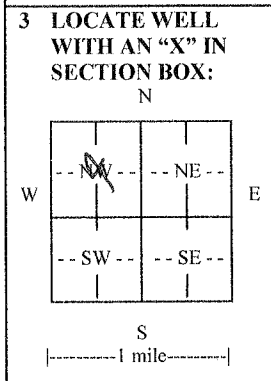

4 DEPTH OF COMPLETED WELL 80 ft.

Depth(s) Groundwater Encountered (1) 40 ft. (2) ft. (3) ft.
WELL'S STATIC WATER LEVEL 40 ft. below land surface measured on mo/day/yr.....

Pump test data: Well water was ft. after hours pumping gpm
EST. YIELD 12 gpm. Well water was ft. after hours pumping gpm
Bore Hole Diameter 10 in. to 80 ft., and in. to ft.

WELL WATER TO BE USED AS: Public water supply Geothermal Injection well
 Domestic Feedlot Oil field water supply Dewatering Other (Specify below)
 Irrigation Industrial Domestic-lawn & garden Monitoring well

Was a chemical/bacteriological sample submitted to Department? Yes No
If yes, mo/day/yr sample was submitted.....

Water well disinfected? Yes No

5 TYPE OF CASING USED: Steel PVC Other

CASING JOINTS: Glued Clamped Welded Threaded
Casing diameter 5 in. to 80 ft., Diameter in. to ft., Diameter in. to ft.
Casing height above land surface 12 in., Weight 2.5 lbs./ft., Wall thickness or gauge No. SDR26

TYPE OF SCREEN OR PERFORATION MATERIAL:
 Steel Stainless Steel PVC Other (Specify)
 Brass Galvanized Steel None used (open hole)

SCREEN OR PERFORATION OPENINGS ARE:
 Continuous slot Mill slot Gauze wrapped Torch cut Drilled holes None (open hole)
 Louvered shutter Key punched Wire wrapped Saw cut Other (specify)

SCREEN-PERFORATED INTERVALS: From 40 ft. to 80 ft., From ft. to ft.
From ft. to ft., From ft. to ft.

GRAVEL PACK INTERVALS: From 20 ft. to 80 ft., From ft. to ft.
From ft. to ft., From ft. to ft.

6 GROUT MATERIAL: Neat cement Cement grout Bentonite Other

Grout Intervals: From 3 ft. to 20 ft., From ft. to ft., From ft. to ft.

What is the nearest source of possible contamination:
 Septic tank Lateral lines Pit privy Livestock pens Insecticide storage Other (specify below)
 Sewer lines Cesspool Sewage lagoon Fuel storage Abandoned water well
 Watertight sewer lines Seepage pit Feedyard Fertilizer storage Oil well/gas well

Direction from well 90 Distance from well 50

FROM	TO	LITHOLOGIC LOG	FROM	TO	LITHO. LOG (cont.) or PLUGGING INTERVALS
0	3	Topsoil			
3	20	Clay			
30	80	Shale			

7 CONTRACTOR'S OR LANDOWNER'S CERTIFICATION: This water well was constructed, reconstructed, or plugged under my jurisdiction and was completed on (mo/day/year) 08/30/2014 and this record is true to the best of my knowledge and belief. Kansas Water Well Contractor's License No. 238 This Water Well Record was completed on (mo/day/year) 9/2/2014 under the business name of Premier Pump & Well Service, Inc. by (signature) *Maize*

INSTRUCTIONS: Use typewriter or ball point pen. PLEASE PRESS FIRMLY and PRINT clearly. Please fill in blanks and check the correct answers. Send one copy to Kansas Department of Health and Environment, Bureau of Water, Geology Section, 1000 SW Jackson St., Suite 420, Topeka, Kansas 66612-1367. Telephone 785-296-5524. Send one copy to WATER WELL OWNER and retain one for your records. Include fee of \$5.00 for each constructed well. Visit us at <http://www.kdheks.gov/waterwell/index.html>