

WATER WELL RECORD Form WWC-5

Original Record Correction Change in Well Use

Division of Water Resources App. No.

Well ID

1 LOCATION OF WATER WELL: County: SEDGWICK	Fraction SE 1/4 NW 1/4 NE 1/4	Section Number 15	Township Number T 26 S	Range Number R 3 <input type="checkbox"/> E <input checked="" type="checkbox"/> W
---	---	-----------------------------	----------------------------------	---

2 WELL OWNER: Last Name: **DIXON** First: **SHAWN**
 Business Address: **437 VEN JOHN**
 City: **ANDALE** State: **KS** ZIP: **67001**
 Street or Rural Address where well is located (if unknown, distance and direction from nearest town or intersection): If at owner's address, check here:

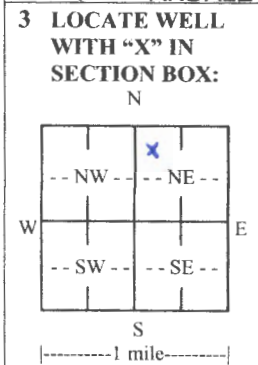

4 DEPTH OF COMPLETED WELL: **90** ft.
 Depth(s) Groundwater Encountered: 1) ft.
 2) ft. 3) ft., or 4) Dry Well
 WELL'S STATIC WATER LEVEL: ft.
 below land surface, measured on (mo-day-yr).....
 above land surface, measured on (mo-day-yr).....
 Pump test data: Well water was ft.
 after hours pumping gpm
 Well water was ft.
 after hours pumping gpm
 Estimated Yield: gpm
 Bore Hole Diameter: **11.5** in. to **90** ft. and
 in. to ft.

5 Latitude: (decimal degrees)
Longitude: (decimal degrees)
 Horizontal Datum: WGS 84 NAD 83 NAD 27
 Source for Latitude/Longitude:
 GPS (unit make/model:)
 (WAAS enabled? Yes No)
 Land Survey Topographic Map
 Online Mapper:

6 Elevation: ft. Ground Level TOC
 Source: Land Survey GPS Topographic Map
 Other

7 WELL WATER TO BE USED AS:

1. Domestic: <input type="checkbox"/> Household <input checked="" type="checkbox"/> Lawn & Garden <input type="checkbox"/> Livestock	5. <input type="checkbox"/> Public Water Supply: well ID	10. <input type="checkbox"/> Oil Field Water Supply: lease
2. <input type="checkbox"/> Irrigation	6. <input type="checkbox"/> Dewatering: how many wells?	11. Test Hole: well ID
3. <input type="checkbox"/> Feedlot	7. <input type="checkbox"/> Aquifer Recharge: well ID	<input type="checkbox"/> Cased <input type="checkbox"/> Uncased <input type="checkbox"/> Geotechnical
4. <input type="checkbox"/> Industrial	8. <input type="checkbox"/> Monitoring: well ID	12. Geothermal: how many bores?
	9. Environmental Remediation: well ID	a) Closed Loop <input type="checkbox"/> Horizontal <input type="checkbox"/> Vertical
	<input type="checkbox"/> Air Sparge <input type="checkbox"/> Soil Vapor Extraction	b) Open Loop <input type="checkbox"/> Surface Discharge <input type="checkbox"/> Inj. of Water
	<input type="checkbox"/> Recovery <input type="checkbox"/> Injection	13. <input type="checkbox"/> Other (specify):

Was a chemical/bacteriological sample submitted to KDHE? Yes No If yes, date sample was submitted:

Water well disinfected? Yes No

8 TYPE OF CASING USED: Steel PVC Other CASING JOINTS: Glued Clamped Welded Threaded
 Casing diameter **5** in. to **90** ft., Diameter in. to ft., Diameter in. to ft.
 Casing height above land surface **15** in. Weight lbs./ft. Wall thickness or gauge No. **SDR-26**

TYPE OF SCREEN OR PERFORATION MATERIAL:
 Steel Stainless Steel Fiberglass PVC Other (Specify)
 Brass Galvanized Steel Concrete tile None used (open hole)

SCREEN OR PERFORATION OPENINGS ARE:
 Continuous Slot Mill Slot Gauze Wrapped Torch Cut Drilled Holes Other (Specify)
 Louvered Shutter Key Punched Wire Wrapped Saw Cut None (Open Hole)

SCREEN-PERFORATED INTERVALS: From **59** ft. to **90** ft., From ft. to ft., From ft. to ft.
GRAVEL PACK INTERVALS: From **29** ft. to **90** ft., From ft. to ft., From ft. to ft.

9 GROUT MATERIAL: Neat cement Cement grout Bentonite Other
 Grout Intervals: From **3** ft. to **29** ft., From ft. to ft., From ft. to ft.

Nearest source of possible contamination:
 Septic Tank Lateral Lines Pit Privy Livestock Pens Insecticide Storage
 Sewer Lines Cess Pool Sewage Lagoon Fuel Storage Abandoned Water Well
 Watertight Sewer Lines Seepage Pit Feedyard Fertilizer Storage Oil Well/Gas Well
 Other (Specify)

Direction from well? **SOUTH** Distance from well? **48** ft.

10 FROM	TO	LITHOLOGIC LOG	FROM	TO	LITHO. LOG (cont.) or PLUGGING INTERVALS
0	1	TOP SOIL			
1	20	SANDY CLAY			
20	54	CLAY			
54	55	FINE SAND			
55	58	CLAY			
58	60	MED SAND			
60	90	GRAY SHALE			
Notes:					

11 CONTRACTOR'S OR LANDOWNER'S CERTIFICATION: This water well was constructed, reconstructed, or plugged under my jurisdiction and was completed on (mo-day-year) **8/14/2018** and this record is true to the best of my knowledge and belief. Kansas Water Well Contractor's License No. **884**. This Water Well Record was completed on (mo-day-year) **8/15/2018** under the business name of **WENINGER DRILLING LLC**. Signature: _____

Mail 1 white copy along with a fee of \$5.00 for each constructed well to: Kansas Department of Health and Environment, Bureau of Water, GWTS Section, 1000 SW Jackson St., Suite 420, Topeka, Kansas 66612-1367. Mail one to Water Well Owner and retain one for your records. Telephone 785-296-5524. Visit us at <http://www.kdheks.gov/waterwell/index.html> KSA 82a-1212 **Revised 7/10/2015**