

WATER WELL RECORD

Form WWC-5

Division of Water Resources App. No.

22,577

1 LOCATION OF WATER WELL: County: FINNEY Fraction 1/4 SE 1/4 SE 1/4 NE 1/4 Section Number 23 Township No. T 26 S Range Number R 34 [] E [x] W

Street/Rural Address of Well Location; if unknown, distance & direction from nearest town or intersection: HOLCOMB-4 M S, 1 M W, 6 M S TO PARALLEL RD, 3/4 M E, 4-1/3 M S, 3,090 FT. N. & 485 FT. W.

2 WATER WELL OWNER: DUANE E KOSTER TRUST 12-15-06 RR#, Street Address, Box #: KATHLEEN KOSTER " " City, State, ZIP Code : PO BOX 897 GARDEN CITY, KS

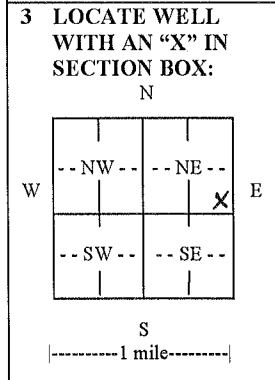

3 LOCATE WELL WITH AN 'X' IN SECTION BOX: 4 DEPTH OF COMPLETED WELL 435 ft. Depth(s) Groundwater Encountered (1) 262 ft. (2) ft. (3) ft. WELL'S STATIC WATER LEVEL 262 ft. below land surface measured on mo/day/yr. 11-4-11

5 TYPE OF CASING USED: [x] Steel [] PVC [] Other CASING JOINTS: [] Glued [] Clamped [x] Welded [] Threaded Casing diameter 16 in. to 290 ft., Diameter in. to ft., Diameter in. to ft. Casing height above land surface 12 in., Weight 42.05 lbs./ft., Wall thickness or gauge No. 250

6 GROUT MATERIAL: [] Neat cement [x] Cement grout [] Bentonite [] Other Grout Intervals: From 0 ft. to 20 ft., From 210 ft. to 270 ft., From ft. to ft. What is the nearest source of possible contamination: [] Septic tank [] Lateral lines [] Pit privy [] Livestock pens [] Insecticide storage [] Other (specify below)

Table with columns FROM, TO, LITHOLOGIC LOG, FROM, TO, LITHO. LOG (cont.) or PLUGGING INTERVALS. Row 1 contains 'SEE ATTACHED LOG'.

7 CONTRACTOR'S OR LANDOWNER'S CERTIFICATION: This water well was [x] constructed, [] reconstructed, or [] plugged under my jurisdiction and was completed on (mo/day/year) 11-4-11 and this record is true to the best of my knowledge and belief. Kansas Water Well Contractor's License No. 208 This Water Well Record was completed on (mo/day/year) 11-8-11 under the business name of MINTER-WILSON DRILLING CO. INC. by (signature) Nora Keller

INSTRUCTIONS: Use typewriter or ball point pen. PLEASE PRESS FIRMLY and PRINT clearly. Please fill in blanks and check the correct answers. Send three copies (white, blue, pink) to Kansas Department of Health and Environment, Bureau of Water, Geology Section, 1000 SW Jackson St., Suite 420, Topeka, Kansas 66612-1367. Telephone 785-296-5522. Send one copy to WATER WELL OWNER and retain one for your records. Include fee of \$5.00 for each constructed well. Visit us at http://www.kdheks.gov/waterwell/index.html.

*The
Professionals*

MINTER-WILSON DRILLING CO.

INCORPORATED

Irrigation
and Domestic
Water Systems
Complete Installation
and Repairing

Phone 620-276-8269 • P.O. Box A • GARDEN CITY, KANSAS 67846

NAME KOSTER FARMS - CIRCLE # G118
COUNTY FINNEY
DATE 6-6-11

LOCATION: NE 1/4 23-26-34 - IVANHOE & TV ROAD - 1-1/2 MILES WEST,
1/2 MILE SOUTH & 1/2 MILE EAST
- SOUTHEAST EDGE OF CIRCLE
37 DEGREE - 46.455 ' NORTH
101 DEGREE - 0.010 ' WEST

STATIC WATER LEVEL - 260 FT.

TEST # 5

0' TO 4' - FINE SAND
4' TO 15' - BROWN SANDY CLAY
15' TO 40' - FINE TO MEDIUM SAND WITH STRIPS OF BROWN SANDY CLAY
40' TO 73' - FINE TO MEDIUM SAND & GRAVEL - SOME COARSE
73' TO 90' - BROWN SANDY CLAY
90' TO 105' - FINE TO MEDIUM SAND & GRAVEL
WITH LAYERS OF BROWN SANDY CLAY
105' TO 160' - BROWN SANDY CLAY WITH A FEW STRIPS OF GRAVEL
160' TO 175' - FINE TO MEDIUM SAND & GRAVEL
175' TO 198' - BROWN SANDY CLAY WITH LAYERS OF GRAVEL
198' TO 232' - FINE TO MEDIUM SAND & GRAVEL
WITH STRIPS OF BROWN SANDY CLAY
232' TO 243' - BROWN SANDY CLAY WITH STRIPS OF GRAVEL
243' TO 258' - FINE TO MEDIUM SAND & GRAVEL
258' TO 266' - BROWN SANDY CLAY
266' TO 276' - FINE TO MEDIUM SAND & GRAVEL
276' TO 284' - BROWN SANDY CLAY
284' TO 289' - FINE TO MEDIUM SAND & GRAVEL
289' TO 294' - BROWN SANDY CLAY
294' TO 319' - FINE TO MEDIUM SAND
WITH LAYERS OF WHITE SANDY CLAY - 30%
319' TO 331' - BROWN SANDY CLAY
331' TO 342' - FINE TO MEDIUM SAND
WITH STRIPS OF BROWN SANDY CLAY - 20%
342' TO 366' - BROWN SANDY CLAY WITH STRIPS OF WHITE ROCK
366' TO 369' - FINE SAND
369' TO 374' - BROWN SANDY CLAY
374' TO 391' - BROWN CLAY
391' TO 402' - FINE TO MEDIUM SAND
WITH STRIPS OF BROWN SANDY CLAY - 20%
402' TO 413' - BROWN CLAY
413' TO 415' - LOOSE BROWN ROCK - TOOK WATER
415' TO 430' - HARD BROWN & YELLOW CLAY & WHITE CLAY
WITH 20% BROWN ROCK
430' TO 440' - HARD BROWN CLAY & GRAY SHALE WITH 10% WHITE SANDY CLAY
440' TO 450' - SHALE - 250 PULL DOWN