

WATER WELL RECORD

Form WWC-5

Division of Water Resources; App. No.

1 LOCATION OF WATER WELL: Fraction SW 1/4 SE 1/4 NE 1/4 Section Number 2 Township Number T 26 S Range Number 5 E
County: BUTLER
Distance and direction from nearest town or city street address of well if located within city? 90' N of 301 E Central Ave, El Dorado KS

2 WATER WELL OWNER: Nick Badwey
RR#, St. Address, Box #: 423 S. Alleghany St.
City, State, ZIP Code: El Dorado, KS 67042
Global Positioning System (decimal degrees, min. of 4 digits)
Latitude: N°
Longitude: W°
Elevation:
Datum:
Data Collection Method: legal survey

3 LOCATE WELL'S LOCATION WITH AN "X" IN SECTION BOX: (Diagram showing a 36-section grid with 'X' in the center section)
4 DEPTH OF COMPLETED WELL 19.0 ft.
Depth(s) Groundwater Encountered 1 MW11 ft. 2 ft. 3 ft.
WELL'S STATIC WATER LEVEL ft. below land surface measured on mo/day/yr
Pump test data: Well water was ft. after hours pumping gpm
Est. Yield gpm: Well water was ft. after hours pumping gpm
WELL WATER TO BE USED AS: 5 Public water supply 8 Air conditioning 11 Injection well
1 Domestic 3 Feed lot 6 Oil field water supply 9 Dewatering 12 Other (Specify below)
2 Irrigation 4 Industrial 7 Domestic (lawn & garden) 10 Monitoring well
Was a chemical/bacteriological sample submitted to Department? Yes No X, If yes, mo/day/yr
Sample was submitted Water Well Disinfected? Yes No X

5 TYPE OF CASING USED: 5 Wrought Iron 8 Concrete tile CASING JOINTS: Glued Clamped
1 Steel 3 RMP (SR) 6 Asbestos-Cement 9 Other (specify below) Welded
2 PVC 4 ABS 7 Fiberglass Threaded X
Blank casing diameter 2 in. to 6 ft., Dia in. to ft., Dia in. to ft.
Casing height below land surface ft., Weight lbs./ft. Wall thickness or gauge No.
TYPE OF SCREEN OR PERFORATION MATERIAL:
1 Steel 3 Stainless steel 5 Fiberglass 7 PVC 9 ABS 11 Other (specify)
2 Brass 4 Galvanized steel 6 Concrete tile 8 RM (SR) 10 Asbestos-Cement 12 None used (open hole)
SCREEN OR PERFORATION OPENINGS ARE:
1 Continuous slot 3 Mill slot 5 Gauze wrapped 7 Torch cut 9 Drilled holes 11 None (open hole)
2 Louvered shutter 4 Key punched 6 Wire wrapped 8 Saw Cut 10 Other (specify)
SCREEN-PERFORATED INTERVALS: From 6 ft. to 19 ft. From ft. to ft.
GRAVEL PACK INTERVALS: From 4 ft. to 19.25 ft. From ft. to ft.

6 GROUT MATERIAL: 1 Neat cement 2 Cement grout 3 Bentonite 4 Other Concrete: 0-1
Grout Intervals From 1 ft. to 4 ft. From ft. to ft. From ft. to ft.
What is the nearest source of possible contamination:
1 Septic tank 4 Lateral lines 7 Pit privy 10 Livestock pens 13 Insecticide Storage 16 Other (specify below)
2 Sewer lines 5 Cess pool 8 Sewage lagoon 11 Fuel storage 14 Abandoned water well
3 Watertight sewer lines 6 Seepage pit 9 Feedyard 12 Fertilizer storage 15 Oil well/ gas well
Direction from well? S How many feet? ~100'

Table with columns: FROM, TO, LITHOLOGIC LOG, FROM, TO, PLUGGING INTERVALS.
Rows: 0-5 Grass on top; Black silty clay; 5-13 Brown clay; 13-15 Gray clay; 15-18.5 Weathered limestone; 18.5-19.25 Weathered limestone & till; Flushmount waiver from BOW

7 CONTRACTOR'S OR LANDOWNER'S CERTIFICATION: This water well was 1 constructed, 2 reconstructed, or 3 plugged under my jurisdiction and was completed on (mo/day/year) 4/3/14 and this record is true to the best of my knowledge and belief.
Kansas Water Well Contractor's License No. 757 This Water Well Record was completed on (mo/day/year) 4/29/14 under the business name of Larsen & Associates, Inc. by (signature)

INSTRUCTIONS: Please fill in blanks or circle the correct answers. Send top three copies to Kansas Department of Health and Environment, Bureau of Water, Geology Section, 1000 SW Jackson St., Suite 420, Topeka, Kansas 66612-1367. Telephone 785-296-5522. Send one to WATER WELL OWNER and retain one for your records. Fee of \$5.00 for each constructed well. Visit us at http://www.kdheks.gov/waterwell.

NOTE: Figures exhibited within this report are only to be used within the context of this report. Placement of property lines, wells, structures, and roads is based on the available information from county appraiser maps, surveys, site visits, and/or previous vendor reports and should be considered approximate. Estimated concentration lines represent estimated contaminant concentrations based on data collected during the sampling event. Actual extent or concentration of contamination beyond the sample point is unknown.

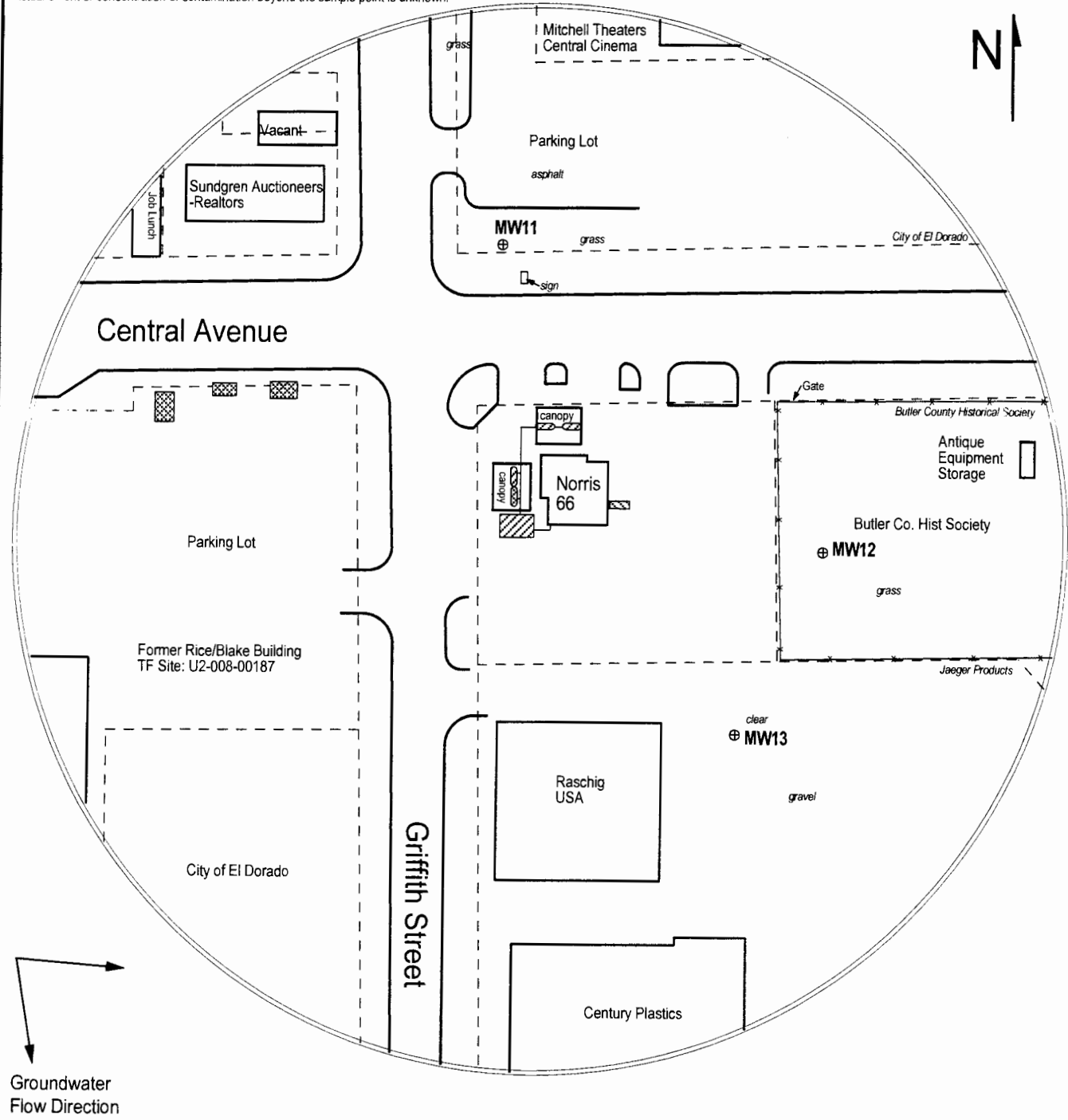

FIGURE 1 - 350 FT SITE BASE MAP



PROJECT:

Norris 66 Service
301 E. Central
El Dorado, KS
KDHE ID: U2-008-12252
Date: 10/14/13



LEGEND:

- Approximate Location of Active & Former UST Basin, Product Line and Pump Islands
- Approximate Location of Former Waste Oil UST
- Approximate Location of Former UST Basins & Pump Island
- Approximate Location of Property Lines
- Monitoring Well
- Plugged Monitoring Well
- Proposed Monitoring Well

NOTE: Utility depths and locations are approximate.

1311 E 25th St., Suite B (785) 841-8707 office
Lawrence, KS 66046 (785) 865-4282 fax