

WATER WELL PLUGGING RECORD Form WWC-5P KSA 82a-1212 ID NO.

1 LOCATION OF WATER WELL: County: Sedgwick Fraction 1/4 E 1/4 SW 1/4 E 1/4 Section Number 8 Township Number T 27 S Range Number 1 E W

Street/Rural Address of Well Location; if unknown, distance & direction from nearest town or intersection: If at owner's address, check here 1407 N Westfield St Wichita, KS 67212

Global Positioning Systems (GPS) information:
 Latitude: _____ (in decimal degrees)
 Longitude: _____ (in decimal degrees)
 Elevation: _____
 Datum: WGS84, NAD83, NAD27
 Collection Method:
 GPS unit (Make/Model: _____)
 Digital Map/Photo, Topographic Map, Land Survey
 Est. Accuracy: < 3 m, 3-5 m, 5-15 m, > 15 m

2 WATER WELL OWNER: Art Schweithel
 RR#, St. Address, Box #: 1407 N Westfield St
 City, State ZIP Code: Wichita, KS 67212

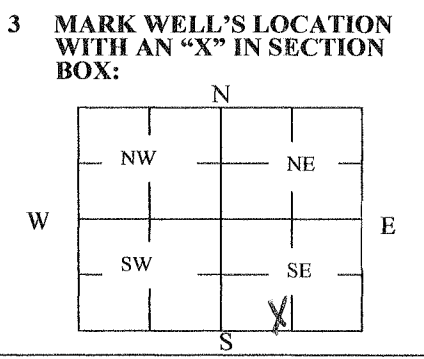

4 DEPTH OF WELL 22 ft.
 WELL'S STATIC WATER LEVEL 10 ft.
 WELL WAS USED AS:
 Domestic Public Water Supply Dewatering
 Irrigation Oil Field Water Supply Monitoring
 Feedlot Domestic (Lawn & Garden) Injection Well
 Industrial Air Conditioning Other _____
 Was a chemical/bacteriological sample submitted to Department? Yes No

5 TYPE OF BLANK CASING USED:
 Steel RMP (SR) Wrought Fiberglass Other (Specify below)
 PVC ABS Asbestos-Cement Concrete Tile
 Blank casing diameter 1 1/4 in. Was casing pulled? Yes No If yes, how much 36 in.
 Casing height above or below land surface 38 in.

6 GROUT PLUG MATERIAL: Neat cement Cement grout Bentonite Other _____
 Grout Plug Intervals: From 0 ft. to 22 ft., From _____ ft. to _____ ft., From _____ ft. to _____ ft.

What is the nearest source of possible contamination:
 Septic tank Seepage pit Fuel storage Other (specify below)
 Sewer lines Pit privy Fertilizer storage
 Watertight sewer lines Sewage lagoon Insecticide storage
 Lateral lines Feedyard Abandoned water well
 Cess pool Livestock pens Oil well/Gas well
 Direction from well? East
 How many feet? 30ft

FROM	TO	PLUGGING MATERIALS	FROM	TO	PLUGGING MATERIALS
<u>0</u>	<u>22</u>	<u>Cement grout</u>			

7 CONTRACTOR'S OR LANDOWNER'S CERTIFICATION: This water well was plugged under my jurisdiction and was completed on (mo/day/year) 6-2-14 and this record is true to the best of my knowledge and belief. Kansas Water Well Contractor's License No. 884. This Water Well Record was completed on (mo/day/year) 6/2/2014 under the business name of Weninger Drilling LLC by (signature) TransCutter

INSTRUCTIONS: Use typewriter or ballpoint pen. Please press firmly and print clearly. Please fill in blanks, underline or circle the correct answers. Send top three copies to Kansas Department of Health and Environment, Bureau of Water, Geology Section, 1000 SW Jackson St., Ste. 420, Topeka, Kansas 66612-1367. Telephone: 785/296-5524. Send one to Water Well Owner and retain one for your records. Visit us at <http://www.kdheks.gov/waterwell/index.html>.