

**WATER WELL RECORD Form WWC-5**

Division of Water Resources App. No.  

Well ID MW-11

Original Record  Correction  Change in Well Use

**1 LOCATION OF WATER WELL:**  
 County: Wichita SEDGWICK Fraction NW ¼ NE ¼ NE ¼ NW ¼ Section Number 10 Township Number T 27 S Range Number R 1 E W

**2 WELL OWNER:** Last Name: Coastal Mart First:    
 Business: Coastal Mart  
 Address: 2102 E. 21st St.  
 Address:    
 City: Wichita State: Ks. ZIP: 67214  
 Street or Rural Address where well is located (if unknown, distance and direction from nearest town or intersection): If at owner's address, check here:   
Approx. 550 ft. E. of intersection of Platt St. & E. 21st St. N, approx. 150 ft. south of E 21st St. N.

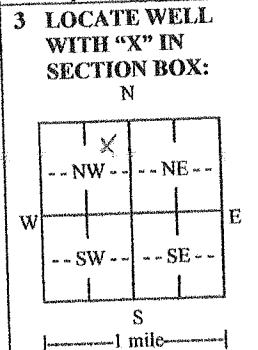

**4 DEPTH OF COMPLETED WELL:** 25 ft.  
 Depth(s) Groundwater Encountered: 1) 20 ft.  
 2)   ft. 3)   ft., or 4)  Dry Well  
 WELL'S STATIC WATER LEVEL:   ft.  
 below land surface, measured on (mo-day-yr).....  
 above land surface, measured on (mo-day-yr).....  
 Pump test data: Well water was   ft.  
 after..... hours pumping ..... gpm  
 Well water was   ft.  
 after..... hours pumping ..... gpm  
 Estimated Yield:   gpm  
 Bore Hole Diameter: 8.25 in. to 25 ft. and  
  in. to   ft.

**5 Latitude:** 37.72208 (decimal degrees)  
**Longitude:** -97.31044 (decimal degrees)  
 Horizontal Datum:  WGS 84  NAD 83  NAD 27  
 Source for Latitude/Longitude:  
 GPS (unit make/model: .....)  
 (WAAS enabled?  Yes  No)  
 Land Survey  Topographic Map  
 Online Mapper: .....  
**6 Elevation:** 1312 ft.  Ground Level  TOC  
 Source:  Land Survey  GPS  Topographic Map  
 Other .....

**7 WELL WATER TO BE USED AS:**

1. Domestic:  
 Household  
 Lawn & Garden  
 Livestock

2.  Irrigation  
 3.  Feedlot  
 4.  Industrial

5.  Public Water Supply: well ID .....

6.  Dewatering: how many wells? .....

7.  Aquifer Recharge: well ID .....

8.  Monitoring: well ID MW-11

9. Environmental Remediation: well ID .....

Air Sparge  Soil Vapor Extraction  
 Recovery  Injection

10.  Oil Field Water Supply: lease .....

11. Test Hole: well ID .....

Cased  Uncased  Geotechnical

12. Geothermal: how many bores? .....

a) Closed Loop  Horizontal  Vertical  
 b) Open Loop  Surface Discharge  Inj. of Water

13.  Other (specify): .....

Was a chemical/bacteriological sample submitted to KDHE?  Yes  No If yes, date sample was submitted: .....

Water well disinfected?  Yes  No

**8 TYPE OF CASING USED:**  Steel  PVC  Other .....

Casing diameter 2 in. to 15 ft., Diameter ..... in. to ..... ft., Diameter ..... in. to ..... ft.  
 Casing height above land surface 0 in. Weight ..... lbs./ft. Wall thickness or gauge No. sch 40

**TYPE OF SCREEN OR PERFORATION MATERIAL:**  
 Steel  Stainless Steel  Fiberglass  PVC  
 Brass  Galvanized Steel  Concrete tile  None used (open hole)  Other (Specify) .....

**SCREEN OR PERFORATION OPENINGS ARE:**  
 Continuous Slot  Mill Slot  Gauze Wrapped  Torch Cut  Drilled Holes  Other (Specify) .....

**SCREEN-PERFORATED INTERVALS:** From 15 ft. to 25 ft., From ..... ft. to ..... ft. to ..... ft.  
 From 13 ft. to 25 ft., From ..... ft. to ..... ft. to ..... ft.

**GRAVEL PACK INTERVALS:** From 13 ft. to 25 ft., From ..... ft. to ..... ft. to ..... ft.

**9 GROUT MATERIAL:**  Neat cement  Cement grout  Bentonite  Other .....

Grout Intervals: From 0 ft. to ..... ft., From 13 ft. to ..... ft. to ..... ft.

**Nearest source of possible contamination:**  
 Septic Tank  Lateral Lines  Pit Privy  Livestock Pens  Insecticide Storage  
 Sewer Lines  Cess Pool  Sewage Lagoon  Fuel Storage  Abandoned Water Well  
 Watertight Sewer Lines  Seepage Pit  Feedyard  Fertilizer Storage  Oil Well/Gas Well  
 Other (Specify) .....

Direction from well? ..... Distance from well? ..... ft.

10 FROM	TO	LITHOLOGIC LOG	FROM	TO	LITHO. LOG (cont.) or PLUGGING INTERVALS
0	9	Silty Clay, brown to dark brown, stiff to hard, dry to slightly moist, slightly plastic, no odor	20	25	Sand, tan to brown, medium to coarse, well rounded, wet to saturated
9	14.5	Silty Clay, brown, damp to moist, firm, plastic, cohesive, no odor			
14.5	20	Sand, tan to brown, reddish in part, trace silty, fine to medium, damp, no odor			

Notes: .....

**11 CONTRACTOR'S OR LANDOWNER'S CERTIFICATION:** This water well was  constructed,  reconstructed, or  plugged under my jurisdiction and was completed on (mo-day-year) 9/24/2015..... and this record is true to the best of my knowledge and belief. Kansas Water Well Contractor's License No. 604..... This Water Well Record was completed on (mo-day-year) 10/13/15..... under the business name of Environmental Priority Service, Inc. Signature J.C. ...