

1 LOCATION OF WATER WELL: Fraction NE 1/4 SW 1/4 SW 1/4 SW 1/4 Section Number 3 Township Number T 27 S Range Number 1 E V
 County: Sedgewick

Street/Rural Address of Well Location; if unknown, distance & direction from nearest town or intersection: If at owner's address, check here 7120 West 21st North
Wichita, KS 67212

Global Positioning Systems (GPS) information:
 Latitude: 37.7238 (in decimal degrees)
 Longitude: -97.425844 (in decimal degrees)
 Elevation: 1332
 Datum: WGS84, NAD83, NAD27

2 WATER WELL OWNER: Quik Trip Corporation
 RR#, St. Address, Box #: 4705 S 129th East Ave
 City, State ZIP Code: Tulsa, OK 74134

Collection Method:
 GPS unit (Make/Model: _____)
 Digital Map/Photo, Topographic Map, Land Survey
 Est. Accuracy: <3 m, 3-5 m, 5-15 m, >15 m

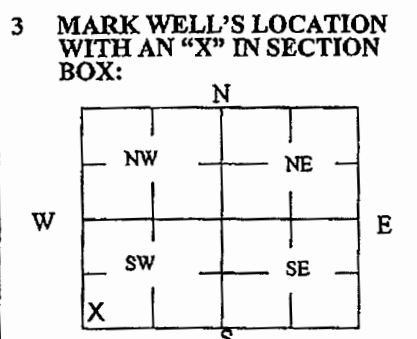

4 DEPTH OF WELL 51' ft.
WELL'S STATIC WATER LEVEL 15.5' ft
WELL WAS USED AS:
 Domestic Public Water Supply Dewatering
 Irrigation Oil Field Water Supply Monitoring
 Feedlot Domestic (Lawn & Garden) Injection Well
 Industrial Air Conditioning Other _____
 Was a chemical/bacteriological sample submitted to Department? Yes No

5 TYPE OF BLANK CASING USED:
 Steel RMP (SR) Wrought Fiberglass Other (Specify below) _____
 PVC ABS Asbestos-Cement Concrete Tile _____
 Blank casing diameter 4" in. Was casing pulled? Yes No If yes, how much _____
 Casing height above or below land surface 36" in.

6 GROUT PLUG MATERIAL: Neat cement Cement grout Bentonite Other _____
 Grout Plug Intervals: From 3' ft. to 51' ft., From _____ ft. to _____ ft., From _____ ft. to _____ ft.
 What is the nearest source of possible contamination:
 Septic tank Seepage pit Fuel storage Other (specify below) _____
 Sewer lines Pit privy Fertilizer storage _____
 Watertight sewer lines Sewage lagoon Insecticide storage _____
 Lateral lines Feedyard Abandoned water well Oil well/Gas well Direction from well? Southeast
 Cess pool Livestock pens How many feet? 150'

| FROM | TO | PLUGGING MATERIALS | FROM | TO | PLUGGING MATERIALS |
|------|-----|--------------------|------|----|--------------------|
| 0' | 3' | Clay Soil | | | |
| 3' | 51' | Bentonite | | | |
| | | | | | |
| | | | | | |
| | | | | | |

7 CONTRACTOR'S OR LANDOWNER'S CERTIFICATION: This water well was plugged under my jurisdiction and was completed on (mo/day/year) 04/22/2016 and this record is true to the best of my knowledge and belief. Kansas Water Well Contractor's License No. 851. This Water Well Record was completed on (mo/day/year) 05/01/2016 under the business name of GHD Services, Inc by (signature) [Signature]

INSTRUCTIONS: Use typewriter or ballpoint pen. Please press firmly and print clearly. Please fill in blanks, underline or circle the correct answers. Send top three copies to Kansas Department of Health and Environment, Bureau of Water, Geology Section, 1000 SW Jackson St., Ste. 420, Topeka, Kansas 66612-1367. Telephone: 785/296-5524. Send one to Water Well Owner and retain one for your records. Visit us at <http://www.kdheks.gov/waterwell/index.html>.
 GHD Project #111104676