

WATER WELL PLUGGING RECORD Form WWC-5P KSA 82a-1212 ID NO.

1 **LOCATION OF WATER WELL:** Fraction NW 1/4 NW 1/4 NE 1/4 Section Number 14 Township Number T 27 S Range Number 1 E W
 County: Seelye

Street/Rural Address of Well Location; if unknown, distance & direction from nearest town or intersection: If at owner's address, check here
4515 Whitehall

Global Positioning Systems (GPS) information:
 Latitude: _____ (in decimal degrees)
 Longitude: _____ (in decimal degrees)
 Elevation: _____
 Horizontal Datum: WGS84, NAD83, NAD27
 Collection Method: _____
 GPS unit (Make/Model: _____)
 Digital Map/Photo. Topographic Map. Land Survey
 Est. Accuracy: <3 m. 3-5 m. 5-15 m. > 15 m

2 **WATER WELL OWNER:** CHRIS ZANDLER
 RR#, St. Address, Box #: 4515 WHITEHALL
 City, State ZIP Code: WICHITA, KJ 67212

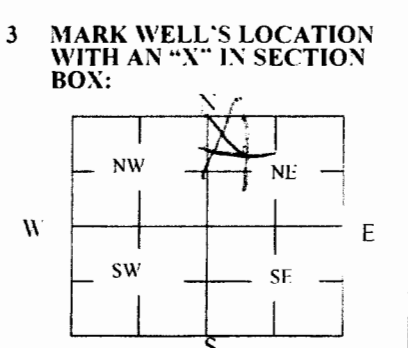

4 **DEPTH OF WELL** 25 ft.
WELL'S STATIC WATER LEVEL 11 ft.
WELL WAS USED AS:
 Domestic Public Water Supply Dewatering
 Irrigation Oil Field Water Supply Monitoring
 Feedlot Domestic (Lawn & Garden) Injection Well
 Industrial Air Conditioning Other _____
 Was a chemical bacteriological sample submitted to Department? Yes No

5 **TYPE OF BLANK CASING USED:**
 Steel RMP (SR) Wrought Fiberglass Other (Specify below)
 PVC ABS Asbestos-Cement Concrete Tile
 Blank casing diameter 1 1/4 in. Was casing pulled? Yes No If yes, how much 5'
 Casing height above or below land surface 60 in.

6 **GROUT PLUG MATERIAL:** Neat cement Cement grout Bentonite Other _____
 Grout Plug Intervals: From 25 ft. to 0 ft., From _____ ft. to _____ ft., From _____ ft. to _____ ft.
 What is the nearest source of possible contamination:
 Septic tank Seepage pit Fuel storage Other (specify below) Flow Drain
 Sewer lines Pit privy Fertilizer storage
 Watertight sewer lines Sewage lagoon Insecticide storage
 Lateral lines Feedyard Abandoned water well
 Cess pool Livestock pens Oil well/Gas well
 Direction from well? South
 How many feet? 3'

FROM	TO	PLUGGING MATERIALS	FROM	TO	PLUGGING MATERIALS
<u>25</u>	<u>0</u>	<u>Cement Grout</u>			

7 **CONTRACTOR'S OR LANDOWNER'S CERTIFICATION:** This water well was plugged under my jurisdiction and was completed on (mo/day/year) 7-3-17 and this record is true to the best of my knowledge and belief. Kansas Water Well Contractor's License No. 472. This Water Well Record was completed on (mo/day/year) 7-3-17 under the business name of Beardsley Pump & Well by (signature) David Beek

Send one white copy to Kansas Department of Health & Environment, Geology Section, 1000 SW Jackson Street, Ste. 420, Topeka, KS 66612-1367. Send one copy to WATER WELL OWNER and retain one for your records.
 Visit us at <http://www.kdheks.gov/waterwell/index.html> Telephone 785-296-5524.