

WATER WELL RECORD

Form WWC-5

Division of Water Resources App. No.

Well ID

MW7

Original Record Correction Change in Well Use

1 LOCATION OF WATER WELL: County Sedgwick Fraction NW 1/4 SW 1/4 SW 1/4 SW 1/4 Section Number 25 Township Number T 27 S Range Number R 1 E W

2 WELL OWNER: Last Name: First: Street or Rural Address where well is located (if unknown, distance and direction from nearest town or intersection): If at owner's address, check here: 1550 S. West St. Wichita, KS 67211

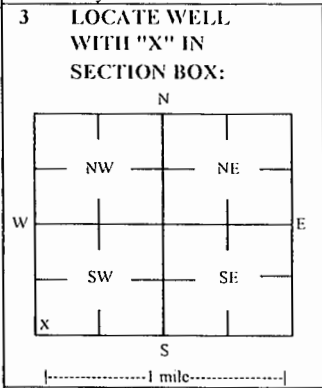

4 DEPTH OF COMPLETED WELL: 20 ft. Depth(s) Groundwater Encountered: 1) 1 ft. 2) ft 3) ft, or 4) Dry Well. WELL'S STATIC WATER LEVEL: 15.4 ft. below land surface, measured on (mo-day-yr) 3/8/22.

5 Latitude: 37.66695 (decimal degrees) Longitude: 97.38847 (decimal degrees) Horizontal Datum: X WGS 84 NAD 83 NAD 27 Source for Latitude/Longitude: GPS (unit make/model) (WAAS enabled? Yes No) X Land Survey Topographic Map Online Mapper

6 Elevation 1301.18 ft Ground Level X TOC Source X Land Survey GPS Topographic Map Other

7 WELL WATER TO BE USED AS: 1 Domestic: Household Lawn & Garden Livestock Irrigation Feedlot Industrial. 5 Public Water Supply: well ID. 6 Dewatering: how many wells? 7 Aquifer Recharge: well ID. 8 Monitoring: well ID MW7. 9 Environmental Remediation: well ID. 10 Oil Field Water Supply: lease. 11 Test Hole: well ID. 12 Geothermal: How many bores? a) Closed Loop Horizontal Vertical b) Open Loop Surface Discharge Inj. of Water Other (specify):

Was a chemical/bacteriological sample submitted to KDHE? Yes No X No If yes, date sample was submitted:

8 TYPE OF CASING USED: Steel X PVC Other CASING JOINTS: Glued Clamped Welded X Threaded. Casing diameter 2 in. to 10 ft, Diameter in. to ft, Diameter in. to ft. Casing height above land surface -0.51 in. Weight lbs./ft. Well thickness or gauge No. TYPE OF SCREEN OR PERFORATION MATERIAL: Steel Stainless Steel Fiberglass X PVC Other (Specify). SCREEN OR PERFORATION OPENINGS ARE: Continuous Slot X Mill Slot Gauze Wrapped Torch Cut Drilled Holes Other (Specify). Louvered Shutter Key Punched Wire Wrapped Saw Cut None (Open Hole). SCREEN-PERFORATED INTERVALS: From 10 ft. to 20 ft. GRAVEL PACK INTERVALS: From 8 ft. to 20 ft.

9 GROUT MATERIAL: Neat cement Cement grout X Bentonite X Other Concrete: 0-0.3'. Grout intervals: From 0.3 ft. to 8 ft. From ft. to ft. From ft. to ft.

Nearest source of possible contamination: Septic Tank Lateral Lines Pit Privy Livestock Pens Insecticide Storage Sewer Lines Cess Pool Sewage Lagoon X Fuel Storage Abandoned Water Well Watertight Sewer Lines Seepage Pit Feedyard Fertilizer Storage Oil Well / Gas Well Other (Specify). Direction from well? S Distance from well? ~40 ft

Table with columns: 10 FROM, TO, LITHOLOGIC LOG, FROM, TO, LITHO. LOG (cont.) or PLUGGING INTERVALS. Row 1: 0, 1, Topsoil. Row 2: 1, 20, Sand.

Notes: KDHE ID: Foley Tractor Company; U2-087-00216 Target of monitoring well is shallow groundwater, <20' of grout was installed at the direction of KDHE.

11 CONTRACTOR'S OR LANDOWNER'S CERTIFICATION: This water well was X constructed, reconstructed, or plugged under my jurisdiction and was completed on (mo-day-year) 10/28/21 and this record is true to the best of my knowledge and belief. Kansas Water Well Contractor's License No. 757 This Water Well Record was completed on (mo-day-year) 3/22/22 under the business name of Larsen & Associates, Inc. Signature

EX-1000000

25-27-1W

**DENNIS L HANDKE**

1820 NW 59th Terrace  
TOPEKA, KANSAS 66618  
785-286-4047 Home

Jess Chapman  
Larsen & Associates  
1311 E. 25<sup>th</sup> Street, Suite B  
Lawrence, Kansas, 66046

November 17, 2021

RE: Monitor Well Elevation Survey  
1550 South West St. Wichita, Kansas

Proj. 21-00MM  
Foley Tractor  
U2-087-00216

Bench Mark: Chisled Square on NW side of concrete signal light base near the SW corner of property.  
Elev: 1299.60      North 25.78      West 5211.61      (from SE Cor. Sec. 25-27-1W)

MW-6	rim	1301.85	North	291.91	SW1/4,SW1/4,SW1/4,SW1/4
	top pipe	1301.50	West	5164.06	Lat= 37.66662    Long = 97.38892
MW-7	rim	1301.69	North	409.84	NW1/4,SW1/4,SW1/4,SW1/4
	top pipe	1301.18	West	5034.55	Lat= 37.66695    Long = 97.38847
MW-8	rim	1301.21	North	286.52	SE1/4,SW1/4,SW1/4,SW1/4
	top pipe	1300.87	West	4734.21	Lat= 37.66661    Long = 97.38743

Lat & Long derived from Wichita West 7.5' quad map. WGS 84.

Elevation established from City of Wichita BM at Sheridan & Harry St. NAVD 88

If you have any questions, please feel free to call me. Thank you for the opportunity to be of service to you.

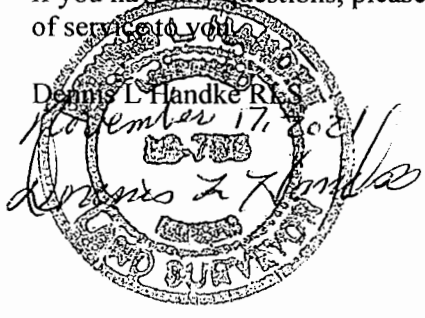

Sedgwick

NOTE: Figures exhibited within this report are only to be used within the context of this report. Placement of property lines, wells, structures, and roads is based on the available information from county appraiser maps, surveys, site visits, and/or previous vendor reports and should be considered approximate.

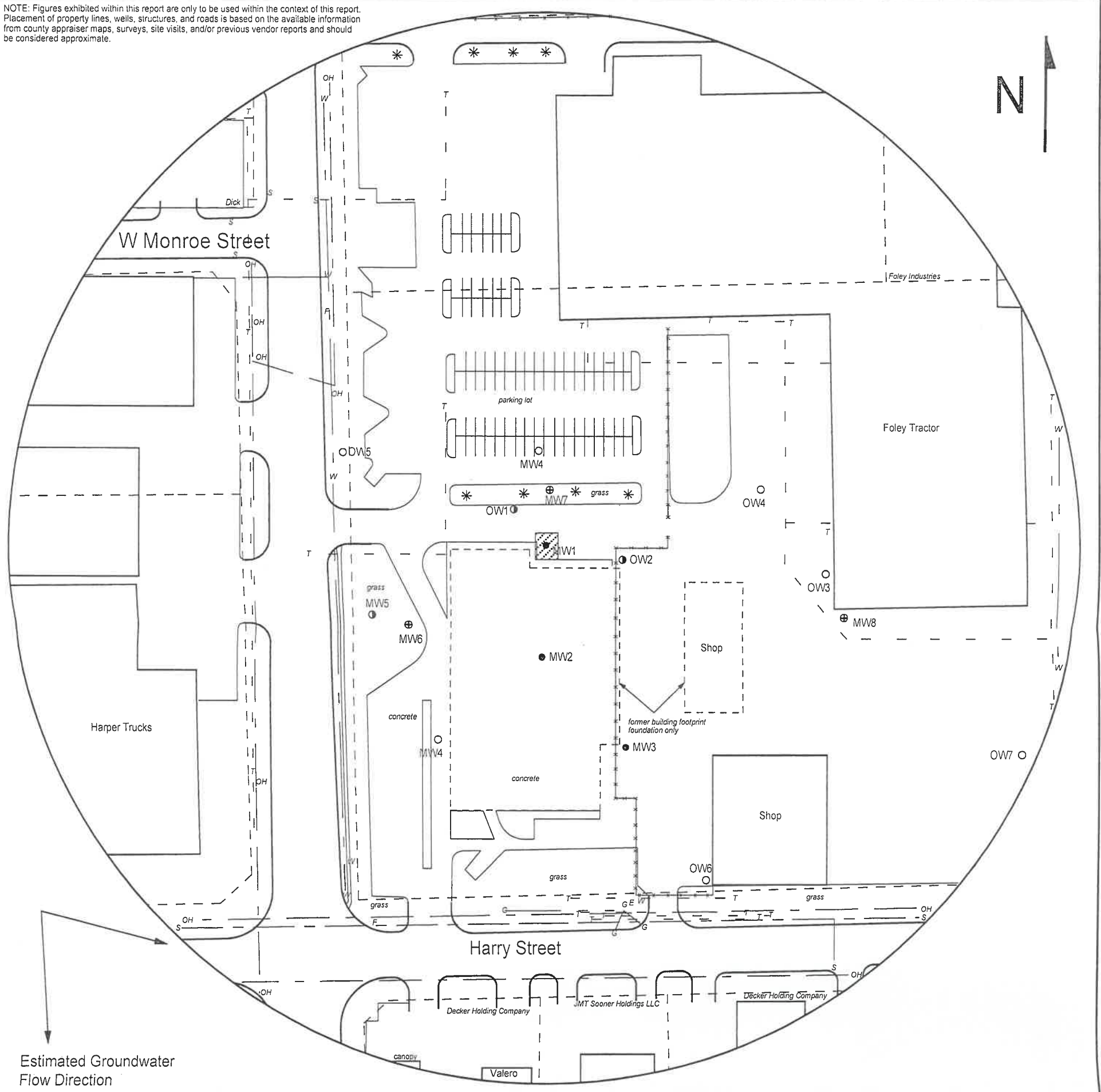

FIGURE 1 - 500 FT RADIUS AREA BASE MAP

LEGEND

- Approximate Location of Former UST Basin
- Approximate Location of Property Line
- Existing Monitoring Well
- Plugged Well
- Destroyed Monitoring Well
- New Monitoring Well (Installed 10/28/21)
- Fire Hydrant
- Electric Lines (1.5 - 3 ft bgs)
- Gas Lines (1.5 - 3 ft bgs)
- Overhead Lines (25'-40' high)
- Sewer Lines (2 - 6 ft bgs)
- Telephone Lines (2 - 6 ft bgs)
- Water Lines (2 - 6 ft bgs)

NOTE: Utility depths, heights and locations are approximate.



**PROJECT:**  
 Foley Tractor  
 1550 South West Street  
 Wichita, KS  
 KDHE ID: U2-087-00216  
 Date: 10/28/21

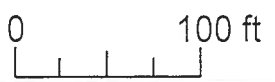

1311 E 25th St., Suite B 785-841-8707 office  
 Lawrence, KS 66046 785-865-4282 fax

RECEIVED  
 APR 08 2022  
 BUREAU OF WATER

25-27-1W