

**WATER WELL PLUGGING RECORD Form WWC-5P KSA 82a-1212 ID NO.**

|  |                                |                      |                           |  |
|--|--------------------------------|----------------------|---------------------------|--|
| <b>1 LOCATION OF WATER WELL:</b><br>County: SEDGWICK | Fraction<br>NW ¼ NW¼ SW ¼ NW ¼ | Section Number<br>27 | Township Number<br>T 27 S | Range Number<br>1 <input type="checkbox"/> E <input checked="" type="checkbox"/> W |
|--|--------------------------------|----------------------|---------------------------|--|

Street/Rural Address of Well Location; if unknown, distance & direction from nearest town or intersection: If at owner's address, check here  526 S. RIDGE RD. WICHITA, KS 67209

**Global Positioning Systems (GPS) information:**  
 Latitude: 37.67558 (in decimal degrees)  
 Longitude: -97.42565 (in decimal degrees)  
 Elevation: \_\_\_\_\_  
 Horizontal Datum:  WGS84,  NAD83,  NAD27  
 Collection Method: \_\_\_\_\_

**2 WATER WELL OWNER:** West Side Real Estate LLC  
 RR#, St. Address, Box #: 5331 W KELLOGG DR.  
 City, State ZIP Code: WICHITA, KS 67218

GPS unit (Make/Model: I-PHONE)  
 Digital Map/Photo,  Topographic Map,  Land Survey  
 Est. Accuracy:  < 3 m,  3-5 m,  5-15 m,  > 15 m

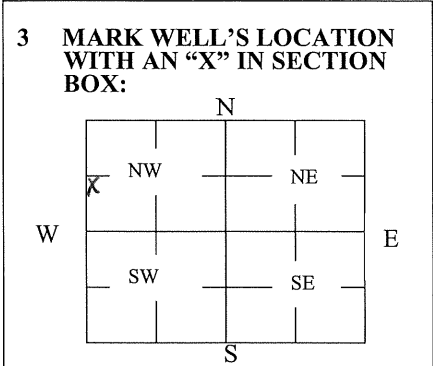

**4 DEPTH OF WELL** 65 ft.  
 WELL'S STATIC WATER LEVEL 28 ft.  
 WELL WAS USED AS:

|                                     |  |   |
|-------------------------------------|--|---|
| <input type="checkbox"/> Domestic   | <input type="checkbox"/> Public Water Supply                 | <input type="checkbox"/> Dewatering     |
| <input type="checkbox"/> Irrigation | <input type="checkbox"/> Oil Field Water Supply              | <input type="checkbox"/> Monitoring     |
| <input type="checkbox"/> Feedlot    | <input checked="" type="checkbox"/> Domestic (Lawn & Garden) | <input type="checkbox"/> Injection Well |
| <input type="checkbox"/> Industrial | <input type="checkbox"/> Air Conditioning                    | <input type="checkbox"/> Other _____    |

Was a chemical/bacteriological sample submitted to Department? Yes  No

**5 TYPE OF BLANK CASING USED:**

|                                |                                   |  |  |   |
|--------------------------------|-----------------------------------|--|--|---|
| <input type="checkbox"/> Steel | <input type="checkbox"/> RMP (SR) | <input type="checkbox"/> Wrought         | <input type="checkbox"/> Fiberglass    | <input checked="" type="checkbox"/> Other (Specify below) |
| <input type="checkbox"/> PVC   | <input type="checkbox"/> ABS      | <input type="checkbox"/> Asbestos-Cement | <input type="checkbox"/> Concrete Tile | <u>STYRENE</u>  |

Blank casing diameter 5 in. Was casing pulled? Yes  No  If yes, how much \_\_\_\_\_  
 Casing height above or below land surface 36 Below in.

**6 GROUT PLUG MATERIAL:**  Neat cement  Cement grout  Bentonite  Other \_\_\_\_\_

Grout Plug Intervals: From 3 ft. to 28 ft., From \_\_\_\_\_ ft. to \_\_\_\_\_ ft., From \_\_\_\_\_ ft. to \_\_\_\_\_ ft.

What is the nearest source of possible contamination:

|  |   |   |  |
|--|---|---|--|
| <input type="checkbox"/> Septic tank                       | <input type="checkbox"/> Seepage pit    | <input type="checkbox"/> Fuel storage         | <input type="checkbox"/> Other (specify below) |
| <input type="checkbox"/> Sewer lines                       | <input type="checkbox"/> Pit privy      | <input type="checkbox"/> Fertilizer storage   |  |
| <input checked="" type="checkbox"/> Watertight sewer lines | <input type="checkbox"/> Sewage lagoon  | <input type="checkbox"/> Insecticide storage  |  |
| <input type="checkbox"/> Lateral lines                     | <input type="checkbox"/> Feedyard       | <input type="checkbox"/> Abandoned water well | Direction from well? <u>EAST</u>               |
| <input type="checkbox"/> Cess pool                         | <input type="checkbox"/> Livestock pens | <input type="checkbox"/> Oil well/Gas well    | How many feet? <u>70'+</u>                     |

| FROM | TO | PLUGGING MATERIALS      | FROM | TO | PLUGGING MATERIALS |
|------|----|-------------------------|------|----|--------------------|
| 0    | 3  | COMAPCATED TOP SOIL     |      |    |                    |
| 3    | 28 | BENTONITE               |      |    |                    |
| 28   | 65 | CHLORINATED WELL GRAVEL |      |    |                    |
|      |    |                         |      |    |                    |
|      |    |                         |      |    |                    |

**7 CONTRACTOR'S OR LANDOWNER'S CERTIFICATION:** This water well was plugged under my jurisdiction and was completed on (mo/day/year) 4-11-2024 and this record is true to the best of my knowledge and belief. Kansas Water Well Contractor's License No. 236. This Water Well Record was completed on (mo/day/year) 4-12-2024 under the business name of HARP WELL & PUMP SERVICE, INC, by (signature) TODD S. HARP

Send one white copy to Kansas Department of Health & Environment, Geology Section, 1000 SW Jackson Street, Ste. 420, Topeka, KS 66612-1367. Send one copy to WATER WELL OWNER and retain one for your records.  
 Visit us at <http://www.kdheks.gov/waterwell/index.html> Telephone 785-296-5524.