

LOCATION OF WATER WELL	Fraction	Section Number	Township Number	Range Number
County: Pratt	NE 1/4 NE 1/4 NW 1/4	6	T 27 S	R 12 EW

Distance and direction from nearest town or city? 3 1/2 mi. E. of Iuka
 Street address of well if located within city?

WATER WELL OWNER: KGS
 RR#, St. Address, Box #
 City, State, ZIP Code

Board of Agriculture, Division of Water Resources
 Application Number:

DEPTH OF COMPLETED WELL: 196 ft. Bore Hole Diameter: 9 7/8 in. to _____ ft., and _____ in. to _____

Well Water to be used as:

1 Domestic	3 Feedlot	5 Public water supply	8 Air conditioning	11 Injection well
2 Irrigation	4 Industrial	6 Oil field water supply	9 Dewatering	12 Other (Specify below)
		7 Lawn and garden only	10 Observation well	<u>Research</u>

Well's static water level: 30.3 ft. below land surface measured on Jan month 28 day 1983 year

Pump Test Data: Well water was _____ ft. after _____ hours pumping. _____ gpm
 Est. Yield: Well water was _____ ft. after _____ hours pumping. _____ gpm

TYPE OF BLANK CASING USED:

1 Steel	3 RMP (SR)	5 Wrought iron	8 Concrete tile	Casing Joints: <input checked="" type="checkbox"/> Glued <input type="checkbox"/> Clamped
2 PVC	4 ABS	6 Asbestos-Cement	9 Other (specify below)	Welded
		7 Fiberglass		Threaded

Blank casing dia: 5 in. to _____ ft., Dia _____ in. to _____ ft., Dia _____ in. to _____ ft.

Casing height above land surface: 12 in., weight _____ lbs./ft. Wall thickness or gauge No. Schedule 1120

TYPE OF SCREEN OR PERFORATION MATERIAL:

1 Steel	3 Stainless steel	5 Fiberglass	7 PVC	10 Asbestos-cement
2 Brass	4 Galvanized steel	6 Concrete tile	8 RMP (SR)	11 Other (specify)
			9 ABS	12 None used (open hole)

Screen or Perforation Openings Are:

1 Continuous slot	2 Mill slot	5 Gauzed wrapped	8 Saw cut	11 None (open hole)
2 Louvered shutter	4 Key punched	6 Wire wrapped	9 Drilled holes	
		7 Torch cut	10 Other (specify)	

Screen-Perforation Dia: 5 in. to _____ ft., Dia _____ in. to _____ ft., Dia _____ in. to _____ ft.

Screen-Perforated Intervals: From 196 ft. to 191 ft., From _____ ft. to _____ ft., From _____ ft. to _____ ft.

Gravel Pack Intervals: From 196 ft. to ~~196~~ 176 ft., From _____ ft. to _____ ft., From _____ ft. to _____ ft.

GROUT MATERIAL: Neat cement Cement grout Bentonite Other

Grouted Intervals: From 176 ft. to 137 ft., From _____ ft. to _____ ft., From _____ ft. to _____ ft.

What is the nearest source of possible contamination:

1 Septic tank	4 Cess pool	7 Sewage lagoon	10 Fuel storage	14 Abandoned water well
2 Sewer lines	5 Seepage pit	8 Feed yard	11 Fertilizer storage	15 Oil well/Gas well
3 Lateral lines	6 Pit privy	9 Livestock pens	12 Insecticide storage	16 Other (specify below)
			13 Watertight sewer lines	

Direction from well _____ How many feet _____ ? Water Well Disinfected? Yes _____ No _____

Was a chemical/bacteriological sample submitted to Department? Yes _____ No _____ If yes, date sample was submitted _____ month _____ day _____ year: Pump Installed? Yes _____ No _____

If Yes: Pump Manufacturer's name _____ Model No. _____ HP _____ Volts _____

Depth of Pump Intake _____ ft. Pumps Capacity rated at _____ gal./min.

Type of pump: 1 Submersible 2 Turbine 3 Jet 4 Centrifugal 5 Reciprocating 6 Other

CONTRACTOR'S OR LANDOWNER'S CERTIFICATION: This water well was (1) constructed, (2) reconstructed, or (3) plugged under my jurisdiction and was completed on June month 17 day 1982 year and this record is true to the best of my knowledge and belief. Kansas Water Well Contractor's License No. _____

This Water Well Record was completed on June month 22 day 1982 year by the business name of _____ by (signature)

LOCATE WELL'S LOCATION WITH AN "X" IN SECTION BOX:	FROM	TO	LITHOLOGIC LOG	FROM	TO	LITHOLOGIC LOG
	0	18	H. brown sandy clay	74	89	sand interbedded with sandy clay
	18	22	fine to med. grained sand with some clay streaks	89	92	H. grey brown sandy clay
	22	31	H. reddish brown sandy clay	92	116	H. grey-brown sandy clay interbedded with limestone
	31	41	Sand interbedded with sandy clay			Sand at 112
	41	45	H. grey-brown sandy clay interbedded with limestone	116	129	Sand and gravel with limestone at top
	45	51	H. grey-brown sandy clay	129	130	brown clay, little silt or sand
	51	72	sand and gravel	130	135	sand and gravel
	72	74	H. red-brown sandy clay	135	138	brown sticky clay
				138	149	Sand and gravel
	ELEVATION: <u>1892.9</u>					

Depth(s) Groundwater Encountered 1. _____ ft. 2. _____ ft. 3. _____ ft. 4. _____ ft. (Use a second sheet if needed)

INSTRUCTIONS: Use typewriter or ball point pen, please press firmly and PRINT clearly. Please fill in blanks, underline or circle the correct answers. Send top three copies to Kansas Department of Health and Environment, Division of Environment, Water Well Contractors, Topeka, KS 66620. Send one to WATER WELL OWNER and retain one for your records

LOCATION OF WATER WELL	Fraction	Section Number	Township Number	Range Number
County:	1/4 1/4 1/4		T S	R E/W

Distance and direction from nearest town or city? _____ Street address of well if located within city? _____

WATER WELL OWNER: _____
 RR#, St. Address, Box # _____ Board of Agriculture, Division of Water Resources
 City, State, ZIP Code _____ Application Number: _____

DEPTH OF COMPLETED WELL _____ ft. Bore Hole Diameter _____ in. to _____ ft., and _____ in. to _____ ft.
 Well Water to be used as:
 1 Domestic 3 Feedlot 5 Public water supply 8 Air conditioning 11 Injection well
 2 Irrigation 4 Industrial 6 Oil field water supply 9 Dewatering 12 Other (Specify below)
 7 Lawn and garden only 10 Observation well

Well's static water level _____ ft. below land surface measured on _____ month _____ day _____ year

Pump Test Data: Well water was _____ ft. after _____ hours pumping _____ gpm
 Test Yield _____ gpm: Well water was _____ ft. after _____ hours pumping _____ gpm

TYPE OF BLANK CASING USED:
 1 Steel 3 RMP (SR) 5 Wrought iron 8 Concrete tile Casing Joints: Glued _____ Clamped _____
 2 PVC 4 ABS 6 Asbestos-Cement 9 Other (specify below) Welded _____
 7 Fiberglass Threaded _____

Blank casing dia _____ in. to _____ ft., Dia _____ in. to _____ ft., Dia _____ in. to _____ ft.

Casing height above land surface _____ in., weight _____ lbs./ft. Wall thickness or gauge No _____

TYPE OF SCREEN OR PERFORATION MATERIAL:
 1 Steel 3 Stainless steel 5 Fiberglass 8 RMP (SR) 10 Asbestos-cement
 2 Brass 4 Galvanized steel 6 Concrete tile 9 ABS 11 Other (specify) _____
 12 None used (open hole)

Screen or Perforation Openings Are:
 1 Continuous slot 3 Mill slot 5 Gauzed wrapped 8 Saw cut 11 None (open hole)
 2 Louvered shutter 4 Key punched 6 Wire wrapped 9 Drilled holes
 7 Torch cut 10 Other (specify) _____

Screen-Perforation Dia _____ in. to _____ ft., Dia _____ in. to _____ ft., Dia _____ in. to _____ ft.

Screen-Perforated Intervals: From _____ ft. to _____ ft., From _____ ft. to _____ ft., From _____ ft. to _____ ft.

Gravel Pack Intervals: From _____ ft. to _____ ft., From _____ ft. to _____ ft., From _____ ft. to _____ ft.

GROUT MATERIAL: 1 Neat cement 2 Cement grout 3 Bentonite 4 Other _____
 Grouted Intervals: From _____ ft. to _____ ft., From _____ ft. to _____ ft., From _____ ft. to _____ ft.

What is the nearest source of possible contamination:
 1 Septic tank 4 Cess pool 7 Sewage lagoon 10 Fuel storage 14 Abandoned water well
 2 Sewer lines 5 Seepage pit 8 Feed yard 11 Fertilizer storage 15 Oil well/Gas well
 3 Lateral lines 6 Pit privy 9 Livestock pens 12 Insecticide storage 16 Other (specify below) _____
 13 Watertight sewer lines

Direction from well _____ How many feet _____ ? Water Well Disinfected? Yes _____ No _____

Was a chemical/bacteriological sample submitted to Department? Yes _____ No _____ If yes, date sample was submitted _____ month _____ day _____ year: Pump Installed? Yes _____ No _____

If Yes: Pump Manufacturer's name _____ Model No. _____ HP _____ Volts _____

Depth of Pump Intake _____ ft. Pumps Capacity rated at _____ gal./min

Type of pump: 1 Submersible 2 Turbine 3 Jet 4 Centrifugal 5 Reciprocating 6 Other _____

CONTRACTOR'S OR LANDOWNER'S CERTIFICATION: This water well was (1) constructed, (2) reconstructed, or (3) plugged under my jurisdiction and was completed on _____ month _____ day _____ year and this record is true to the best of my knowledge and belief. Kansas Water Well Contractor's License No. _____ This Water Well Record was completed on _____ month _____ day _____ year under the business name of _____ by (signature) _____

LOCATE WELL'S LOCATION WITH AN "X" IN SECTION BOX:	FROM	TO	LITHOLOGIC LOG	FROM	TO	LITHOLOGIC LOG
	149	152	Continuation of log			
	152	157	silty clay - ft. brown colour			
	157	187	Sand and gravel			
	187	188	reddish clay			
	188	190	red-s			
	152	196	Sand and gravel			
		(abbreviated log)				

ELEVATION: _____
 Depth(s) Groundwater Encountered 1. _____ ft. 2. _____ ft. 3. _____ ft. 4. _____ ft. (Use a second sheet if needed)

INSTRUCTIONS: Use typewriter or ball point pen, please press firmly and PRINT clearly. Please fill in blanks, underline or circle the correct answers. Send top three copies to Kansas Department of Health and Environment, Division of Environment, Water Well Contractors, Topeka, KS 66620. Send one to WATER WELL OWNER and retain one for your records.

BIG BEND GMD#5-KGS
WATER QUALITY
OBSERVATION WELL
NETWORK

SITE NUMBER : 36 (KP11)
SITE LOCATION: NE NE NW

LEGAL LOCATION: 6-27-12W
COUNTY : PRATT

WELL LOG

FROM	TO	LITHOLOGIC LOG	OWNER: BRIGGEMANN/McFADDEN
0	7	light brown sandy loam, little clay	
7	18	light brown sandy clay with minor streaks of fine to medium sand	
18	22	fine to medium sand with some clay streaks	
22	28	light reddish-brown clay, little sand, some silt some lime layers	
28	31	light reddish-brown sandy clay, sticky drilling	
31	37	sand interbedded with sandy clay	
37	41	small gravel layers at 37'; continuation of sand interbedded with sandy clay	
41	45	lime layers interbedded with clay, light grey-brown color, slightly sandy	
45	51	light grey-brown sandy clay, small sand layers, increase in sand with depth	
51	72	sand and gravel, fine to coarse grained	
72	74	light red-brown sandy clay	
74	89	sand with some clay streaks and gravel, sand is fine to medium grained	
89	92	light grey-brown sandy clay	
92	112	light grey-brown clay interbedded with lime; clay is sandy but very gummy--slow drilling	
112	113	sand, fine grained	
113	116	light grey-brown sandy clay and limestone	
116	129	sand interbedded with limestone at top, grading into sand and gravel	
129	130	brown clay, very sticky, no sand, little silt	
130	135	sand and gravel	
135	138	sticky clay	
138	149	sand and gravel	
149	152	silty, slightly sandy clay, light brown color	
152	187	sand and gravel	
187	188	reddish clay	
188	190	red shale	
190	195	sand and gravel	
195	215	red shale--PERMIAN	

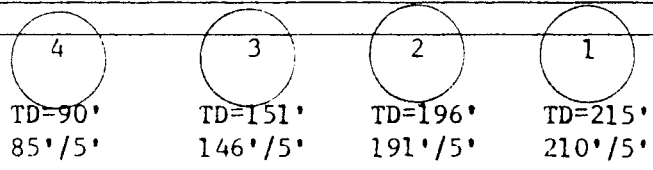

SITE NUMBER : 36 (KPl1)
SITE LOCATION : NE NE NW
LEGAL LOCATION: 6-27-12W
COUNTY : PRATT

LANDOWNER: JAMES MCFADDEN
ADDRESS :

PHONE NO.:
TENANT: LORENCE BRIGGEMANN
RT. 1
IUKA, KS

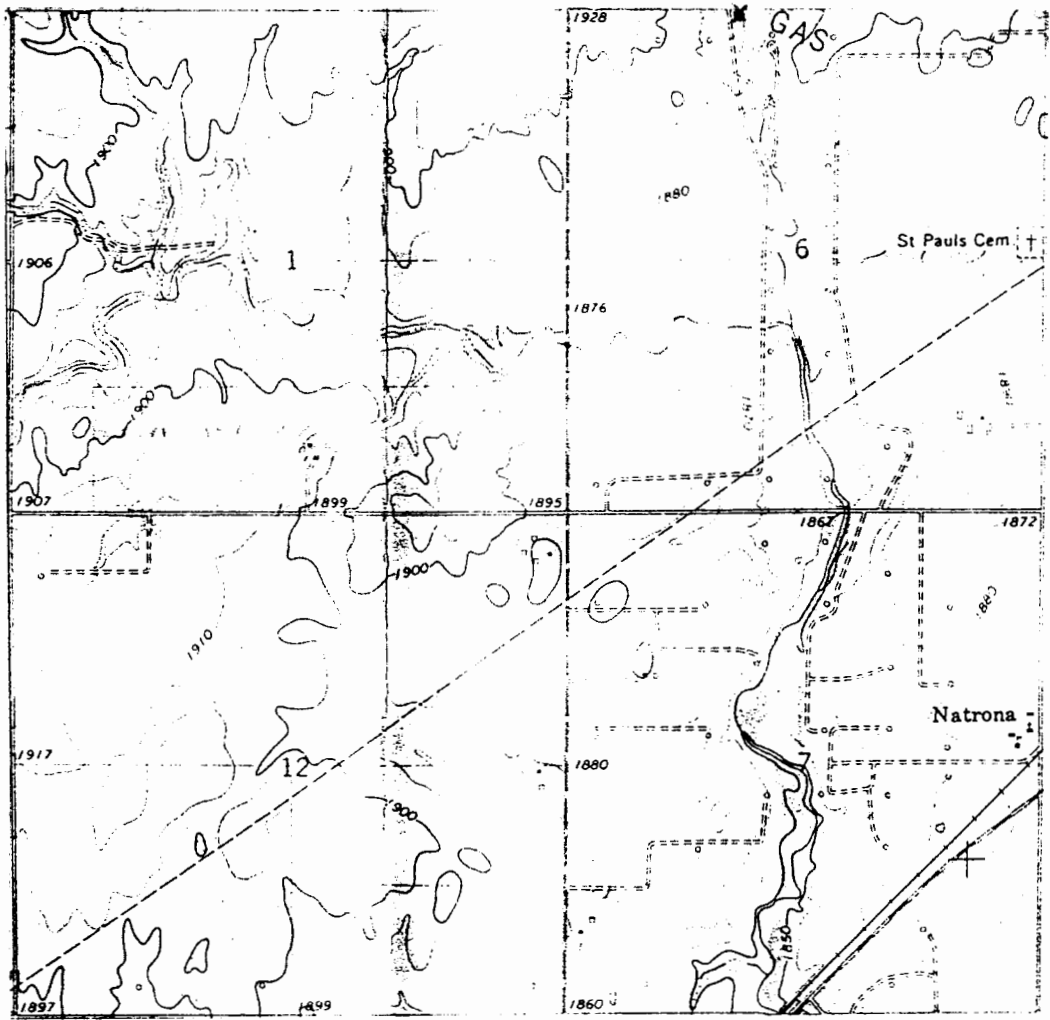

WELL LOCATION *

Pratt topo.

R. 13 W. R. 12 W.

529

40'

530

