

LOCATION OF WATER WELL	Fraction	Section Number	Township Number	Range Number
County: PRATT	NE 1/4 NE 1/4 NW 1/4	6	T 27 S	R 12 E 1/4

Distance and direction from nearest town or city? 3 1/2 mi. E. of Iuka

Street address of well if located within city?

WATER WELL OWNER: KGS

RR#, St. Address, Box #

City, State, ZIP Code

Board of Agriculture, Division of Water Resources  
Application Number:

DEPTH OF COMPLETED WELL: 151 ft. Bore Hole Diameter: 9 7/8 in. to \_\_\_\_\_ ft., and \_\_\_\_\_ in. to \_\_\_\_\_

Well Water to be used as:

1 Domestic	3 Feedlot	5 Public water supply	8 Air conditioning	11 Injection well
2 Irrigation	4 Industrial	6 Oil field water supply	9 Dewatering	(12) Other (Specify below)
		7 Lawn and garden only	10 Observation well	<u>Research</u>

Well's static water level: 21 ft. below land surface measured on Jan month 28 day 1983 year

Pump Test Data: Well water was \_\_\_\_\_ ft. after \_\_\_\_\_ hours pumping \_\_\_\_\_ gpm

Est. Yield: \_\_\_\_\_ gpm Well water was \_\_\_\_\_ ft. after \_\_\_\_\_ hours pumping \_\_\_\_\_ gpm

TYPE OF BLANK CASING USED:

1 Steel	3 RMP (SR)	5 Wrought iron	8 Concrete tile	Casing Joints: Glued <input checked="" type="checkbox"/> Clamped _____
(2) PVC	4 ABS	6 Asbestos-Cement	9 Other (specify below)	Welded _____
		7 Fiberglass		Threaded _____

Blank casing dia: 5 in. to \_\_\_\_\_ ft., Dia \_\_\_\_\_ in. to \_\_\_\_\_ ft., Dia \_\_\_\_\_ in. to \_\_\_\_\_

Casing height above land surface: 12 in., weight \_\_\_\_\_ lbs./ft. Wall thickness or gauge No. Schedule 1120

TYPE OF SCREEN OR PERFORATION MATERIAL:

1 Steel	3 Stainless steel	5 Fiberglass	8 RMP (SR)	10 Asbestos-cement
2 Brass	4 Galvanized steel	6 Concrete tile	9 ABS	11 Other (specify) _____
				12 None used (open hole)

Screen or Perforation Openings Are:

1 Continuous slot	(3) Mill slot	5 Gauzed wrapped	8 Saw cut	11 None (open hole)
2 Louvered shutter	4 Key punched	6 Wire wrapped	9 Drilled holes	
		7 Torch cut	10 Other (specify) _____	

Screen-Perforation Dia: 5 in. to \_\_\_\_\_ ft., Dia \_\_\_\_\_ in. to \_\_\_\_\_ ft., Dia \_\_\_\_\_ in. to \_\_\_\_\_

Screen-Perforated Intervals: From 151 ft. to 146 ft., From \_\_\_\_\_ ft. to \_\_\_\_\_ ft., From \_\_\_\_\_ ft. to \_\_\_\_\_ ft.

Gravel Pack Intervals: From 151 ft. to 127 ft., From \_\_\_\_\_ ft. to \_\_\_\_\_ ft., From \_\_\_\_\_ ft. to \_\_\_\_\_ ft.

GROUT MATERIAL: (1) Neat cement 2 Cement grout 3 Bentonite 4 Other

Grouted Intervals: From 127 ft. to 91 ft., From \_\_\_\_\_ ft. to \_\_\_\_\_ ft., From \_\_\_\_\_ ft. to \_\_\_\_\_ ft.

What is the nearest source of possible contamination:

1 Septic tank	4 Cess pool	7 Sewage lagoon	10 Fuel storage	14 Abandoned water well
2 Sewer lines	5 Seepage pit	8 Feed yard	11 Fertilizer storage	15 Oil well/Gas well
3 Lateral lines	6 Pit privy	9 Livestock pens	12 Insecticide storage	16 Other (specify below)
			13 Watertight sewer lines	

Direction from well \_\_\_\_\_ How many feet \_\_\_\_\_? Water Well Disinfected? Yes \_\_\_\_\_ No \_\_\_\_\_

Was a chemical/bacteriological sample submitted to Department? Yes \_\_\_\_\_ No \_\_\_\_\_ If yes, date sample was submitted \_\_\_\_\_ month \_\_\_\_\_ day \_\_\_\_\_ year Pump Installed? Yes \_\_\_\_\_ No \_\_\_\_\_

If Yes: Pump Manufacturer's name \_\_\_\_\_ Model No. \_\_\_\_\_ HP \_\_\_\_\_ Volts \_\_\_\_\_

Depth of Pump Intake \_\_\_\_\_ ft. Pumps Capacity rated at \_\_\_\_\_ gal./min

Type of pump: 1 Submersible 2 Turbine 3 Jet 4 Centrifugal 5 Reciprocating 6 Other

CONTRACTOR'S OR LANDOWNER'S CERTIFICATION: This water well was (1) constructed, (2) reconstructed, or (3) plugged under my jurisdiction and was completed on June month 17 day 1982 year and this record is true to the best of my knowledge and belief. Kansas Water Well Contractor's License No. \_\_\_\_\_

This Water Well Record was completed on June month 22 day 1982 year under the business name of \_\_\_\_\_ by (signature) \_\_\_\_\_

LOCATE WELL'S LOCATION WITH AN "X" IN SECTION BOX:	FROM	TO	LITHOLOGIC LOG	FROM	TO	LITHOLOGIC LOG
	0	18	th. brown sandy clay	92	116	th. grey-brown sandy clay
	18	22	fine to med. grained sand with some clay streaks	116	129	interbedded with limestone sand and gravel with limestone at top
	22	31	th. reddish-brown sandy clay	129	130	brown clay, little silt or sand
	31	41	sand interbedded with sandy clay	130	135	sand and gravel
	41	45	th. grey-brown sandy clay with lime	135	138	brown sticky clay
	45	51	th. grey-brown sandy clay	138	151	sand and gravel
	51	72	sand and gravel			
	72	74	th. red-brown sandy clay			(abbreviated log)
	74	89	sand and sandy clay			
	89	92	th. grey-brown sandy clay			

Depth(s) Groundwater Encountered 1. \_\_\_\_\_ ft. 2. \_\_\_\_\_ ft. 3. \_\_\_\_\_ ft. 4. \_\_\_\_\_ ft. (Use a second sheet if needed)

INSTRUCTIONS: Use typewriter or ball point pen, please press firmly and PRINT clearly. Please fill in blanks, underline or circle the correct answers. Send top three copies to Kansas Department of Health and Environment, Division of Environment, Water Well Contractors, Topeka, KS 66620. Send one to WATER WELL OWNER and retain one for your records.

BIG BEND GMD#5-KGS  
WATER QUALITY  
OBSERVATION WELL  
NETWORK

SITE NUMBER : 36 (KP11)  
SITE LOCATION: NE NE NW

LEGAL LOCATION: 6-27-12W  
COUNTY : PRATT

WELL LOG

FROM	TO	LITHOLOGIC LOG	OWNER: BRIGGEMANN/McFADDEN
0	7	light brown sandy loam, little clay	
7	18	light brown sandy clay with minor streaks of fine to medium sand	
18	22	fine to medium sand with some clay streaks	
22	28	light reddish-brown clay, little sand, some silt some lime layers	
28	31	light reddish-brown sandy clay, sticky drilling	
31	37	sand interbedded with sandy clay	
37	41	small gravel layers at 37'; continuation of sand interbedded with sandy clay	
41	45	lime layers interbedded with clay, light grey-brown color, slightly sandy	
45	51	light grey-brown sandy clay, small sand layers, increase in sand with depth	
51	72	sand and gravel, fine to coarse grained	
72	74	light red-brown sandy clay	
74	89	sand with some clay streaks and gravel, sand is fine to medium grained	
89	92	light grey-brown sandy clay	
92	112	light grey-brown clay interbedded with lime; clay is sandy but very gummy--slow drilling	
112	113	sand, fine grained	
113	116	light grey-brown sandy clay and limestone	
116	129	sand interbedded with limestone at top, grading into sand and gravel	
129	130	brown clay, very sticky, no sand, little silt	
130	135	sand and gravel	
135	138	sticky clay	
138	149	sand and gravel	
149	152	silty, slightly sandy clay, light brown color	
152	187	sand and gravel	
187	188	reddish clay	
188	190	red shale	
190	195	sand and gravel	
195	215	red shale--PERMIAN	

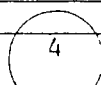

TD=90'  
85'/5'

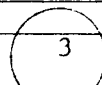

TD=151'  
146'/5'

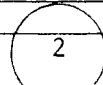

TD=196'  
191'/5'

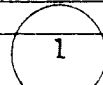

TD=215'  
210'/5'



SITE NUMBER : 36 (KP11)  
SITE LOCATION : NE NE NW  
LEGAL LOCATION: 6-27-12W  
COUNTY : PRATT

LANDOWNER: JAMES MCFADDEN  
ADDRESS :

PHONE NO.:  
TENANT: LORENCE BRIGGEMANN  
RT. 1  
IUKA, KS

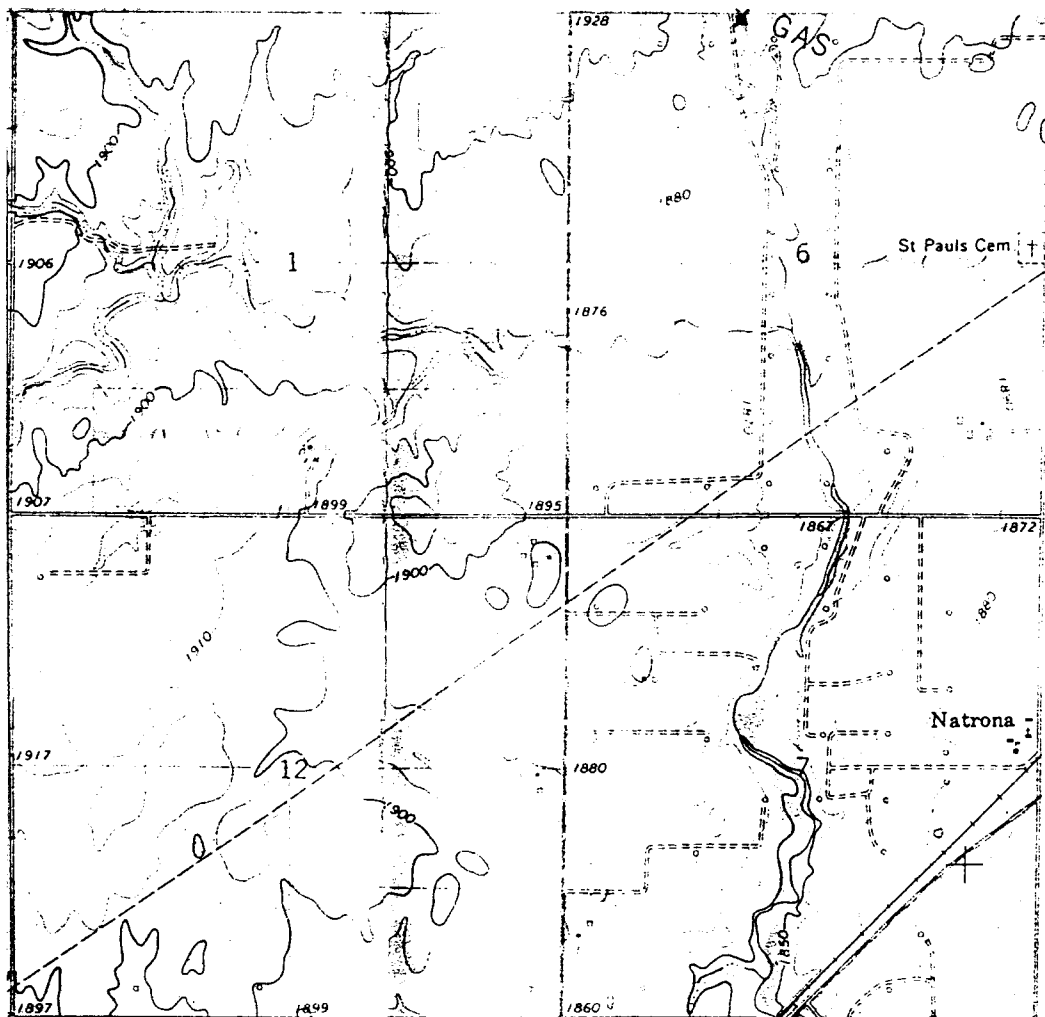

WELL LOCATION ✖

Pratt topo.

