

WATER WELL RECORD

Form WWC-5

Division of Water Resources App. No. []

1 LOCATION OF WATER WELL: County: Pratt, Fraction: 1/4 NW 1/4 SW 1/4 SW 1/4, Section Number: 10, Township No. T 27 S, Range Number R 13 E W

Street/Rural Address of Well Location: 45, Iuka, Global Positioning System (GPS) information: Latitude, Longitude, Elevation, Datum, Collection Method

2 WATER WELL OWNER: A&R Roofing, 281 40100 N PLUS Hwy, Pratt, KS 67214

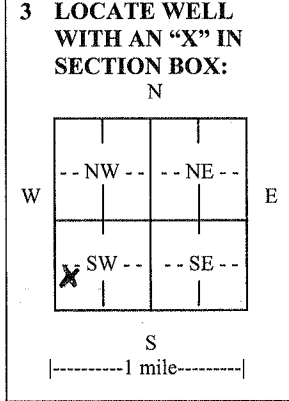

4 DEPTH OF COMPLETED WELL: 132 ft. Depth(s) Groundwater Encountered: 80 ft. WELL'S STATIC WATER LEVEL: 55 ft. below land surface measured on mo/day/yr. 7-30-09

5 TYPE OF CASING USED: Steel, PVC, Other. CASING JOINTS: Glued, Clamped, Welded, Threaded. TYPE OF SCREEN OR PERFORATION MATERIAL: Steel, Stainless Steel, PVC, Brass, Galvanized Steel, None used. SCREEN OR PERFORATION OPENINGS ARE: Continuous slot, Mill slot, Gauze wrapped, Torch cut, Drilled holes, Louvered shutter, Key punched, Wire wrapped, Saw cut, Other. SCREEN-PERFORATED INTERVALS: From 123 ft. to 132 ft. GRAVEL PACK INTERVALS: From 23 ft. to 55 ft., From 60 ft. to 106 ft., From 111 ft. to 132 ft.

6 GROUT MATERIAL: Neat cement, Cement grout, Bentonite, Other. Grout Intervals: From 3 ft. to 23 ft., From 55 ft. to 60 ft., From 106 ft. to 111 ft. What is the nearest source of possible contamination: Septic tank, Lateral lines, Pit privy, Livestock pens, Insecticide storage, Sewer lines, Cesspool, Sewage lagoon, Fuel storage, Abandoned water well, Watertight sewer lines, Seepage pit, Feedyard, Fertilizer storage, Oil well/gas well. Direction from well: N, Distance from well: 100'

Table with columns: FROM, TO, LITHOLOGIC LOG, FROM, TO, LITHO. LOG (cont.) or PLUGGING INTERVALS. Rows include soil, brown clay, fine dirty sand, redish clay, lt brown clay, redish clay, fine sand on clay streaks, fine sand, sand, redish clay.

7 CONTRACTOR'S OR LANDOWNER'S CERTIFICATION: This water well was constructed, reconstructed, or plugged under my jurisdiction and was completed on (mo/day/year) 7-30-09 and this record is true to the best of my knowledge and belief. Kansas Water Well Contractor's License No. 140. This Water Well Record was completed on (mo/day/year) 10-31-11 under the business name of Lyman's Inc. by (signature) []

INSTRUCTIONS: Use typewriter or ball point pen. PLEASE PRESS FIRMLY and PRINT clearly. Please fill in blanks and check the correct answers. Send three copies (white, blue, pink) to Kansas Department of Health and Environment, Bureau of Water, Geology Section, 1000 SW Jackson St., Suite 420, Topeka, Kansas 66612-1367. Telephone 785-296-5522. Send one copy to WATER WELL OWNER and retain one for your records. Include fee of \$5.00 for each constructed well. Visit us at http://www.kdheks.gov/waterwell/index.html.