

WATER WELL PLUGGING RECORD Form WWC-5P KSA 82a-1212 ID NO.

1 LOCATION OF WATER WELL: County: <u>Pratt</u>	Fraction <u>¼ SE ¼ SE ¼ SW ¼</u>	Section Number <u>34</u>	Township Number <u>T 27 S</u>	Range Number <u>13</u> <input type="checkbox"/> E <input checked="" type="checkbox"/> W
--	-------------------------------------	-----------------------------	----------------------------------	--

Street/Rural Address of Well Location; if unknown, distance & direction from nearest town or intersection: If at owner's address, check here <input type="checkbox"/> <u>516 E. First Street, Pratt</u>	Global Positioning Systems (GPS) information: Latitude: _____ (in decimal degrees) Longitude: _____ (in decimal degrees) Elevation: _____ Datum: <input type="checkbox"/> WGS84, <input type="checkbox"/> NAD83, <input type="checkbox"/> NAD27 Collection Method: <input type="checkbox"/> GPS unit (Make/Model: _____) <input type="checkbox"/> Digital Map/Photo, <input type="checkbox"/> Topographic Map, <input type="checkbox"/> Land Survey Est. Accuracy: <input type="checkbox"/> < 3 m, <input type="checkbox"/> 3-5 m, <input type="checkbox"/> 5-15 m, <input type="checkbox"/> > 15 m
--	--

2 WATER WELL OWNER: Tucker Oil Co., Inc.
 RR#, St. Address, Box #: Box 421
 City, State ZIP Code: Kingman, KS 67068

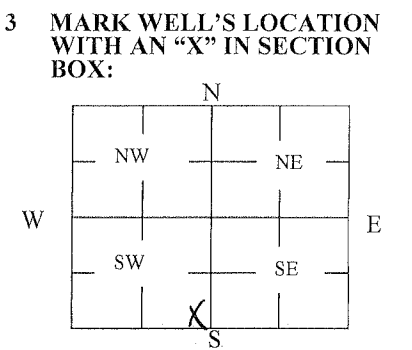

4 DEPTH OF WELL 56.3 ft.
WELL'S STATIC WATER LEVEL 43.51 ft.
WELL WAS USED AS:
 Domestic Public Water Supply Dewatering
 Irrigation Oil Field Water Supply Monitoring
 Feedlot Domestic (Lawn & Garden) Injection Well
 Industrial Air Conditioning Other Air inject.

Was a chemical/bacteriological sample submitted to Department? Yes No

5 TYPE OF BLANK CASING USED:

Steel RMP (SR) Wrought Fiberglass Other (Specify below) _____
 PVC ABS Asbestos-Cement Concrete Tile

Blank casing diameter 1 in. Was casing pulled? Yes No If yes, how much 3'
 Casing height above or below land surface Flush in.

6 GROUT PLUG MATERIAL: Neat cement Cement grout Bentonite Other Concrete

Grout Plug Intervals: From 0 ft. to 0.5 ft., From 3 ft. to 56.3 ft., From _____ to _____ ft.

What is the nearest source of possible contamination:
 Septic tank Seepage pit Fuel Storage Other (specify below) _____
 Sewer lines Pit privy Fertilizer storage
 Watertight sewer lines Sewage lagoon Insecticide storage
 Lateral lines Feedyard Abandoned water well Direction from well? _____
 Cess pool Livestock pens Oil well/Gas well How many feet? _____

FROM	TO	PLUGGING MATERIALS	FROM	TO	PLUGGING MATERIALS
0	0.5	Concrete			
0.5	3	Soil			
3	56.3	Bentonite			Al-4

7 CONTRACTOR'S OR LANDOWNER'S CERTIFICATION: This water well was plugged under my jurisdiction and was completed on (mo/day/year) 3/22/2012 and this record is true to the best of my knowledge and belief. Kansas Water Well Contractor's License No. 527. This Water Well Record was completed on (mo/day/year) 3/23/2012 under the business name of GeoCore Inc. by (signature) *Don [Signature]*

INSTRUCTIONS: Use typewriter or ballpoint pen. Please press firmly and print clearly. Please fill in blanks, underline or circle the correct answers. Send top three copies to Kansas Department of Health and Environment, Bureau of Water, Geology Section, 1000 SW Jackson St., Ste. 420, Topeka, Kansas 66612-1367. Telephone: 785/296-5524. Send one to Water Well Owner and retain one for your records. Visit us at <http://www.kdheks.gov/waterwell/index.html>.