

WATER WELL PLUGGING RECORD Form WWC-5P KSA 82a-1212 ID NO.

20140577

1 LOCATION OF WATER WELL: Fraction 1/4 NW 1/4 NW 1/4 NE 1/4 Section Number 29 Township Number T 27 S Range Number 18 E W
 County: Kiowa

Street/Rural Address of Well Location; if unknown, distance & direction from nearest town or intersection: If at owner's address, check here 3 N, 1/2 W of Greensburg, KS

Global Positioning Systems (GPS) information:
 Latitude: _____ (in decimal degrees)
 Longitude: _____ (in decimal degrees)
 Elevation: _____
 Datum: WGS84, NAD83, NAD27
Collection Method:
 GPS unit (Make/Model: _____)
 Digital Map/Photo, Topographic Map, Land Survey
 Est. Accuracy: < 3 m, 3-5 m, 5-15 m, > 15 m

2 WATER WELL OWNER: John Rosenberger
 RR#, St. Address, Box #: 1524 Eastland Pl.
 City, State ZIP Code: Pratt, KS 67124-3138

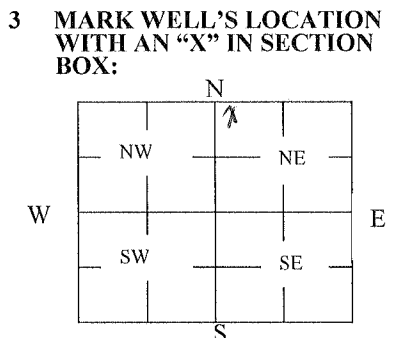

4 DEPTH OF WELL 116 ft.
 WELL'S STATIC WATER LEVEL 55 ft.
 WELL WAS USED AS:
 Domestic Public Water Supply Dewatering
 Irrigation Oil Field Water Supply Monitoring
 Feedlot Domestic (Lawn & Garden) Injection Well
 Industrial Air Conditioning Other _____
 Was a chemical/bacteriological sample submitted to Department? Yes No

5 TYPE OF BLANK CASING USED:
 Steel RMP (SR) Wrought Fiberglass Other (Specify below) _____
 PVC ABS Asbestos-Cement Concrete Tile
 Blank casing diameter 5 in. Was casing pulled? Yes No If yes, how much _____
 Casing height above or below land surface 3 ft. below in.

6 GROUT PLUG MATERIAL: Neat cement Cement grout Bentonite Other _____
 Grout Plug Intervals: From 3 ft. to 55 ft., From _____ ft. to _____ ft., From _____ to _____ ft.
 What is the nearest source of possible contamination:
 Septic tank Seepage pit Fuel Storage Other (specify below) _____
 Sewer lines Pit privy Fertilizer storage _____
 Watertight sewer lines Sewage lagoon Insecticide storage _____
 Lateral lines Feedyard Abandoned water well Direction from well? North
 Cess pool Livestock pens Oil well/Gas well How many feet? 125

FROM	TO	PLUGGING MATERIALS	FROM	TO	PLUGGING MATERIALS
116	55	gravel			
55	3	bentonite			Rosenberger 3-29
3	0	top soil			
					Sterling Drilling Company
					P O Box 1006
					Pratt, KS 67124

7 CONTRACTOR'S OR LANDOWNER'S CERTIFICATION: This water well was plugged under my jurisdiction and was completed on (mo/day/year) 11/19/14 and this record is true to the best of my knowledge and belief. Kansas Water Well Contractor's License No. 186. This Water Well Record was completed on (mo/day/year) 11/22/14 under the business name of Kelly's Water Well Service, Inc. by (signature) Kathryn J. Good

INSTRUCTIONS: Use typewriter or ballpoint pen. Please press firmly and print clearly. Please fill in blanks, underline or circle the correct answers. Send one copy to Kansas Department of Health and Environment, Bureau of Water, Geology Section, 1000 SW Jackson St., Ste. 420, Topeka, Kansas 66612-1367. Telephone: 785/296-5524. Send one to Water Well Owner and retain one for your records. Visit us at <http://www.kdheks.gov/waterwell/index.html>.