

WATER WELL PLUGGING RECORD Form WWC-5P

KSA 82a-1212 ID NO.

1 **LOCATION OF WATER WELL:** Fraction SE 1/4 SE 1/4 SE 1/4 NE 1/4 Section Number 14 Township Number T 27 S Range Number 25 E W
 County: FORD

Street/Rural Address of Well Location; if unknown, distance & direction from nearest town or intersection: If at owner's address, check here
Global Positioning Systems (GPS) information:
 Latitude: N. 37.699437 (in decimal degrees)
 Longitude: W. 100.016181 (in decimal degrees)
 Elevation: _____
 Datum: WGS84, NAD83, NAD27
 Collection Method: _____
 GPS unit (Make/Model: _____)
 Digital Map/Photo, Topographic Map, Land Survey
 Est. Accuracy: < 3 m, 3-5 m, 5-15 m, > 15 m

2 **WATER WELL OWNER:** Bob Johnston
 RR#, St. Address, Box #: 1447 Hwy 293
 City, State ZIP Code: Dodge City KS 67801

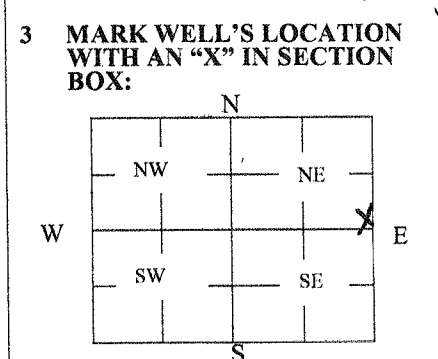

4 **DEPTH OF WELL** 126 ft.
 WELL'S STATIC WATER LEVEL 121 ft.
 WELL WAS USED AS:
 Domestic Public Water Supply Dewatering
 Irrigation Oil Field Water Supply Monitoring
 Feedlot Domestic (Lawn & Garden) Injection Well
 Industrial Air Conditioning Other _____
 Was a chemical/bacteriological sample submitted to Department? Yes No

5 **TYPE OF BLANK CASING USED:**
 Steel RMP (SR) Wrought Fiberglass Other (Specify below)
 PVC ABS Asbestos-Cement Concrete Tile
 Blank casing diameter 5 in. Was casing pulled? Yes No If yes, how much _____
 Casing height above or below land surface 72 in.

6 **GROUT PLUG MATERIAL:** Neat cement Cement grout Bentonite Other _____
 Grout Plug Intervals: From 0 ft. to 5 ft., From 116 ft. to 121 ft., From _____ ft. to _____ ft.
 What is the nearest source of possible contamination:
 Septic tank Seepage pit Fuel storage Other (specify below) _____
 Sewer lines Pit privy Fertilizer storage _____
 Watertight sewer lines Sewage lagoon Insecticide storage _____
 Lateral lines Feedyard Abandoned water well Oil well/Gas well
 Cess pool Livestock pens
 Direction from well? West
 How many feet? 300'

FROM	TO	PLUGGING MATERIALS	FROM	TO	PLUGGING MATERIALS
0	5	Bentonite Grout			
5	116	Clean Fill Sand			
116	121	Bentonite Grout			
121	126	Clean Fill Sand			

7 **CONTRACTOR'S OR LANDOWNER'S CERTIFICATION:** This water well was plugged under my jurisdiction and was completed on (mo/day/year) 9-24-2015 and this record is true to the best of my knowledge and belief. Kansas Water Well Contractor's License No. 846. This Water Well Record was completed on (mo/day/year) 9-24-2015 under the business name of Nash Water Well Service, LLC by (signature) Rebecca L. Nash

INSTRUCTIONS: Use typewriter or ballpoint pen. Please press firmly and print clearly. Please fill in blanks, underline or circle the correct answers. Send top three copies to Kansas Department of Health and Environment, Bureau of Water, Geology Section, 1000 SW Jackson St., Ste. 420, Topeka, Kansas 66612-1367. Telephone: 785/296-5524. Send one to Water Well Owner and retain one for your records. Visit us at <http://www.kdheks.gov/waterwell/index.html>.