

USE TYPEWRITER OR BALL POINT PEN-PRESS FIRMLY, PRINT CLEARLY.

WATER WELL RECORD KSA 82a-1201-1215

Kansas State Dept. Of Health (Water Well Contractors) Forbes-Bldg. 740 Topeka, Kansas 66620

1 Location of well: County FORD Township name RICHLAND Fraction NW 1/4 S.E. 1/4 Section number #12 Town number T #27 S Range number R #26 W

Distance and direction from nearest town or city: 3 Miles SW of Dodge City, Ks. on Highway 56 Street address of well location if in city:

3 Owner of well: BROCE CONSTRUCTION Address: DODGE CITY, KANSAS 67801

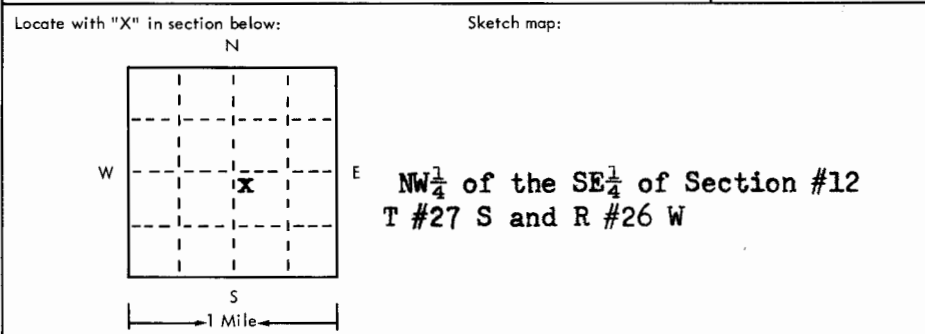

4 Well depth: 153 ft. Date of completion 2-26-75 Well diameter 8 in.

5 Cable tool Rotary Driven Dug Hollow rod Jetted Bored Reverse rotary

6 Use: Domestic Public supply Industry Irrigation Air conditioning Commercial Test well

7 Casing: Material RMP Height: above 12 in. Threaded Welded Surface 12 in. Diam. 5 in. Weight lbs./ft. 5 in. to 153 ft. depth Drive shoe? Yes No

Table with columns: 2 Type and color of material, From, To. Rows include Top Soil and Fine Sand, Fine Sand, Fine Sand & Clay, Clay, Clay & Medium Sand, Medium to Coarse Sand, Medium Sand, Coarse Sand, Coarse Sand & Clay, Clay.

8 Screen: Manufacturer Jess & Lowell Type RMP Dia. 5 in. Slot gauge 1/8 in Length 20 ft. Set between 150 ft. and 153 ft. Fittings: Gravel pack Yes No Size range of material 1/2 in

9 Static water level: 94 ft. below land surface Date 2-26-75

10 Pumping level below land surfaces: Estimated maximum yield g.p.m.

11 Water sample submitted: Yes No Date

12 Well head completion: None Pitless adapter Inches above grade

13 Well grouted? Neat cement Bentonite Depth: From 5 ft. to 15 ft.

14 Nearest source of possible contamination: In middle of field None ft. Direction Type Well disinfected upon completion? Yes No

15 Pump: Windmill Not installed Manufacturer's name Model number HP Volts Length of drop pipe ft. capacity g.m.p. Type: Submersible Turbine Jet Reciprocating Centrifugal Other

16 Remarks: elevation On slope with good drainage, away from the well. To the West. Topography: Hill Slope Upland Valley

17 Water well contractor's certification: This well was drilled under my jurisdiction and this report is true to the best of my knowledge and belief. JOE'S WELL SERVICE 179 Business name License No. Address Box 174 CIMARRON, KS. Signed Larry Crick Date 3-6-75 Authorized representative