

WATER WELL RECORD Form WWC-5

Original Record Correction Change in Well Use

Division of Water Resources App. No.

Well ID

1 LOCATION OF WATER WELL: County: Fraction Section Number Township Number Range Number

2 WELL OWNER: Last Name: Business: Address: City: State: ZIP: Street or Rural Address where well is located

3 LOCATE WELL WITH 'X' IN SECTION BOX: 4 DEPTH OF COMPLETED WELL: 5 Latitude: Longitude: Datum: Source for Latitude/Longitude: 6 Elevation: Source:

7 WELL WATER TO BE USED AS: 1. Domestic: 2. Irrigation: 3. Feedlot: 4. Industrial: 5. Public Water Supply: 6. Dewatering: 7. Aquifer Recharge: 8. Monitoring: 9. Environmental Remediation: 10. Oil Field Water Supply: 11. Test Hole: 12. Geothermal: 13. Other

Was a chemical/bacteriological sample submitted to KDHE? Water well disinfected?

8 TYPE OF CASING USED: CASING JOINTS: TYPE OF SCREEN OR PERFORATION MATERIAL: SCREEN OR PERFORATION OPENINGS ARE: SCREEN-PERFORATED INTERVALS: GRAVEL PACK INTERVALS:

9 GROUT MATERIAL: Grout Intervals:

Nearest source of possible contamination: Direction from well? Distance from well?

Table with columns: FROM, TO, LITHOLOGIC LOG, FROM, TO, LITHO. LOG (cont.) or PLUGGING INTERVALS. Includes a Notes section.

11 CONTRACTOR'S OR LANDOWNER'S CERTIFICATION: This water well was constructed, reconstructed, or plugged under my jurisdiction and was completed on (mo-day-year) and this record is true to the best of my knowledge and belief.

LEGEND

- ⊕ Existing Monitor Wells
- ⊕ SSA Monitor Wells

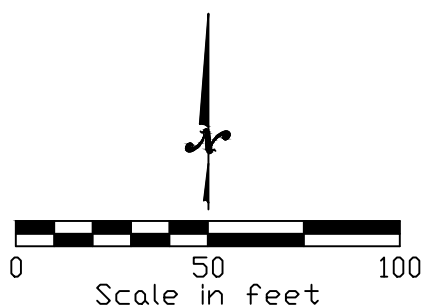
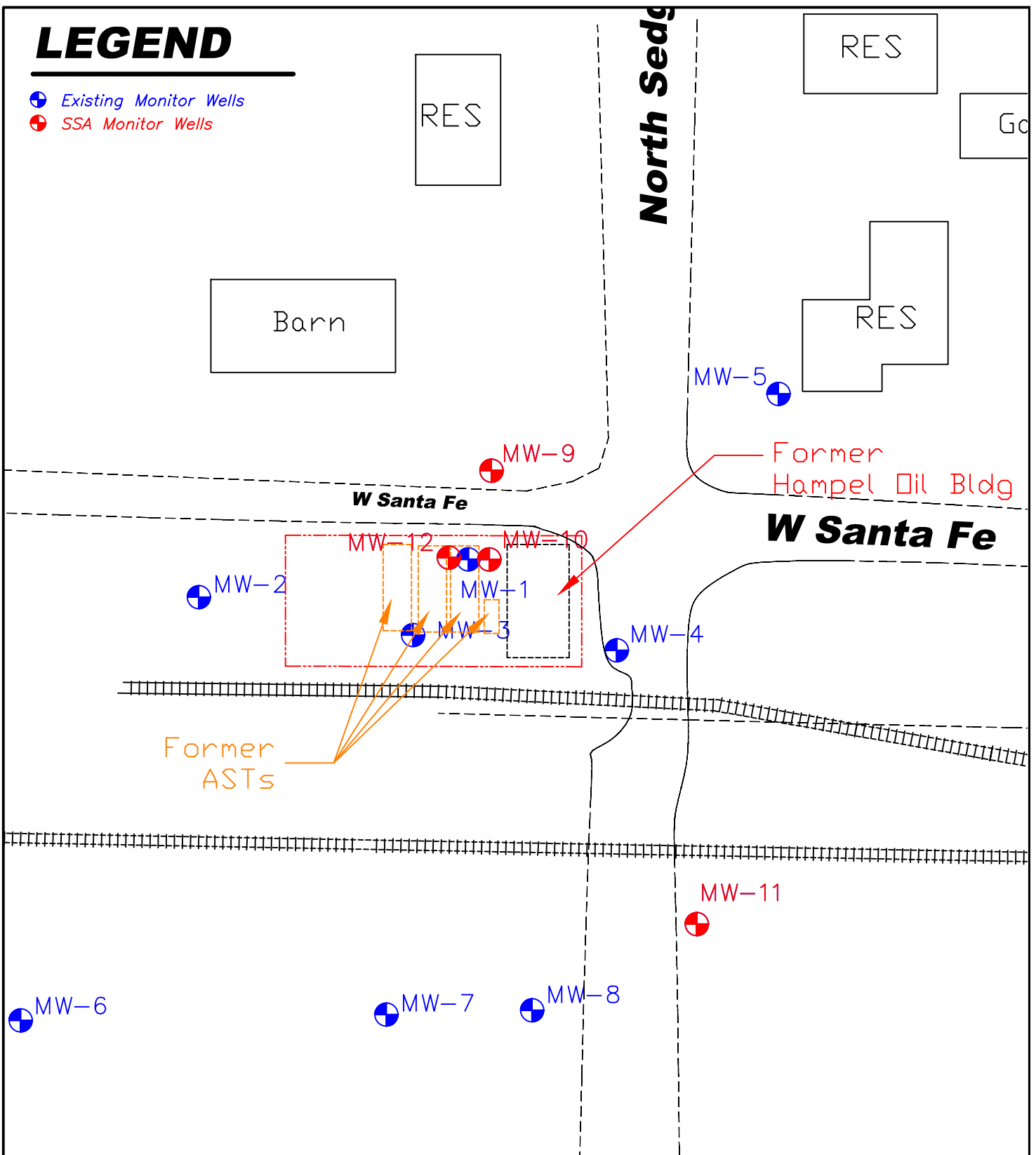

SCS ENGINEERS ENVIRONMENTAL CONSULTANTS AND CONTRACTORS 7311 West 130th Street Overland Park, Kansas 66213			
Figure 1.3 Site Base Map Hampel Oil Distributors West Santa Fe St and North Sedgwick St, Garden Plains			
Project Mgr.	PMG	Date	6/25/18
Scale:		KDHE Code:	A2-087-40307
		File Name	Hampel SSA WP.dwg
		Proj No.	27217311.00