

**WATER WELL RECORD**

**Form WWC-5**

Division of Water Resources App. No.

13,866

<b>1 LOCATION OF WATER WELL:</b> County: Haskell	Fraction ¼ SE ¼ SE ¼ SE ¼	Section Number 24	Township No. T 27 S	Range Number R 31 <input type="checkbox"/> E <input checked="" type="checkbox"/> W
---	------------------------------	----------------------	------------------------	---

Street/Rural Address of Well Location; if unknown, distance & direction from nearest town or intersection: If at owner's address, check here  approx 14.5 miles southeast of Pierceville, KS

**Global Positioning System (GPS) information:**  
 Latitude: 37.67848 (in decimal degrees)  
 Longitude: 100.65301 (in decimal degrees)  
 Elevation: 2826  
 Datum:  WGS 84,  NAD 83,  NAD 27  
 Collection Method:  
 GPS unit (Make/Model: .....)  
 Digital Map/Photo,  Topographic Map,  Land Survey  
 Est. Accuracy:  <3 m,  3-5 m,  5-15 m,  >15 m

**2 WATER WELL OWNER:** Keith Unruh  
 RR#, Street Address, Box #: 21904 2 Road  
 City, State, ZIP Code : Copeland, KS 67837

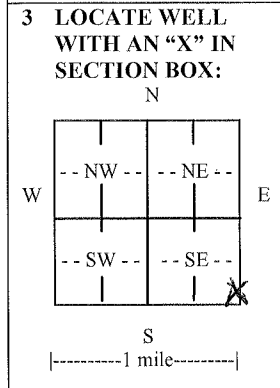

**4 DEPTH OF COMPLETED WELL** 395 ft.  
 Depth(s) Groundwater Encountered (1)..... ft. (2)..... ft. (3)..... ft.  
 WELL'S STATIC WATER LEVEL 242 ft below land surface measured on mo/day/yr. 5/31/11  
 Pump test data: Well water was 276 ft. after 4 hours pumping 713 gpm  
 EST. YIELD..... gpm. Well water was..... ft. after..... hours pumping..... gpm  
 Bore Hole Diameter 24 in. to 395 ft., and..... in. to..... ft.  
 WELL WATER TO BE USED AS:  Public water supply  Geothermal  Injection well  
 Domestic  Feedlot  Oil field water supply  Dewatering  Other (Specify below)  
 Irrigation  Industrial  Domestic-lawn & garden  Monitoring well .....  
 Was a chemical/bacteriological sample submitted to Department?  Yes  No  
 If yes, mo/day/yr sample was submitted.....  
 Water well disinfected?  Yes  No

**5 TYPE OF CASING USED:**  Steel  PVC  Other .....  
 CASING JOINTS:  Glued  Clamped  Welded  Threaded  
 Casing diameter .16 in. to 395 ft., Diameter ..... in. to ..... ft., Diameter ..... in. to ..... ft.  
 Casing height above land surface 12 in., Weight 36.95 lbs./ft., Wall thickness or gauge No. 0.219  
 TYPE OF SCREEN OR PERFORATION MATERIAL:  
 Steel  Stainless Steel  PVC  Other (Specify) .....  
 Brass  Galvanized Steel  None used (open hole)  
 SCREEN OR PERFORATION OPENINGS ARE:  
 Continuous slot  Mill slot  Gauze wrapped  Torch cut  Drilled holes  None (open hole)  
 Louvered shutter  Key punched  Wire wrapped  Saw cut  Other (specify) .....  
 SCREEN-PERFORATED INTERVALS: From 253 ft. to 323 ft., From 340 ft. to 390 ft.  
 From..... ft. to..... ft., From..... ft. to..... ft.  
 GRAVEL PACK INTERVALS: From 20 ft. to 280 ft., From 280 ft. to 395 ft.  
 From..... ft. to..... ft., From..... ft. to..... ft.

**6 GROUT MATERIAL:**  Neat cement  Cement grout  Bentonite  Other .....  
 Grout Intervals: From 0 ft. to 20 ft., From..... ft. to..... ft., From..... ft. to..... ft.  
 What is the nearest source of possible contamination:  
 Septic tank  Lateral lines  Pit privy  Livestock pens  Insecticide storage  Other (specify below)  
 Sewer lines  Cesspool  Sewage lagoon  Fuel storage  Abandoned water well  
 Watertight sewer lines  Seepage pit  Feedyard  Fertilizer storage  Oil well/gas well  None Detected  
 Direction from well ..... Distance from well .....

FROM	TO	LITHOLOGIC LOG	FROM	TO	LITHO. LOG (cont.) or PLUGGING INTERVALS
0	2	top soil	341	360	sand fine-med coarse w/ brown rock
2	24	brown sandy clay	360	370	sandstone
24	64	fine sand w/ few clay stringers	370	377	soapstone
64	75	brown sandy clay	377	390	sandstone w/ few soapstone
75	269	snd fne-med crse, sm med large grvl	390	395	soapstone & shale ledges
269	279	snd fn-md crs sm md grvl w/ cly ldg			
279	290	brown clay			
290	297	fine sand w/ couple clay ledges			
297	323	bwn sdy cly & few sd stps & sd bed			
323	341	brown sandy clay			

**7 CONTRACTOR'S OR LANDOWNER'S CERTIFICATION:** This water well was  constructed,  reconstructed, or  plugged under my jurisdiction and was completed on (mo/day/year) 5/31/11 and this record is true to the best of my knowledge and belief. Kansas Water Well Contractor's License No. 145. This Water Well Record was completed on (mo/day/year) 6/23/11 under the business name of Hydro Resources by (signature) *[Signature]*

**INSTRUCTIONS:** Use typewriter or ball point pen. PLEASE PRESS FIRMLY and PRINT clearly. Please fill in blanks and check the correct answers. Send three copies (white, blue, pink) to Kansas Department of Health and Environment, Bureau of Water, Geology Section, 1000 SW Jackson St., Suite 420, Topeka, Kansas 66612-1367. Telephone 785-296-5522. Send one copy to WATER WELL OWNER and retain one for your records. Include fee of \$5.00 for each constructed well. Visit us at <http://www.kdheks.gov/waterwell/index.html>.