

WATER WELL RECORD

Form WWC-5

Division of Water Resources App. No.

25,763

1 LOCATION OF WATER WELL: County: HASKELL Fraction 1/4 1/4 Near Center 1/4 SW 1/4 Section Number 26 Township No. T 27 S Range Number R 33 [] E [x] W

Street/Rural Address of Well Location; if unknown, distance & direction from nearest town or intersection: If at owner's address, check here [] SUBLETTE-1 MILE SW TO 83-56 JCT, 13 MILES NORTH, 1 MILE WEST, 1235' NORTH & 3960' WEST

2 WATER WELL OWNER: OLIVER R. & MARILYN BATMAN RR#, Street Address, Box #: 3224 - 26TH ST. City, State, ZIP Code : GREAT BEND, KANSAS 67530

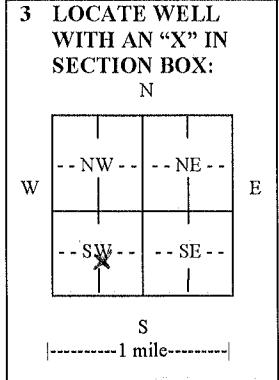

4 DEPTH OF COMPLETED WELL 450 ft. Depth(s) Groundwater Encountered (1)..... ft. (2)..... ft. (3)..... ft. WELL'S STATIC WATER LEVEL..... ft. below land surface measured on mo/day/yr..... Pump test data: Well water was.....ft. after..... hours pumping..... gpm EST. YIELD.....gpm. Well water was.....ft. after..... hours pumping..... gpm Bore Hole Diameter .30..... in. to .450..... ft., and..... in. to..... ft. WELL WATER TO BE USED AS: [] Public water supply [] Geothermal [] Injection well [] Domestic [] Feedlot [] Oil field water supply [] Dewatering [] Other (Specify below) [x] Irrigation [] Industrial [] Domestic-lawn & garden [] Monitoring well Was a chemical/bacteriological sample submitted to Department? [] Yes [x] No If yes, mo/day/yr sample was submitted..... Water well disinfected? [] Yes [x] No

5 TYPE OF CASING USED: [x] Steel [] PVC [] Other CASING JOINTS: [] Glued [] Clamped [x] Welded [] Threaded Casing diameter .16..... in. to .360..... ft., Diameter..... in. to..... ft., Diameter..... in. to..... ft. Casing height above land surface.....12..... in., Weight 42.05.....lbs./ft., Wall thickness or gauge No.250..... TYPE OF SCREEN OR PERFORATION MATERIAL: [x] Steel [] Stainless Steel [] PVC [] Brass [] Galvanized Steel [] None used (open hole) [] Other (Specify) SCREEN OR PERFORATION OPENINGS ARE: [] Continuous slot [x] Mill slot [] Gauze wrapped [] Torch cut [] Drilled holes [] None (open hole) [] Louvered shutter [] Key punched [x] Wire wrapped [] Saw cut [] Other (specify) SCREEN-PERFORATED INTERVALS: From...360..... ft. to ...450..... ft., From..... ft. to..... ft. From..... ft. to..... ft., From..... ft. to..... ft. GRAVEL PACK INTERVALS: From...20..... ft. to ...285..... ft., From...345..... ft. to ...450..... ft. From..... ft. to..... ft., From..... ft. to..... ft.

6 GROUT MATERIAL: [] Neat cement [x] Cement grout [] Bentonite [] Other Grout Intervals: From 0..... ft. to 20..... ft., From 285..... ft. to 345..... ft., From..... ft. to..... ft. What is the nearest source of possible contamination: [] Septic tank [] Lateral lines [] Pit privy [] Livestock pens [] Insecticide storage [] Other (specify below) [] Sewer lines [] Cesspool [] Sewage lagoon [] Fuel storage [] Abandoned water well [] Watertight sewer lines [] Seepage pit [] Feedyard [] Fertilizer storage [] Oil well/gas well N/A Direction from well..... Distance from well.....

Table with 6 columns: FROM, TO, LITHOLOGIC LOG, FROM, TO, LITHO. LOG (cont.) or PLUGGING INTERVALS. Row 1 contains 'SEE ATTACHED LOG'.

7 CONTRACTOR'S OR LANDOWNER'S CERTIFICATION: This water well was [x] constructed, [] reconstructed, or [] plugged under my jurisdiction and was completed on (mo/day/year) 6-15-11..... and this record is true to the best of my knowledge and belief. Kansas Water Well Contractor's License No. 208..... This Water Well Record was completed on (mo/day/year) 6-22-11..... under the business name of MINTER-WILSON DRILLING CO., INC..... by (signature) Nora Keller.....

INSTRUCTIONS: Use typewriter or ball point pen. PLEASE PRESS FIRMLY and PRINT clearly. Please fill in blanks and check the correct answers. Send three copies (white, blue, pink) to Kansas Department of Health and Environment, Bureau of Water, Geology Section, 1000 SW Jackson St., Suite 420, Topeka, Kansas 66612-1367. Telephone 785-296-5522. Send one copy to WATER WELL OWNER and retain one for your records. Include fee of \$5.00 for each constructed well. Visit us at http://www.kdheks.gov/waterwell/index.html.

*The
Professionals*

MINTER-WILSON DRILLING CO.

INCORPORATED

Irrigation
and Domestic
Water Systems
Complete Installation
and Repairing

Phone 620-276-8269 • P.O. Box A • GARDEN CITY, KANSAS 67846

NAME OLIVER BATMAN
TENANT - ANDY KOEHN
COUNTY HASKELL
DATE 5-4-11

LOCATION: SW 1/4 26-27-33 - SOUTH OF GARDEN CITY TO HITCH ROAD -
1-1/2 MILES WEST, 3/4 OF A MILE SOUTH
& 1/4 OF A MILE WEST
- 100 FT. SOUTH OF PIVOT

STATIC WATER LEVEL - APPROX. 320 FT.

TEST # 2

0' TO 2' - TOP SOIL
2' TO 13' - BROWN SANDY CLAY
13' TO 98' - BROWN CLAY
98' TO 180' - FINE TO MEDIUM SAND & GRAVEL - SOME COARSE
180' TO 205' - BROWN CLAY WITH SMALL GRAVEL STREAKS
205' TO 240' - BROWN CLAY
240' TO 245' - BROWN CLAY WITH TRACES OF BLUE CLAY
245' TO 263' - BLUE & BROWN CLAY
263' TO 295' - BLUE CLAY
295' TO 323' - BLUE CLAY WITH BLUE FINE TO MEDIUM GRAVEL - 50%
323' TO 357' - BROWN CLAY WITH SMALL STREAKS OF GRAVEL
357' TO 370' - FINE TO MEDIUM SAND & GRAVEL - 10% CLAY
370' TO 385' - FINE TO MEDIUM SAND & GRAVEL
385' TO 400' - FINE TO MEDIUM SAND & GRAVEL - 15% CLAY
400' TO 410' - BROWN CLAY WITH GRAVEL STREAKS
410' TO 427' - FINE TO MEDIUM SAND & GRAVEL
427' TO 474' - BROWN SANDY CLAY
474' TO 532' - BROWN CLAY
532' TO 540' - BROWN YELLOW CLAY - HARD
540' TO 545' - SHALE - HARD PULL DOWN