

County: Haskell Fraction: SE NE NE NE Sec. 2 T 27 S R 33 W

**CORRECTION(S) TO WATER WELL COMPLETION RECORD Form WWC-5 (to rectify lacking or incorrect information)**

Owner: Gene Davis

If location corrected, was listed as:

Location changed to:

Section-Township-Range: 2-27S-33W

2-27S-33W

Fraction (1/4 calls): NE

SE NE NE NE

Other changes: Initial statements: Approx. 16 miles West of Garden City & 1 mile West, approx. 1/4 mile South, then approx. 300' West.

Changed to: From Garden City: 16 mi. S., 1 mi. West, 0.25 mi. S., 300 ft. W.

Comments: \_\_\_\_\_

Verification method: Latitude & longitude, KGS' "LEWEB" conversion tool, written description, and mapping tool & aerial photos on KGS website.

Initials: DRL Date: 7/27/2018

Submitted by:  Kansas Geological Survey, Data Resources Library, 1930 Constant Avenue, Lawrence, KS 66047-3724  
 Kansas Dept. of Health & Environment, Bureau of Water, 1000 SW Jackson, Suite 420, Topeka, KS 66612-1367

**WATER WELL PLUGGING RECORD Form WWC-5P**

KSA 82a-1212

ID NO.

N/A

<b>1 LOCATION OF WATER WELL:</b> County: Haskell	Fraction ¼ ¼ ¼ NE ¼	Section Number 2	Township Number T 27 S	Range Number 33 <input type="checkbox"/> E <input checked="" type="checkbox"/> W
---	------------------------	---------------------	---------------------------	---

Street/Rural Address of Well Location; if unknown, distance & direction from nearest town or intersection: If at owner's address, check here  Approx. 16 miles West of Garden City & 1 mile West, approx. 1/4 mile South, then approx. 300' West

**Global Positioning Systems (GPS) information:**  
 Latitude: 37.73544 N (in decimal degrees)  
 Longitude: 100.88950 W (in decimal degrees)  
 Elevation:  
 Datum:  WGS84,  NAD83,  NAD27  
 Collection Method:  
 GPS unit (Make/Model: Garmin eTrex 10)  
 Digital Map/Photo,  Topographic Map,  Land Survey  
 Est. Accuracy:  < 3 m,  3-5 m,  5-15 m,  > 15 m

**2 WATER WELL OWNER:** Gene Davis  
 RR#, St. Address, Box #: HCR 1 Box 36  
 City, State ZIP Code: Sublette Ks., 67877-9722

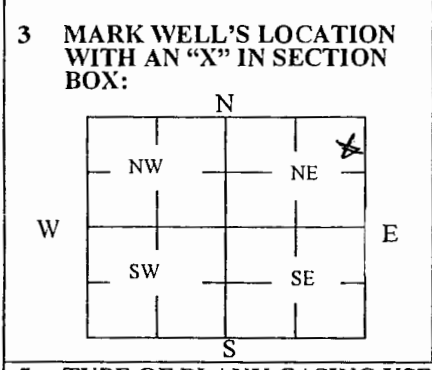

**4 DEPTH OF WELL** 322' ft.  
 WELL'S STATIC WATER LEVEL 308' ft.  
 WELL WAS USED AS:  
 Domestic  Public Water Supply  Dewatering  
 Irrigation  Oil Field Water Supply  Monitoring  
 Feedlot  Domestic (Lawn & Garden)  Injection Well  
 Industrial  Air Conditioning  Other \_\_\_\_\_  
 Was a chemical/bacteriological sample submitted to Department? Yes  No

**5 TYPE OF BLANK CASING USED:**  
 Steel  RMP (SR)  Wrought  Fiberglass  Other (Specify below) \_\_\_\_\_  
 PVC  ABS  Asbestos-Cement  Concrete Tile  
 Blank casing diameter 6" in. Was casing pulled? Yes  No  If yes, how much 60"  
 Casing height above or below land surface 60" Below in.

**6 GROUT PLUG MATERIAL:**  Neat cement  Cement grout  Bentonite  Other \_\_\_\_\_  
 Grout Plug Intervals: From 15' ft. to 5' ft., From \_\_\_\_\_ ft. to \_\_\_\_\_ ft., From \_\_\_\_\_ to \_\_\_\_\_ ft.  
 What is the nearest source of possible contamination:  
 Septic tank  Seepage pit  Fuel Storage  Other (specify below) \_\_\_\_\_  
 Sewer lines  Pit privy  Fertilizer storage  None Observed  
 Watertight sewer lines  Sewage lagoon  Insecticide storage  
 Lateral lines  Feedyard  Abandoned water well Direction from well? \_\_\_\_\_  
 Cess pool  Livestock pens  Oil well/Gas well How many feet? \_\_\_\_\_

FROM	TO	PLUGGING MATERIALS	FROM	TO	PLUGGING MATERIALS
322'	15'	CHLORINATED GRAVEL PACK	15'	5'	3,000 PSI CONCRETE
5'	0'	Cut off casing and Backfilled			

**7 CONTRACTOR'S OR LANDOWNER'S CERTIFICATION:** This water well was plugged under my jurisdiction and was completed on (mo/day/year) 1-9-2018 and this record is true to the best of my knowledge and belief. Kansas Water Well Contractor's License No. 145. This Water Well Record was completed on (mo/day/year) 1-20-2018 under the business name of Hydro Resources Mid Continent by (signature) Gary Clepper

**INSTRUCTIONS:** Use typewriter or ballpoint pen. Please press firmly and print clearly. Please fill in blanks, underline or circle the correct answers. Send top three copies to Kansas Department of Health and Environment, Bureau of Water, Geology Section, 1000 SW Jackson St., Ste. 420, Topeka, Kansas 66612-1367. Telephone: 785/296-5524. Send one to Water Well Owner and retain one for your records. Visit us at <http://www.kdheks.gov/waterwell/index.html>.

Check one:  White Copy  Blue Copy  Pink Copy