

USE TYPEWRITER OR BALL POINT PEN-PRESS FIRMLY, PRINT CLEARLY.

T R EW sec 1/4 1/4 1/4 No.

WATER WELL RECORD  
KSA 82a-1201-1215

Kansas State Dept. Of Health  
(Water Well Contractors)  
Forbes-Bldg. 740  
Topeka, Kansas 66620

1 Location of well:	County <b>Stanton</b>	Township name	Fraction <b>SE<math>\frac{1}{4}</math>, SE<math>\frac{1}{4}</math>, NW<math>\frac{1}{4}</math></b>	Section number <b>17</b>	Town number <b>T27S</b>	Range number <b>R39W</b>
---------------------	--------------------------	---------------	---	-----------------------------	----------------------------	-----------------------------

Distance and direction from nearest town or city: Street address of well location if in city:	<b>8 mi. N., 1<math>\frac{1}{2}</math> mi. W. 1<math>\frac{1}{2}</math> mi. N., <math>\frac{1}{4}</math> mi. W. of <b>Big Bow</b></b>	3 Owner of well: Address:	<b>Don Molz Route 1 Johnson, Kansas 67855</b>
--	---	------------------------------	---

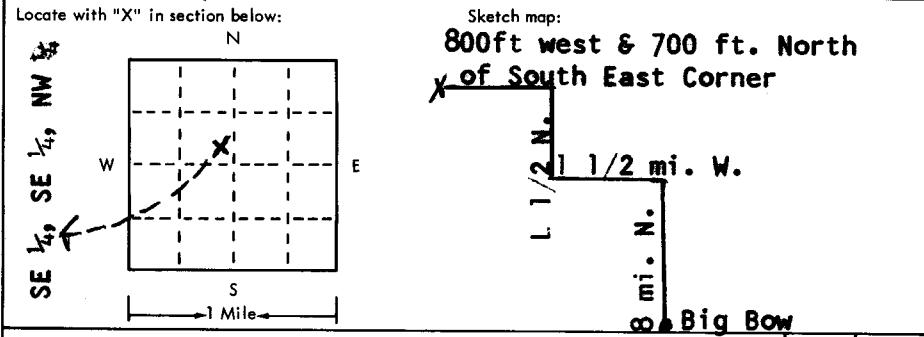

4 Well depth: <b>665</b> ft. Date of completion <b>5-19-75</b> Well diameter <b>26</b> in.
5 <input type="checkbox"/> Cable tool <input type="checkbox"/> Rotary <input type="checkbox"/> Driven <input type="checkbox"/> Dug <input type="checkbox"/> Hollow rod <input type="checkbox"/> Jetted <input type="checkbox"/> Bored <input checked="" type="checkbox"/> Reverse rotary
6 Use: <input type="checkbox"/> Domestic <input type="checkbox"/> Public supply <input type="checkbox"/> Industry <input checked="" type="checkbox"/> Irrigation <input type="checkbox"/> Air conditioning <input type="checkbox"/> Commercial <input type="checkbox"/> Test well <input type="checkbox"/>
7 Casing: Material <b>Steel</b> Height: above/below Threaded <input type="checkbox"/> Welded <input checked="" type="checkbox"/> Surface <b>8 ft.</b> Diam. <b>16</b> in. to <b>665</b> ft. depth Drive shoe? <input type="checkbox"/> Yes <input checked="" type="checkbox"/> No Weight <b>34<math>\frac{1}{2}</math></b> lbs./ft. <input type="checkbox"/> Yes <input checked="" type="checkbox"/> No in. to ___ ft. depth!

2	Type and color of material	From	To
	Surface & fine sand	0	15
	Fine sand	15	60
	Brown clay	60	105
	Blue clay	105	150
	Sand & medium gravel	150	210
	Brown sandy clay	210	240
	Brown sandy clay	240	285
	Sand	285	300
	Sandy clay	300	315
	Sand - loose	315	360
	Sand & sandstone	360	375
	Blue Shale - Streaks of Dakota	375	495
	Dakota - some Cheyenne	495	510
	Dakota	510	540
	Dakota Cheyenne & Sandstone (Loose)	540	665

(use a second sheet if needed)

8 Screen: Manufacturer <b>Johnson</b> Type <b>Galvanized</b> Dia. <b>16 in.</b> Slot/gauge <b>100X100</b> Length <b>50 ft.</b> Set between <b>500</b> ft. and <b>550</b> ft.
* Fittings: <b>See Remarks</b> Gravel pack <input checked="" type="checkbox"/> Yes <input type="checkbox"/> No Size range of material <b>1/2 down</b>
9 Static water level: <b>105</b> ft. below land surface Date <b>5-8-75</b>
10 Pumping level below land surfaces: <b>200</b> ft. after <b>24</b> hrs. pumping <b>1600</b> g.p.m. ___ ft. after ___ hrs. pumping ___ g.p.m. Estimated maximum yield <b>2000</b> g.p.m.
11 Water sample submitted: <input type="checkbox"/> Yes <input checked="" type="checkbox"/> No Date ___
12 Well head completion: <b>96 in. Customer Pan.</b> <input type="checkbox"/> Pitless adapter <input checked="" type="checkbox"/> Inches above grade
13 Well grouted? <input checked="" type="checkbox"/> Yes <input type="checkbox"/> No <input checked="" type="checkbox"/> Neat cement <input type="checkbox"/> Bentonite <input type="checkbox"/> Depth: From <b>0</b> ft. to <b>15</b> ft.
14 Nearest source of possible contamination: ft. ___ Direction <b>none</b> Type ___ Well disinfected upon completion? <input type="checkbox"/> Yes <input checked="" type="checkbox"/> No
15 Pump: <input type="checkbox"/> Not installed Manufacturer's name <b>Goulds</b> Model number <b>14 J</b> HP <b>150</b> Volts ___ Length of drop pipe <b>320</b> ft. capacity <b>600</b> g.m.p. Type: <input type="checkbox"/> Submersible <input checked="" type="checkbox"/> Turbine <input type="checkbox"/> Jet <input type="checkbox"/> Reciprocating <input type="checkbox"/> Centrifugal <input type="checkbox"/> Other

16 Remarks: elevation Topography: <input type="checkbox"/> Hill <input checked="" type="checkbox"/> Slope <input type="checkbox"/> Upland <input type="checkbox"/> Valley	<b>Drilling Sub-contracted to Minter-Wilson Drilling Co. Garden City, Kansas Lakewood Perf. - Slot - .125 X 66 Set between 180 ft. &amp; 500 ft. and 550 ft &amp; 665 ft.</b>	<b>License No. 208</b>
--	---	----------------------------

17 Water well contractor's certification: This well was drilled under my jurisdiction and this report is true to the best of my knowledge and belief. <b>K. I. Drilling Co. 263</b> Business name License No. Address <b>Box 669 Ulysses Kan.</b> Signed <b>Bob Fisher</b> Date <b>6-18-75</b> Authorized representative
--