

USE TYPEWRITER OR BALL POINT PEN-PRESS FIRMLY, PRINT CLEARLY.

T R EW sec 1/4 1/4 1/4 No.

WATER WELL RECORD
KSA 82a-1201-1215

Kansas State Dept. Of Health
(Water Well Contractors)
Forbes-Bldg. 740
Topeka, Kansas 66620

1 Location of well:	County Stanton	Township name	Fraction SW 1/4 NW 1/4	Section number 26	Town number T27S	Range number R39N
---------------------	--------------------------	---------------	----------------------------------	-----------------------------	----------------------------	-----------------------------

Distance and direction from nearest town or city: 7 3/4 mi. North of Big Bow. on east side of road. Street address of well location if in city:	3 Owner of well: Don Molz Address: Route 1 Johnson, Kansas 67855
--	---

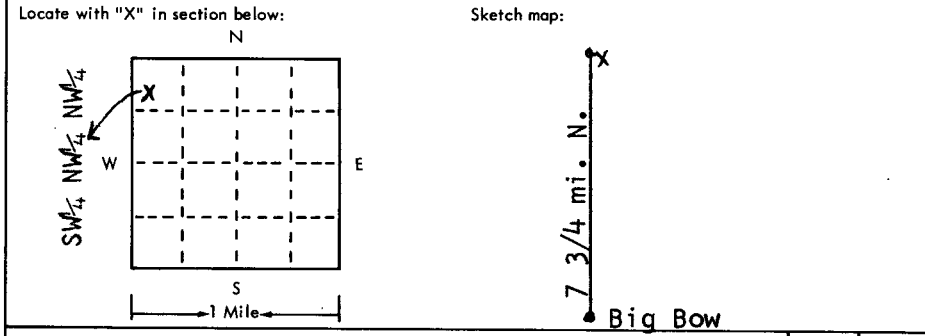

4 Well depth: 680 ft. Date of completion 3-28-75 Well diameter 26 in.
5 <input type="checkbox"/> Cable tool <input type="checkbox"/> Rotary <input type="checkbox"/> Driven <input type="checkbox"/> Dug <input type="checkbox"/> Hollow rod <input type="checkbox"/> Jetted <input type="checkbox"/> Bored <input checked="" type="checkbox"/> Reverse rotary
6 Use: <input type="checkbox"/> Domestic <input type="checkbox"/> Public supply <input type="checkbox"/> Industry <input checked="" type="checkbox"/> Irrigation <input type="checkbox"/> Air conditioning <input type="checkbox"/> Commercial <input type="checkbox"/> Test well <input type="checkbox"/>
7 Casing: Material Steel Height: above/below Threaded <input type="checkbox"/> Welded <input checked="" type="checkbox"/> Surface 12 in. Diam. Weight 34 1/2 lbs./ft. 16 in. to 680 ft. depth Drive shoe? <input type="checkbox"/> Yes <input checked="" type="checkbox"/> No in. to ___ ft. depth!

2 Type and color of material	From	To
2' Surface & 13' Clay	0	15
Sandy Clay, Brown Clay & Fine Sand	15	90
Fine to Coarse Sand	90	103
Blue & Brown Clay with 9' Layer of Sand	103	165
Clay & Fine Sand, Coarse Sand with Strips Clay	165	250
Coarse Sand with Cemented Strips	250	260
Clay with Strips of Fine to Med. Sand - (27')	260	360
Kiowa & Blue Shale with 5' Sandstone	360	432
Blue Shale & Dakota - Approx. 10%	432	550
Cheyenne & Shale	550	560
Cheyenne	560	590
Tight Shale	590	594
Cheyenne - Loose	594	640
Cheyenne & Shale	640	680
(use a second sheet if needed)		

8 Screen: Manufacturer Johnson Type Galvanized Dia. 16" Slot/groove 100X100 Length 50' Set between 320 ft. and 340 ft. 50lb per Ft. *Fittings: 600' to 630' Gravel pack <input checked="" type="checkbox"/> Yes <input type="checkbox"/> No Size range of material 1/2 down
9 Static water level: 165 ft. below land surface Date 3-29-75
10 Pumping level below land surfaces: 330 ft. after 6 hrs. pumping 1000 g.p.m. ___ ft. after ___ hrs. pumping ___ g.p.m. Estimated maximum yield 1000 g.p.m.
11 Water sample submitted: <input type="checkbox"/> Yes <input checked="" type="checkbox"/> No Date ___
12 Well head completion: 12" <input type="checkbox"/> Pitless adapter <input checked="" type="checkbox"/> Inches above grade
13 Well grouted? <input checked="" type="checkbox"/> Yes <input type="checkbox"/> No *Customer ran <input checked="" type="checkbox"/> Neat cement <input type="checkbox"/> Bentonite <input type="checkbox"/> foundation Depth: From 0 ft. to 10 ft.
14 Nearest source of possible contamination: in field ft. ___ Direction none Type ___ Well disinfected upon completion? <input type="checkbox"/> Yes <input checked="" type="checkbox"/> No
15 Pump: <input type="checkbox"/> Not installed Manufacturer's name Goulds Model number 12J HP 150 Volts ___ Length of drop pipe 500 ft. capacity 1000 g.m.p. Type: <input type="checkbox"/> Submersible <input checked="" type="checkbox"/> Turbine <input type="checkbox"/> Jet <input type="checkbox"/> Reciprocating <input type="checkbox"/> Centrifugal <input type="checkbox"/> Other

16 Remarks: elevation

**Drilling Sub-contracted to:
Minter-Wilson Drilling Co. License #208
Garden City, Kansas 67846**

*** Lakewood - Perf. - Slot - .125 X 66
Set between 340' & 600' and
" 630' & 680'**

Topography:
 Hill
 Slope
 Upland
 Valley

17 Water well contractor's certification:
This well was drilled under my jurisdiction and this report is true to the best of my knowledge and belief.

K. I. Drilling Co. 263
Business name License No.
Address **Box 669, Ullysses, Kan.**
Signed **Bob Fisher** Date **4-21-75**
Authorized representative