

-revised-

WATER WELL RECORD Form WWC-5

Division of Water Resources App. No.

[]

Well ID

MW6

Original Record Correction Change in Well Use

1 LOCATION OF WATER WELL: County: KINGMAN Fraction SE 1/4 SE 1/4 SE 1/4 SE 1/4 Section Number 32 Township Number T 27 S Range Number R 7 E W

2 WELL OWNER: Last Name: Business: WHITE'S KINGCO, INC. Address: 858 E. D AVE City: KINGMAN State: KS ZIP: 67068 Street or Rural Address where well is located

3 LOCATE WELL WITH 'X' IN SECTION BOX: [Diagram showing a 2x2 grid with NW, NE, SW, SE quadrants and an 'X' in the SE quadrant]

4 DEPTH OF COMPLETED WELL: 15 ft. Depth(s) Groundwater Encountered: 1) 15 ft. 2) ... ft. 3) ... ft. or 4) Dry Well WELL'S STATIC WATER LEVEL: 3.12 ft. below land surface, measured on (mo-day-yr) 3/24/22

5 Latitude: 37.64685 Longitude: 98.10028 Horizontal Datum: WGS 84 Source for Latitude/Longitude: Land Survey Topographic Map Online Mapper

6 Elevation: 1530.11 ft. Source: Land Survey GPS Topographic Map Other

7 WELL WATER TO BE USED AS: 1. Domestic: Household Lawn & Garden Livestock Irrigation Feedlot Industrial 2. Public Water Supply: well ID MW6 3. Environmental Remediation: well ID Air Sparge Soil Vapor Extraction Recovery Injection 4. Oil Field Water Supply: lease 5. Test Hole: well ID Cased Uncased Geotechnical 6. Geothermal: how many bores? a) Closed Loop Horizontal Vertical b) Open Loop Surface Discharge Inj. of Water 7. Other (specify):

Was a chemical/bacteriological sample submitted to KDHE? No Water well disinfected? No

8 TYPE OF CASING USED: PVC CASING JOINTS: Threaded Casing diameter 2 in. to 15 ft., Diameter in. to ft., Diameter in. to ft. Casing height above land surface in. Weight lbs./ft. Wall thickness or gauge No. SCH 40 TYPE OF SCREEN OR PERFORATION MATERIAL: PVC SCREEN OR PERFORATION OPENINGS ARE: Mill Slot Louvered Shutter Key Punched Wire Wrapped Saw Cut None (Open Hole) SCREEN-PERFORATED INTERVALS: From 5 ft. to 15 ft. GRAVEL PACK INTERVALS: From 3 ft. to 15 ft.

9 GROUT MATERIAL: Concrete Surface Completion 0-1 Grout Intervals: From 1 ft. to 3 ft., From ft. to ft., From ft. to ft., From ft. to ft.

Nearest source of possible contamination: Lateral Lines Pit Privy Livestock Pens Insecticide Storage Fuel Storage Abandoned Water Well Seepage Pit Feedyard Fertilizer Storage Oil Well/Gas Well Direction from well? northeast Distance from well? 80 ft.

Table with columns: 10 FROM, TO, LITHOLOGIC LOG, FROM, TO, LITHO. LOG (cont.) or PLUGGING INTERVALS. Row 1: 0, 0.5, CONCRETE. Row 2: 0.5, 15, SILTY CLAY.

Notes:

11 CONTRACTOR'S OR LANDOWNER'S CERTIFICATION: This water well was constructed, reconstructed, or plugged under my jurisdiction and was completed on (mo-day-year) 2/7/22 and this record is true to the best of my knowledge and belief. Kansas Water Well Contractor's License No. 585. This Water Well Record was completed on (mo-day-year) 2/20/22 under the business name of ASSOCIATED ENVIRONMENTAL INC. Signature

Kingman

32-27-7W
33-27-7W
5-28-7W

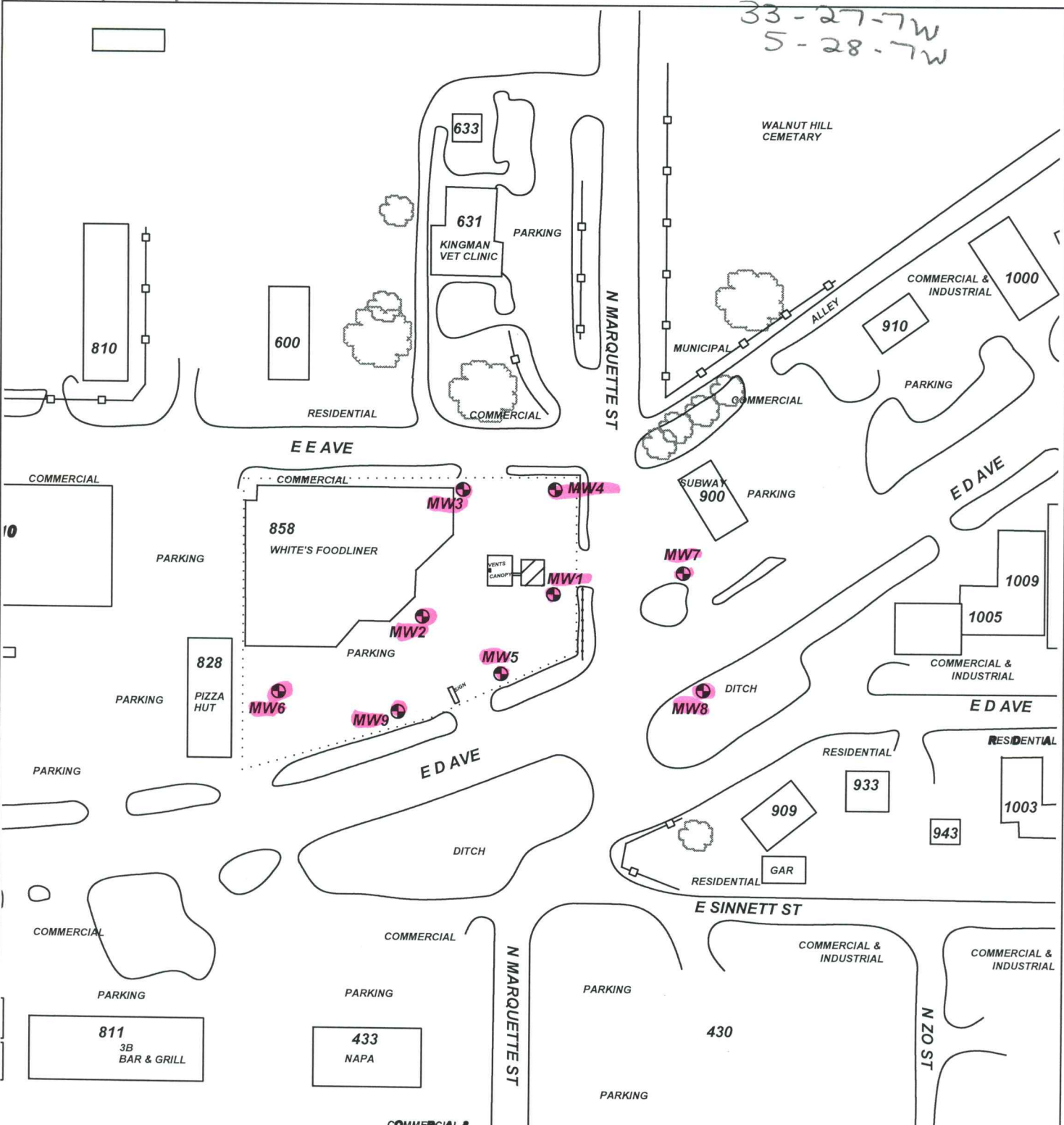

PROJECT: **WHITE'S FOODLINE**

ADDRESS: **858 E. D AVENUE**

LOCATION: **KINGMAN, KS**

DRAWN BY: **C. ROE** DATE: **9/9/21**

REVISED BY: **C. ROE** DATE: **4/8/22**

AEI JOB #: **TF540** KDHE JOB #: **U2-048-15350**

TITLE:

AEI ASSOCIATED ENVIRONMENTAL INC.

LEGEND:

= UST BASIN & CANOPY

= MONITORING WELL

= SUBJECT PROPERTY

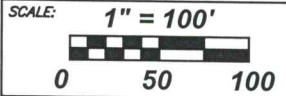

NOTES: