

-revised-

WATER WELL RECORD Form WWC-5

Division of Water Resources App. No.

[ ]

Well ID MW7

Original Record Correction Change in Well Use

1 LOCATION OF WATER WELL: County: KINGMAN Fraction Sw 1/4 sw 1/4 SW 1/4 nw 1/4 Section Number 33 Township Number T 27 S Range Number R 7 E W

2 WELL OWNER: Last Name: Business: WHITE'S KINGCO, INC. Address: 858 E. D AVE City: KINGMAN State: KS ZIP: 67068 Street or Rural Address where well is located

3 LOCATE WELL WITH 'X' IN SECTION BOX: [Diagram] 4 DEPTH OF COMPLETED WELL: 15 ft. 5 Latitude: 37.64713 Longitude: 98.09906 Elevation: 1531.65

7 WELL WATER TO BE USED AS: 1. Domestic 2. Irrigation 3. Feedlot 4. Industrial 5. Public Water Supply 6. Dewatering 7. Aquifer Recharge 8. Monitoring MW7 9. Environmental Remediation 10. Oil Field Water Supply 11. Test Hole 12. Geothermal 13. Other

Was a chemical/bacteriological sample submitted to KDHE? No If yes, date sample was submitted:

8 TYPE OF CASING USED: Steel PVC Other CASING JOINTS: Glued Clamped Welded Threaded Casing diameter 2 in. to 15 ft. Diameter in. to ft. Casing height above land surface in. Weight lbs./ft. Wall thickness or gauge No. SCH 40

9 GROUT MATERIAL: Neat cement Cement grout Bentonite Other Concrete Surface Completion 0-1 Grout Intervals: From 1 ft. to 3 ft. From ft. to ft. From ft. to ft.

Nearest source of possible contamination: Septic Tank Lateral Lines Pit Privy Livestock Pens Insecticide Storage Sewer Lines Cess Pool Sewage Lagoon Fuel Storage Abandoned Water Well Watertight Sewer Lines Seepage Pit Feedyard Fertilizer Storage Oil Well/Gas Well

Table with 6 columns: 10 FROM, TO, LITHOLOGIC LOG, FROM, TO, LITHO. LOG (cont.) or PLUGGING INTERVALS. Rows: 0-0.5 CONCRETE, 0.5-15 SILTY CLAY

11 CONTRACTOR'S OR LANDOWNER'S CERTIFICATION: This water well was constructed, reconstructed, or plugged under my jurisdiction and was completed on (mo-day-year) 2/8/22 and this record is true to the best of my knowledge and belief. Kansas Water Well Contractor's License No. 585 This Water Well Record was completed on (mo-day-year) 2/20/22 under the business name of ASSOCIATED ENVIRONMENTAL INC. Signature

Kingman

32-27-7W  
33-27-7W  
5-28-7W

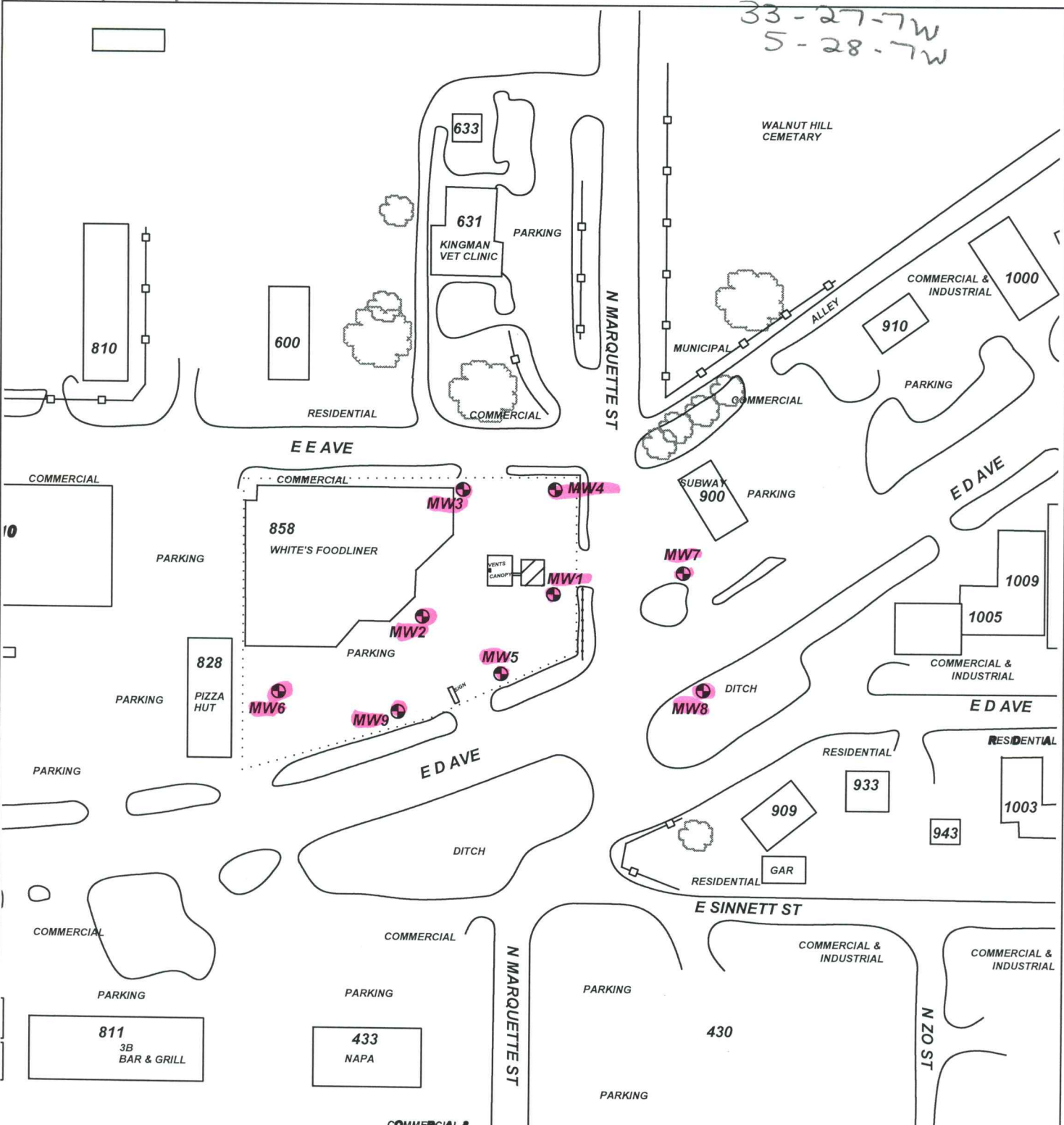

PROJECT: **WHITE'S FOODLINE**

ADDRESS: **858 E. D AVENUE**

LOCATION: **KINGMAN, KS**

DRAWN BY: **C. ROE** DATE: **9/9/21**

REVISED BY: **C. ROE** DATE: **4/8/22**

AEI JOB #: **TF540** KDHE JOB #: **U2-048-15350**

SCALE: **1" = 100'**  
0 50 100

TITLE:

**AEI** ASSOCIATED ENVIRONMENTAL INC.

LEGEND:

- = UST BASIN & CANOPY
- = MONITORING WELL
- = SUBJECT PROPERTY

