

revised

WATER WELL RECORD Form WWC-5

Division of Water Resources App. No.

[]

Well ID MW1

Original Record Correction Change in Well Use

1 LOCATION OF WATER WELL: County: KINGMAN Fraction SE 1/4 SE 1/4 SE 1/4 SE 1/4 Section Number 32 Township Number T 27 S Range Number R 7 E W

2 WELL OWNER: Last Name: Business: WHITE'S KINGCO, INC. Address: 858 E. D AVE City: KINGMAN State: KS ZIP: 67068 Street or Rural Address where well is located

3 LOCATE WELL WITH 'X' IN SECTION BOX: [Diagram] 4 DEPTH OF COMPLETED WELL: 15 ft. 5 Latitude: 37.64709 Longitude: 98.09953

7 WELL WATER TO BE USED AS: 1. Domestic: 2. Irrigation 3. Feedlot 4. Industrial 5. Public Water Supply 6. Dewatering 7. Aquifer Recharge 8. Monitoring: well ID MW1 9. Environmental Remediation 10. Oil Field Water Supply 11. Test Hole 12. Geothermal 13. Other

Was a chemical/bacteriological sample submitted to KDHE? Water well disinfected?

8 TYPE OF CASING USED: 2 in. to 15 ft. CASING JOINTS: Threaded TYPE OF SCREEN OR PERFORATION MATERIAL: PVC SCREEN OR PERFORATION OPENINGS ARE: Mill Slot SCREEN-PERFORATED INTERVALS: 5 ft. to 15 ft. GRAVEL PACK INTERVALS: 3 ft. to 15 ft.

9 GROUT MATERIAL: Neat cement Cement grout Bentonite Other Concrete Surface Completion 0-1 Grout Intervals: 1 ft. to 3 ft. Nearest source of possible contamination: Northwest Distance from well? 5 ft.

Table with columns: 10 FROM, TO, LITHOLOGIC LOG, FROM, TO, LITHO. LOG (cont.) or PLUGGING INTERVALS. Rows: 0-0.5 CONCRETE, 0.5-15 SILTY CLAY

11 CONTRACTOR'S OR LANDOWNER'S CERTIFICATION: This water well was constructed, reconstructed, or plugged under my jurisdiction and was completed on (mo-day-year) 2/7/22 and this record is true to the best of my knowledge and belief.

Kingman

32-27-7W
33-27-7W
5-28-7W

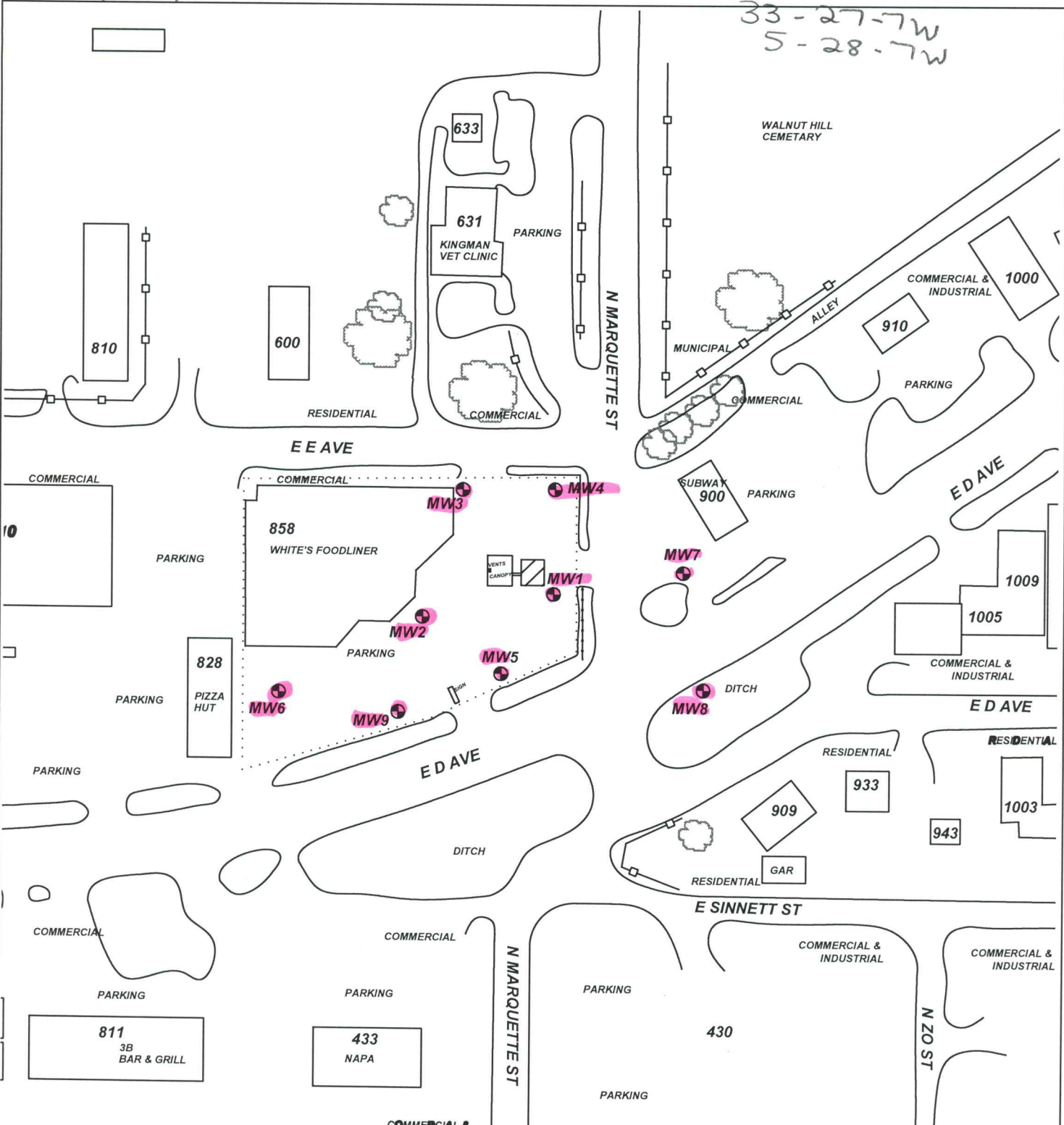

PROJECT: **WHITE'S FOODLINE**

ADDRESS: **858 E. D AVENUE**

LOCATION: **KINGMAN, KS**

DRAWN BY: **C. ROE** DATE: **9/9/21**

REVISED BY: **C. ROE** DATE: **4/8/22**

AEI JOB #: **TF540** KDHE JOB #: **U2-048-15350**

TITLE:

AEI ASSOCIATED ENVIRONMENTAL INC.

LEGEND:

= UST BASIN & CANOPY

= MONITORING WELL

= SUBJECT PROPERTY

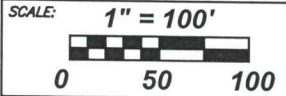

NOTES: