

-revised-

WATER WELL RECORD Form WWC-5

Division of Water Resources App. No.

[Blank Box]

Well ID MW2

Original Record Correction Change in Well Use

1 LOCATION OF WATER WELL: County: KINGMAN Fraction SE 1/4 SE 1/4 SE 1/4 SE 1/4 Section Number 32 Township Number T 27 S Range Number R 7 E W

2 WELL OWNER: Last Name: Business: WHITE'S KINGCO, INC. Address: 858 E. D AVE City: KINGMAN State: KS ZIP: 67068 Street or Rural Address where well is located

3 LOCATE WELL WITH 'X' IN SECTION BOX: N W E S 1 mile. 4 DEPTH OF COMPLETED WELL: 15 ft. 5 Latitude: 37.64706 Longitude: 98.09979

7 WELL WATER TO BE USED AS: 1. Domestic: 2. Irrigation: 3. Feedlot: 4. Industrial: 5. Public Water Supply: 6. Dewatering: 7. Aquifer Recharge: 8. Monitoring: 9. Environmental Remediation: 10. Oil Field Water Supply: 11. Test Hole: 12. Geothermal: 13. Other

Was a chemical/bacteriological sample submitted to KDHE? Water well disinfected?

8 TYPE OF CASING USED: Steel PVC Other CASING JOINTS: Glued Clamped Welded Threaded Casing diameter 2 in. to 15 ft. TYPE OF SCREEN OR PERFORATION MATERIAL: Steel Stainless Steel Fiberglass PVC Other

9 GROUT MATERIAL: Neat cement Cement grout Bentonite Other Concrete Surface Completion 0-1 Grout Intervals: From 1 ft. to 3 ft.

Nearest source of possible contamination: Septic Tank Lateral Lines Pit Privy Livestock Pens Insecticide Storage Sewer Lines Cess Pool Sewage Lagoon Fuel Storage Abandoned Water Well Watertight Sewer Lines Seepage Pit Feedyard Fertilizer Storage Oil Well/Gas Well

Table with columns: 10 FROM, TO, LITHOLOGIC LOG, FROM, TO, LITHO. LOG (cont.) or PLUGGING INTERVALS. Rows: 0-0.5 CONCRETE, 0.5-8 SILTY CLAY, 8-10 SANDY CLAY. Includes Notes section.

11 CONTRACTOR'S OR LANDOWNER'S CERTIFICATION: This water well was constructed, reconstructed, or plugged under my jurisdiction and was completed on (mo-day-year) 2/7/22 and this record is true to the best of my knowledge and belief.

Kingman

32-27-7W
33-27-7W
5-28-7W

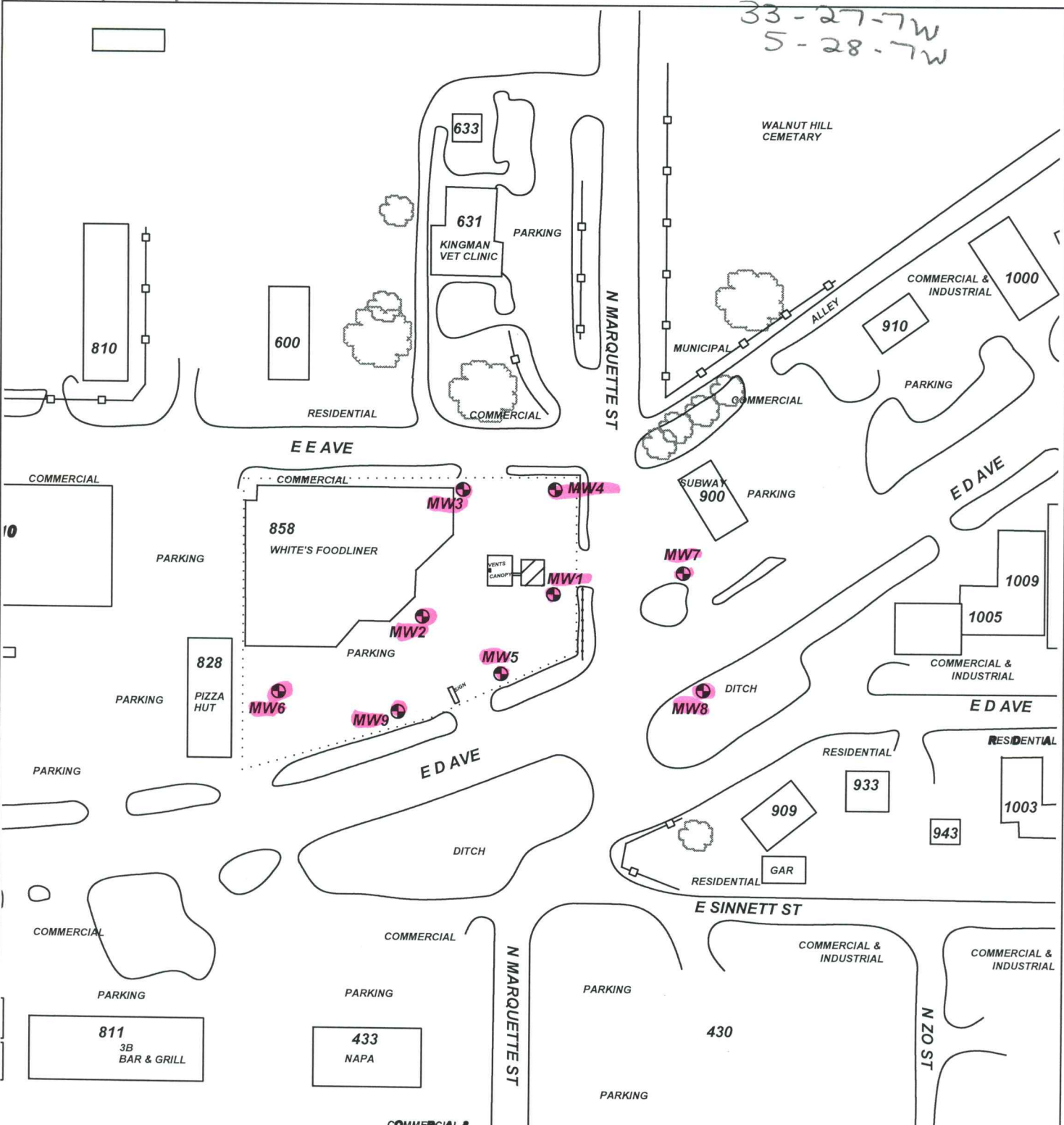

PROJECT: **WHITE'S FOODLINE**

ADDRESS: **858 E. D AVENUE**

LOCATION: **KINGMAN, KS**

DRAWN BY: **C. ROE** DATE: **9/9/21**

REVISED BY: **C. ROE** DATE: **4/8/22**

AEI JOB #: **TF540** KDHE JOB #: **U2-048-15350**



SCALE: **1" = 100'**
0 50 100

NOTES:

TITLE:



ASSOCIATED ENVIRONMENTAL INC.

- LEGEND:
-  = UST BASIN & CANOPY
 -  = MONITORING WELL
 -  = SUBJECT PROPERTY

