

-revised-

WATER WELL RECORD Form WWC-5

Original Record Correction Change in Well Use

Division of Water Resources App. No.

[]

MW3

Well ID

1 LOCATION OF WATER WELL: County: KINGMAN Fraction SE 1/4 SE 1/4 SE 1/4 SE 1/4 Section Number 32 Township Number T 27 S Range Number R 7 E W

2 WELL OWNER: Last Name: Business: WHITE'S KINGCO, INC. Address: 858 E. D AVE City: KINGMAN State: KS ZIP: 67068 Street or Rural Address where well is located

3 LOCATE WELL WITH "X" IN SECTION BOX: N W E S [Diagram showing a 2x2 grid with 'X' in the bottom-right corner]

4 DEPTH OF COMPLETED WELL: 15 ft. Depth(s) Groundwater Encountered: 1) ... ft. 2) ... ft. 3) ... ft., or 4) [] Dry Well WELL'S STATIC WATER LEVEL: 6.04 ft. below land surface, measured on (mo-day-yr) 3/24/22

5 Latitude: 37.64735 (decimal degrees) Longitude: 98.09973 (decimal degrees) Horizontal Datum: [] WGS 84 [] NAD 83 [] NAD 27 Source for Latitude/Longitude: [] GPS (unit make/model: ... (WAAS enabled? [] Yes [] No) [] Land Survey [] Topographic Map [] Online Mapper:

6 Elevation: 1530.89 ft. [] Ground Level [] TOC Source: [] Land Survey [] GPS [] Topographic Map [] Other

7 WELL WATER TO BE USED AS: 1. Domestic: [] Household [] Lawn & Garden [] Livestock [] Irrigation [] Feedlot [] Industrial 5. [] Public Water Supply: well ID ... 6. [] Dewatering: how many wells? ... 7. [] Aquifer Recharge: well ID ... 8. [] Monitoring: well ID MW3 9. Environmental Remediation: well ID ... [] Air Sparge [] Soil Vapor Extraction [] Recovery [] Injection 10. [] Oil Field Water Supply: lease ... 11. Test Hole: well ID ... [] Cased [] Uncased [] Geotechnical 12. Geothermal: how many bores? ... a) Closed Loop [] Horizontal [] Vertical b) Open Loop [] Surface Discharge [] Inj. of Water 13. [] Other (specify):

Was a chemical/bacteriological sample submitted to KDHE? [] Yes [] No If yes, date sample was submitted: Water well disinfected? [] Yes [] No

8 TYPE OF CASING USED: [] Steel [] PVC [] Other CASING JOINTS: [] Glued [] Clamped [] Welded [] Threaded Casing diameter 2 in. to 15 ft., Diameter in. to ft., Diameter in. to ft. Casing height above land surface in. Weight lbs./ft. Wall thickness or gauge No. SCH 40 TYPE OF SCREEN OR PERFORATION MATERIAL: [] Steel [] Stainless Steel [] Fiberglass [] PVC [] Other (Specify) [] Brass [] Galvanized Steel [] Concrete tile [] None used (open hole) SCREEN OR PERFORATION OPENINGS ARE: [] Continuous Slot [] Mill Slot [] Gauze Wrapped [] Torch Cut [] Drilled Holes [] Other (Specify) [] Louvered Shutter [] Key Punched [] Wire Wrapped [] Saw Cut [] None (Open Hole) SCREEN-PERFORATED INTERVALS: From 5 ft. to 15 ft., From ft. to ft., From ft. to ft. GRAVEL PACK INTERVALS: From 3 ft. to 15 ft., From ft. to ft., From ft. to ft.

9 GROUT MATERIAL: [] Neat cement [] Cement grout [] Bentonite [] Other Concrete Surface Completion 0-1 Grout Intervals: From 1 ft. to 3 ft., From ft. to ft., From ft. to ft., From ft. to ft.

Nearest source of possible contamination: [] Septic Tank [] Lateral Lines [] Pit Privy [] Livestock Pens [] Insecticide Storage [] Sewer Lines [] Cess Pool [] Sewage Lagoon [] Fuel Storage [] Abandoned Water Well [] Watertight Sewer Lines [] Seepage Pit [] Feedyard [] Fertilizer Storage [] Oil Well/Gas Well [] Other (Specify) Direction from well? SOUTHEAST Distance from well? 25 ft.

Table with 6 columns: 10 FROM, TO, LITHOLOGIC LOG, FROM, TO, LITHO. LOG (cont.) or PLUGGING INTERVALS. Row 1: 0, 0.5, CONCRETE, , , . Row 2: 0.5, 15, SILTY CLAY, , , .

11 CONTRACTOR'S OR LANDOWNER'S CERTIFICATION: This water well was [] constructed, [] reconstructed, or [] plugged under my jurisdiction and was completed on (mo-day-year) 2/7/22 and this record is true to the best of my knowledge and belief. Kansas Water Well Contractor's License No. 585. This Water Well Record was completed on (mo-day-year) 2/20/22 under the business name of ASSOCIATED ENVIRONMENTAL INC. Signature

Kingman

32-27-7W
33-27-7W
5-28-7W

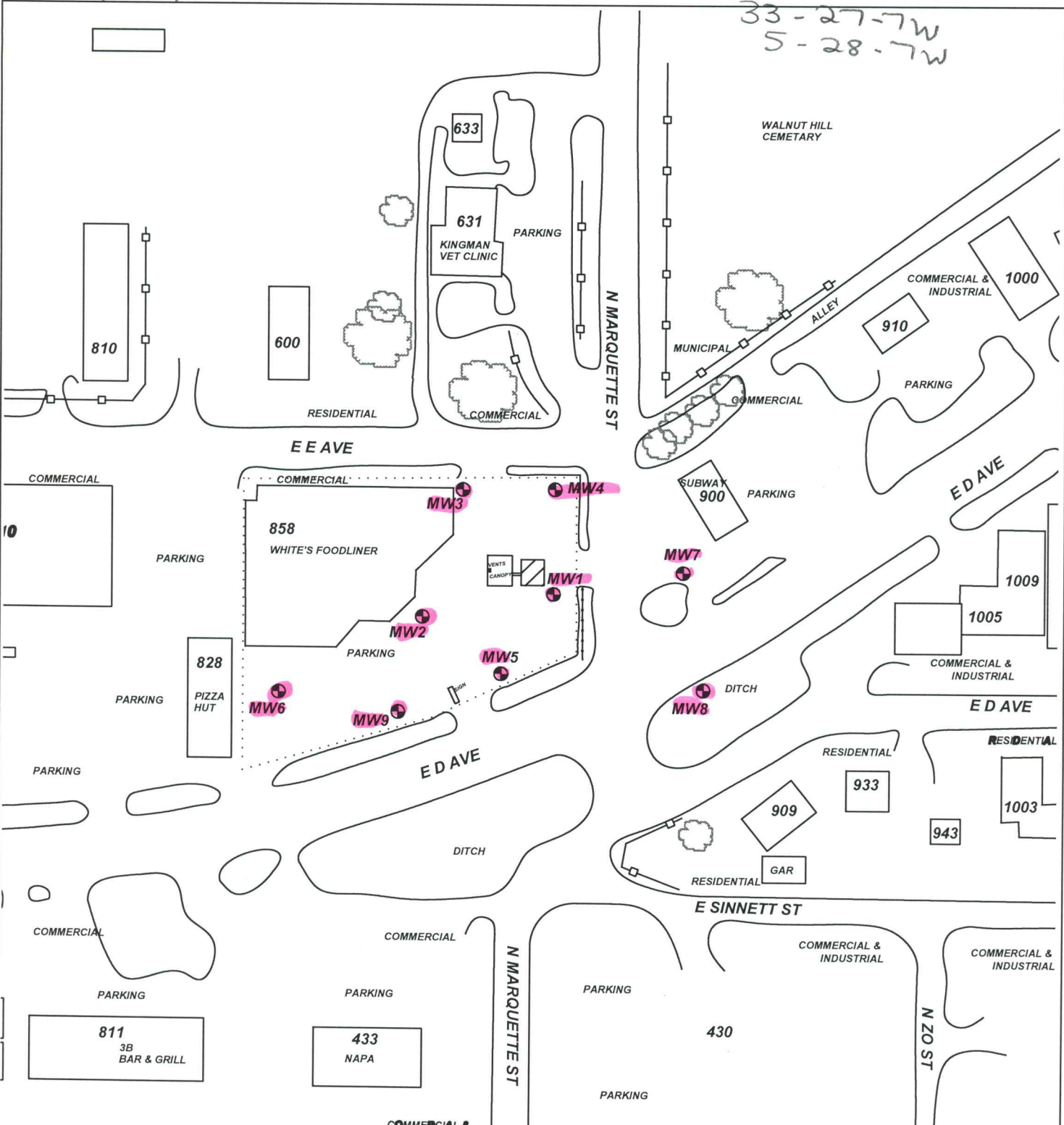

PROJECT: **WHITE'S FOODLINE**

ADDRESS: **858 E. D AVENUE**

LOCATION: **KINGMAN, KS**

DRAWN BY: **C. ROE** DATE: **9/9/21**

REVISED BY: **C. ROE** DATE: **4/8/22**

AEI JOB #: **TF540** KDHE JOB #: **U2-048-15350**

TITLE:

AEI ASSOCIATED ENVIRONMENTAL INC.

LEGEND:

= UST BASIN & CANOPY

= MONITORING WELL

= SUBJECT PROPERTY

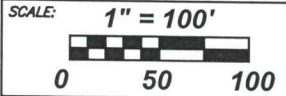

NOTES: