

-revised-

WATER WELL RECORD Form WWC-5

Original Record Correction Change in Well Use

Division of Water Resources App. No.

[ ]

Well ID

MW5

1 LOCATION OF WATER WELL: County: KINGMAN Fraction SE 1/4 SE 1/4 SE 1/4 SE 1/4 Section Number 32 Township Number T 27 S Range Number R 7 E W

2 WELL OWNER: Last Name: Business: WHITE'S KINGCO, INC. Address: 858 E. D AVE City: KINGMAN State: KS ZIP: 67068 Street or Rural Address where well is located

3 LOCATE WELL WITH 'X' IN SECTION BOX: [Diagram] 4 DEPTH OF COMPLETED WELL: 15 ft. 5 Latitude: 37.64688 Longitude: 98.09965

7 WELL WATER TO BE USED AS: 1. Domestic 2. Irrigation 3. Feedlot 4. Industrial 5. Public Water Supply 6. Dewatering 7. Aquifer Recharge 8. Monitoring MW5 9. Environmental Remediation 10. Oil Field Water Supply 11. Test Hole 12. Geothermal 13. Other

Was a chemical/bacteriological sample submitted to KDHE? No If yes, date sample was submitted:

8 TYPE OF CASING USED: PVC CASING JOINTS: Threaded Casing diameter 2 in. to 15 ft. Diameter in. to ft. Casing height above land surface in. Weight lbs./ft. Wall thickness or gauge No. SCH 40

9 GROUT MATERIAL: Concrete Surface Completion 0-1 Grout Intervals: From 1 ft. to 3 ft., From 3 ft. to 15 ft., From 15 ft. to ft., From ft. to ft.

Nearest source of possible contamination: Septic Tank Lateral Lines Pit Privy Livestock Pens Insecticide Storage Sewer Lines Cess Pool Sewage Lagoon Fuel Storage Abandoned Water Well Watertight Sewer Lines Seepage Pit Feedyard Fertilizer Storage Oil Well/Gas Well

Table with columns: 10 FROM TO LITHOLOGIC LOG FROM TO LITHO. LOG (cont.) or PLUGGING INTERVALS. Rows: 0 to 0.5 CONCRETE, 0.5 to 15 SILTY CLAY. Includes Notes section.

11 CONTRACTOR'S OR LANDOWNER'S CERTIFICATION: This water well was constructed, reconstructed, or plugged under my jurisdiction and was completed on (mo-day-year) 2/7/22 and this record is true to the best of my knowledge and belief.

Kingman

32-27-7W  
33-27-7W  
5-28-7W

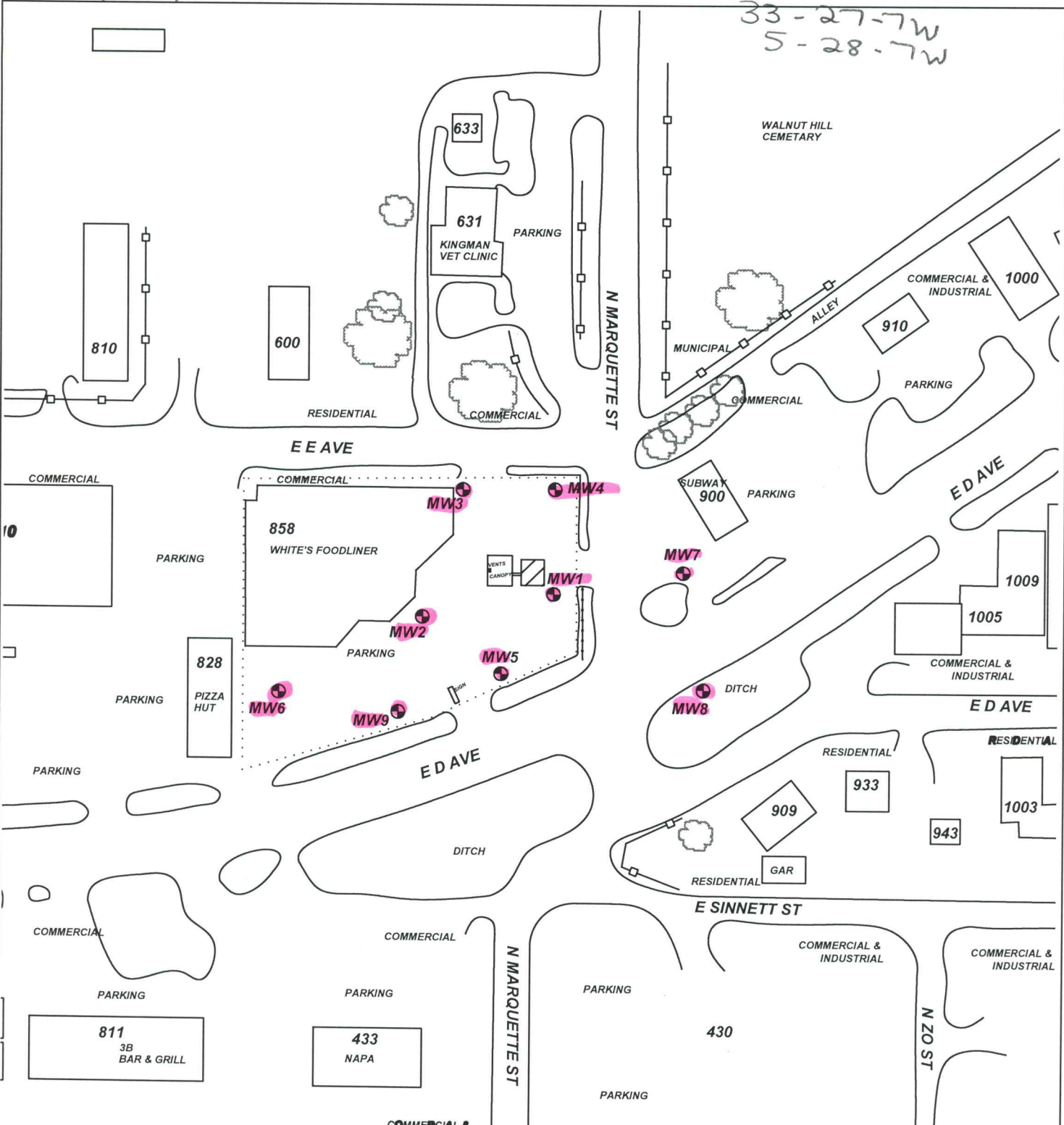

PROJECT: **WHITE'S FOODLINE**

ADDRESS: **858 E. D AVENUE**

LOCATION: **KINGMAN, KS**

DRAWN BY: **C. ROE** DATE: **9/9/21**

REVISED BY: **C. ROE** DATE: **4/8/22**

AEI JOB #: **TF540** KDHE JOB #: **U2-048-15350**

TITLE:

 **ASSOCIATED ENVIRONMENTAL INC.**

LEGEND:

 = UST BASIN & CANOPY

 = MONITORING WELL

 = SUBJECT PROPERTY

SCALE: **1" = 100'**



0 50 100

NOTES: