

USE TYPEWRITER OR BALL POINT PEN-PRESS FIRMLY, PRINT CLEARLY.

WATER WELL RECORD
KSA 82a-1201-1215

Kansas Department of Health and Environment-Division of Environment (Water well Contractors) Topeka, Kansas 66620

1. Location of well: County Kingman Fraction NE 1/4 NE 1/4 SE 1/4 Section number 21 Township number T 27 S R 8 W Range number 8

2. Distance and direction from nearest town or city: 4 West 2 1/2 N of Kingman
Street address of well location if in city:
3. Owner of well: Penalosa Co. P.
R.R. None
City, state, zip code: Kingman, Kan 67068

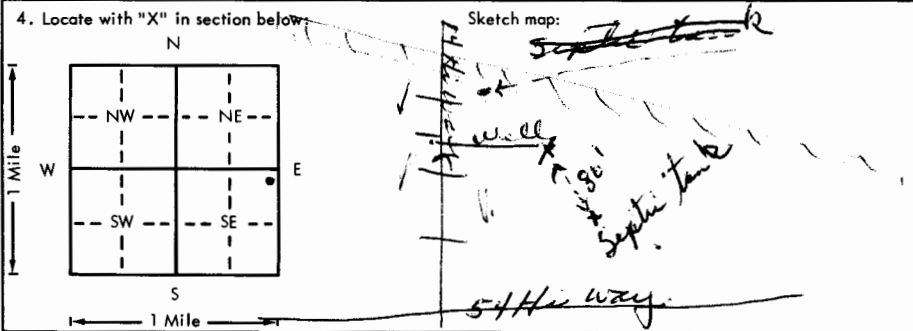

6. Bore hole dia. 2 1/4 in. Completion date Feb 8-80
Well depth 97 ft.

7. Cable tool Rotary Driven Dug
 Hollow rod Jetted Bored Reverse rotary

8. Use: Domestic Public supply Industry
 Irrigation Air conditioning Stock
 Lawn Oil field water Other

9. Casing: Material PLS Height: Above or below
Threaded Welded Surface 14 in.
RMP PVC Weight 200 wall lbs./ft.
Dia. 5 in. to 97 ft. depth Wall Thickness: inches or
Dia. in. to ft. depth Gage No. 200 wall

5. Type and color of material	From	To
<u>Sandy top soil</u>	<u>0</u>	<u>3</u>
<u>Sandy loam</u>	<u>3</u>	<u>10</u>
<u>White Clay (limy)</u>	<u>10</u>	<u>16</u>
<u>Course Brown Sand</u>	<u>16</u>	<u>29</u>
<u>Brown Clay</u>	<u>29</u>	<u>41</u>
<u>Medium Course Sand</u>	<u>41</u>	<u>63</u>
<u>Clay</u>	<u>63</u>	<u>78</u>
<u>Course Sand & Gravel</u>	<u>78</u>	<u>97</u>
<u>Red Bed.</u>		

10. Screen: Manufacturer's name J & D.
Type RMP Dia. 5"
Slot/gauze 1/8 x 200 wall length 20'
Set between 77 ft. and 97 ft.
Gravel pack? Size range of material 1/8 x 3/8

11. Static water level: 43 ft. below land surface Date Feb 8-80

12. Pumping level below land surfaces:
 ft. after NA hrs. pumping g.p.m.
 ft. after NA hrs. pumping g.p.m.
Estimated maximum yield g.p.m.

13. Water sample submitted: mo./day/yr.
 Yes No Date Mar 8-80

14. Well head completion:
 Pitless adapter 14 inches above grade

15. Well grouted?
With: Neat cement Bentonite Concrete
Depth: From 3 ft. to 16 ft.

16. Nearest source of possible contamination:
ft. 80 Direction SE Type Septic tank
Well disinfected upon completion? Yes No

17. Pump: Not installed
Manufacturer's name Star Site
Model number REP4002HP 1 Volts 230
Length of drop pipe ft. capacity 20 g.p.m.
Type:
 Submersible Turbine
 Jet Reciprocating
 Centrifugal Other

18. Elevation:
Topography:
 Hill
 Slope
 Upland
 Valley

19. Remarks:

20. Water well contractor's certification:
This well was drilled under my jurisdiction and this report is true to the best of my knowledge and belief.
Wells Drilling Co 112
Business name License No.
Address 1030 N. Hwy 24 E. Kingman
Signed Paul J. Wells Date Mar 24 1980
Authorized representative

30
27
8
21
1/4
NE
SE