

**1 LOCATION OF WATER WELL:** Fraction 1/4 SE 1/4 SE 1/4 NE 1/4 Section Number 13 Township Number T 28 S Range Number 7  E  W  
 County: Sedgwick

Street/Rural Address of Well Location; if unknown, distance & direction from nearest town or intersection: If at owner's address, check here  Meridian and Macarthur  
Wichita, KS

**Global Positioning Systems (GPS) information:**  
 Latitude: \_\_\_\_\_ (in decimal degrees)  
 Longitude: \_\_\_\_\_ (in decimal degrees)  
 Elevation: \_\_\_\_\_  
 Datum:  WGS84,  NAD83,  NAD27  
 Collection Method:  
 GPS unit (Make/Model: \_\_\_\_\_)  
 Digital Map/Photo,  Topographic Map,  Land Survey  
 Est. Accuracy:  < 3 m,  3-5 m,  5-15 m,  > 15 m

**2 WATER WELL OWNER:** CK Contracting LLC  
 RR#, St. Address, Box #: 1444 S St Clair, Bldg B  
 City, State ZIP Code: Wichita, KS 67213

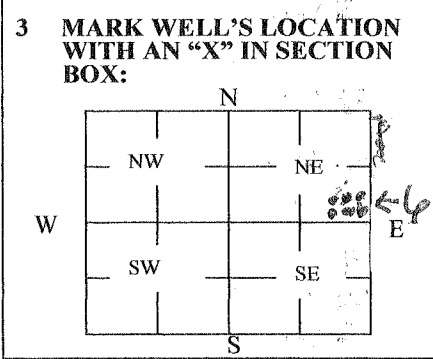

**4 DEPTH OF WELL** 40 ft.  
 WELL'S STATIC WATER LEVEL 12 ft.  
 WELL WAS USED AS:  
 Domestic  Public Water Supply  Dewatering -6 wells  
 Irrigation  Oil Field Water Supply  Monitoring  
 Feedlot  Domestic (Lawn & Garden)  Injection Well  
 Industrial  Air Conditioning  Other \_\_\_\_\_  
 Was a chemical/bacteriological sample submitted to Department? Yes  No

**5 TYPE OF BLANK CASING USED:**  
 Steel  RMP (SR)  Wrought  Fiberglass  Other (Specify below)  
 PVC  ABS  Asbestos-Cement  Concrete Tile  
 Blank casing diameter 8 in. Was casing pulled? Yes  No  If yes, how much \_\_\_\_\_  
 Casing height above or below land surface 36 in.

**6 GROUT PLUG MATERIAL:**  Neat cement  Cement grout  Bentonite  Other \_\_\_\_\_  
 Grout Plug Intervals: From 3 ft. to 24 ft., From \_\_\_\_\_ ft. to \_\_\_\_\_ ft., From \_\_\_\_\_ ft. to \_\_\_\_\_ ft.  
 What is the nearest source of possible contamination:  
 Septic tank  Seepage pit  Fuel storage  Other (specify below)  
 Sewer lines  Pit privy  Fertilizer storage  
 Watertight sewer lines  Sewage lagoon  Insecticide storage  
 Lateral lines  Feedyard  Abandoned water well  
 Cess pool  Livestock pens  Oil well/Gas well  
 Direction from well? West  
 How many feet? 45

FROM	TO	PLUGGING MATERIALS	FROM	TO	PLUGGING MATERIALS
<u>24</u>	<u>40</u>	<u>Gravel</u>			
<u>3</u>	<u>24</u>	<u>Bentonite</u>			
<u>0</u>	<u>3</u>	<u>Top Soil</u>			

**7 CONTRACTOR'S OR LANDOWNER'S CERTIFICATION:** This water well was plugged under my jurisdiction and was completed on (mo/day/year) 4-11-2014 and this record is true to the best of my knowledge and belief. Kansas Water Well Contractor's License No. 884. This Water Well Record was completed on (mo/day/year) 6-10-14 under the business name of Weninger Drilling LLC by (signature) Travis Cutler

**INSTRUCTIONS:** Use typewriter or ballpoint pen. Please press firmly and print clearly. Please fill in blanks, underline or circle the correct answers. Send top three copies to Kansas Department of Health and Environment, Bureau of Water, Geology Section, 1000 SW Jackson St., Ste. 420, Topeka, Kansas 66612-1367. Telephone: 785/296-5524. Send one to Water Well Owner and retain one for your records. Visit us at <http://www.kdheks.gov/waterwell/index.html>.