

1 LOCATION OF WATER WELL: Fraction 1/4 NW 1/4 NW 1/4 NW 1/4 Section Number 30 Township Number T 28 S Range Number 7 E W
 County: Dodge

Street/Rural Address of Well Location; if unknown, distance & direction from nearest town or intersection: If at owner's address, check here
11821 W Cedar Lane
 Global Positioning Systems (GPS) information:
 Latitude: _____ (in decimal degrees)
 Longitude: _____ (in decimal degrees)
 Elevation: _____
 Horizontal Datum: WGS84, NAD83, NAD27
 Collection Method:
 GPS unit (Make/Model): _____
 Digital Map/Photo, Topographic Map, Land Survey
 Est. Accuracy: < 3 m, 3-5 m, 5-15 m, > 15 m

2 WATER WELL OWNER: Mr Kirker
 RR#, St. Address, Box #: 11821 Cedar Lane
 City, State ZIP Code: Maize KS 67101

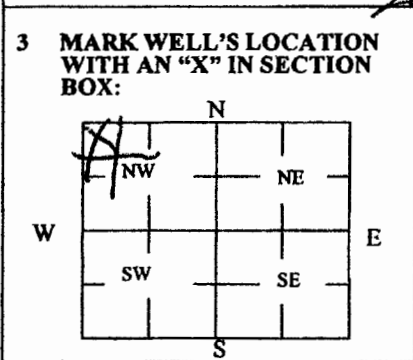

4 DEPTH OF WELL 50 ft.
 WELL'S STATIC WATER LEVEL 24 ft.
 WELL WAS USED AS:
 Domestic Public Water Supply Dewatering
 Irrigation Oil Field Water Supply Monitoring
 Feedlot Domestic (Lawn & Garden) Injection Well
 Industrial Air Conditioning Other _____
 Was a chemical/bacteriological sample submitted to Department? Yes No

5 TYPE OF BLANK CASING USED:
 Steel RMP (SR) Wrought Fiberglass Other (Specify below)
 PVC ABS Asbestos-Cement Concrete Tile
 Blank casing diameter 5 in. Was casing pulled? Yes No If yes, how much _____
 Casing height above or below land surface 36 in.

6 GROUT PLUG MATERIAL: Neat cement Cement grout Bentonite Other _____
 Grout Plug Intervals: From 50 ft. to 3 ft., From _____ ft. to _____ ft., From _____ ft. to _____ ft.

What is the nearest source of possible contamination:
 Septic tank Seepage pit Fuel storage Other (specify below) _____
 Sewer lines Pit privy Fertilizer storage _____
 Watertight sewer lines Sewage lagoon Insecticide storage _____
 Lateral lines Feedyard Abandoned water well Oil well/Gas well
 Cess pool Livestock pens
 Direction from well? S. E
 How many feet? 60'

FROM	TO	PLUGGING MATERIALS	FROM	TO	PLUGGING MATERIALS
<u>50</u>	<u>4</u>	<u>Bentonite</u>	<u>4</u>	<u>3</u>	<u>Hole Plug</u>
<u>4</u>	<u>3</u>	<u>Cement</u>			
<u>3</u>		<u>Bottom of Pit</u>			

7 CONTRACTOR'S OR LANDOWNER'S CERTIFICATION: This water well was plugged under my jurisdiction and was completed on (mo/day/year) 4-20-16 and this record is true to the best of my knowledge and belief. Kansas Water Well Contractor's License No. 4729. This Water Well Record was completed on (mo/day/year) 4-20-16 under the business name of Burdan Pump & Well by (signature) David Beek