

WATER WELL RECORD Form WWC-5

Division of Water Resources App. No.

Well ID NKMW 01S

Original Record Correction Change in Well Use

1 LOCATION OF WATER WELL: County: Sedwick	Fraction NW ¼ NE ¼ NE ¼ NE ¼	Section Number 1	Township Number T 28 S	Range Number R 1 <input type="checkbox"/> E <input checked="" type="checkbox"/> W
-----------------------------------------------------	---------------------------------	---------------------	---------------------------	--------------------------------------------------------------------------------------

2 WELL OWNER: Last Name: First: Business: KDHE - BER Curtis State Office Building Address: 1000 SW Jackson St. Suite 410 Address: City: Topeka State: KS ZIP: 66612-1367	Street or Rural Address where well is located (if unknown, distance and direction from nearest town or intersection): If at owner's address, check here: <input type="checkbox"/> KDHE - West Pawnee Site, 2559 West Pawnee, Wichita, Ks.
---------------------------------------------------------------------------------------------------------------------------------------------------------------------------------------------	----------------------------------------------------------------------------------------------------------------------------------------------------------------------------------------------------------------------------------------------

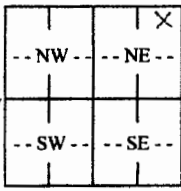
3 LOCATE WELL WITH "X" IN SECTION BOX: N  W E S [-----1 mile-----]	4 DEPTH OF COMPLETED WELL: 20 ft. Depth(s) Groundwater Encountered: 1) ft. 2) ft. 3) ft., or 4) <input type="checkbox"/> Dry Well WELL'S STATIC WATER LEVEL: 7.81 ft. <input checked="" type="checkbox"/> below land surface, measured on (mo-day-yr) 9-12-16 <input type="checkbox"/> above land surface, measured on (mo-day-yr) Pump test data: Well water was ft. after hours pumping gpm Well water was ft. after hours pumping gpm Estimated Yield: gpm Bore Hole Diameter: 8.75 in. to ft. and in. to ft.	5 Latitude: 37.65124 (decimal degrees) Longitude: 97.37235 (decimal degrees) Horizontal Datum: <input type="checkbox"/> WGS 84 <input checked="" type="checkbox"/> NAD 83 <input type="checkbox"/> NAD 27 Source for Latitude/Longitude: <input type="checkbox"/> GPS (unit make/model:) (WAAS enabled? <input type="checkbox"/> Yes <input type="checkbox"/> No) <input checked="" type="checkbox"/> Land Survey <input type="checkbox"/> Topographic Map <input type="checkbox"/> Online Mapper: 6 Elevation: 1289.87 ft. <input type="checkbox"/> Ground Level <input checked="" type="checkbox"/> TOC Source: <input checked="" type="checkbox"/> Land Survey <input type="checkbox"/> GPS <input type="checkbox"/> Topographic Map <input type="checkbox"/> Other
---------------------------------------------------------------------------------------------------------------------------------------------------------------------------	-------------------------------------------------------------------------------------------------------------------------------------------------------------------------------------------------------------------------------------------------------------------------------------------------------------------------------------------------------------------------------------------------------------------------------------------------------------------------------------------------------------------------------------------------------------------------------------------------------------------------------------------------------------------------	---------------------------------------------------------------------------------------------------------------------------------------------------------------------------------------------------------------------------------------------------------------------------------------------------------------------------------------------------------------------------------------------------------------------------------------------------------------------------------------------------------------------------------------------------------------------------------------------------------------------------------------------------------------------------------------------------------------------------------------------------------------------------------------------------------------------------------------------------------------------------

7 WELL WATER TO BE USED AS:

1. Domestic: <input type="checkbox"/> Household <input type="checkbox"/> Lawn & Garden <input type="checkbox"/> Livestock 2. <input type="checkbox"/> Irrigation 3. <input type="checkbox"/> Feedlot 4. <input type="checkbox"/> Industrial	5. <input type="checkbox"/> Public Water Supply: well ID 6. <input type="checkbox"/> Dewatering: how many wells? 7. <input type="checkbox"/> Aquifer Recharge: well ID 8. <input checked="" type="checkbox"/> Monitoring: well ID NKMW-01S 9. Environmental Remediation: well ID <input type="checkbox"/> Air Sparge <input type="checkbox"/> Soil Vapor Extraction <input type="checkbox"/> Recovery <input type="checkbox"/> Injection	10. <input type="checkbox"/> Oil Field Water Supply: lease 11. Test Hole: well ID <input type="checkbox"/> Cased <input type="checkbox"/> Uncased <input type="checkbox"/> Geotechnical 12. Geothermal: how many bores? a) Closed Loop <input type="checkbox"/> Horizontal <input type="checkbox"/> Vertical b) Open Loop <input type="checkbox"/> Surface Discharge <input type="checkbox"/> Inj. of Water 13. <input type="checkbox"/> Other (specify):
---------------------------------------------------------------------------------------------------------------------------------------------------------------------------------------------------------------------------------------------------------------	------------------------------------------------------------------------------------------------------------------------------------------------------------------------------------------------------------------------------------------------------------------------------------------------------------------------------------------------------------------------------------------------------------------------------------------------------------------------------------	-----------------------------------------------------------------------------------------------------------------------------------------------------------------------------------------------------------------------------------------------------------------------------------------------------------------------------------------------------------------------------------------------------------------------------------------------------------------------------------------------------

Was a chemical/bacteriological sample submitted to KDHE? Yes No If yes, date sample was submitted:

Water well disinfected? Yes No

8 TYPE OF CASING USED: Steel PVC Other CASING JOINTS: Glued Clamped Welded Threaded
 Casing diameter 2 in. to 19.76 ft., Diameter in. to ft., Diameter in. to ft.
 Casing height above land surface 0 in. Weight lbs./ft. Wall thickness or gauge No. sch. 40
TYPE OF SCREEN OR PERFORATION MATERIAL:
 Steel Stainless Steel Fiberglass PVC Other (Specify)
 Brass Galvanized Steel Concrete tile None used (open hole)
SCREEN OR PERFORATION OPENINGS ARE:
 Continuous Slot Mill Slot Gauze Wrapped Torch Cut Drilled Holes Other (Specify)
 Louvered Shutter Key Punched Wire Wrapped Saw Cut None (Open Hole)
SCREEN-PERFORATED INTERVALS: From 9.76 ft. to 19.76 ft., From ft. to ft., From ft. to ft.
GRAVEL PACK INTERVALS: From 7 ft. to 20 ft., From ft. to ft., From ft. to ft.

9 GROUT MATERIAL: Neat cement Cement grout Bentonite Other
 Grout Intervals: From 0 ft. to 7 ft., From ft. to ft., From ft. to ft.
Nearest source of possible contamination:
 Septic Tank Lateral Lines Pit Privy Livestock Pens Insecticide Storage
 Sewer Lines Cess Pool Sewage Lagoon Fuel Storage Abandoned Water Well
 Watertight Sewer Lines Seepage Pit Feedyard Fertilizer Storage Oil Well/Gas Well
 Other (Specify)
 Direction from well? Distance from well? ft.

10 FROM	TO	LITHOLOGIC LOG	FROM	TO	LITHO. LOG (cont.) or PLUGGING INTERVALS
0	8	Clay, brown-yellow brown, damp, stiff, plastic			
8	12	Clay, dark gray brown, silty, moist			
12	16	Sand, gray brown, fine, wet			
16	18	Sand, gray brown, fine to coarse, loose			
18	20	Sand, gray brown, fine to medium, wet			
Notes:					

11 CONTRACTOR'S OR LANDOWNER'S CERTIFICATION: This water well was constructed, reconstructed, or plugged under my jurisdiction and was completed on (mo-day-year) 8-25-2016 and this record is true to the best of my knowledge and belief. Kansas Water Well Contractor's License No. 604 This Water Well Record was completed on (mo-day-year) 11/19/16 under the business name of Environmental Priority Service, Inc. Signature: *PAANT*

Mail 1 white copy along with a fee of \$5.00 for each constructed well to: Kansas Department of Health and Environment, Bureau of Water, GWTS Section, 1000 SW Jackson St., Suite 420, Topeka, Kansas 66612-1367. Mail one to Water Well Owner and retain one for your records. Telephone 785-296-5524.
 Visit us at http: www.kdheks.gov/waterwell/index.html KSA 82a-1212 Revised 7/10/2015

SURVEYING OF MONITORING WELLS
KDHE - West Pawnee Site - 93671
2559 W. Pawnee
WICHITA, SEDGWICK COUNTY, KANSAS

The above site is located in Section 1 of T28S, R1W & Sections 5 & 6 of T28S, R1E of the Sixth Principal Meridian, Sedgwick County, Kansas.

Horizontal Coordinates are in Nad83 State Plane Kansas South Zone 1502.
Coordinates are derived from the City of Wichita CORS Network.

Vertical Control #1: COW Brass Disk located in the East Right-of-Way of Meridian Ave. and the North Right-of-Way of 27th St. South NGVD29 Datum Elevation of 1287.02'Utilizing NGS's "VERTCON" elevations were adjusted to NAVD88 Datum elevation of 1287.49'

Vertical Control #2: COW Brass Disk located on the Hubguard at the Southwest corner of the bridge over the Arkansas River on Pawnee Ave NGVD29 Datum Elevation of 1292.27'Utilizing NGS's "VERTCON" elevations were adjusted to NAVD88 Datum elevation of 1292.74'

The coordinates and elevations for the requested wells are listed on the following page of this report.

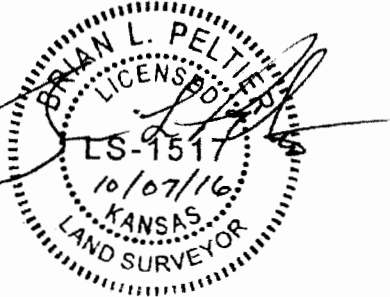

Brian L. Peltier
Kansas PS#1517



Burns & McDonnell
 9400 Ward Parkway
 Kansas City, MO 64114

October 6, 2016
 Job # 16-09-240
 Page 2 of 5

SURVEYING OF MONITORING WELLS
KDHE - West Pawnee Site - 93671
2559 W. Pawnee
WICHITA, SEDGWICK COUNTY, KANSAS

Well ID	NORTHING (NAD83 KS S) Latitude DD	EASTING (NAD83 KS S) Longitude DD	ELEV (NAVD88)	
Site BM #1 City Brass Disk	1670256.59 N37.64421	1639299.19 W97.37069	1287.49	Site Control
Site BM #2 City Brass Disk	1672995.97 N37.65150	1646064.63 W97.34721	1292.74	Site Control
NKMW-01S	1672811.37 N37.65124	1638789.04 W97.37235	1289.87 1290.17	TOC Bolt
NKMW-01I	1672811.10 N37.65124	1638784.85 W97.37236	1289.75 1290.18	TOC Bolt
NKMW-01D	1672810.97 N37.65124	1638780.31 W97.37238	1289.97 1290.24	TOC Bolt
NKMW-02S	1672584.27 N37.65060	1639262.63 W97.37072	1289.55 1289.95	TOC Bolt
NKMW-02I	1672580.83 N37.65059	1639262.46 W97.37072	1289.60 1289.97	TOC Bolt
NKMW-02D	1672576.95 N37.65058	1639261.69 W97.37073	1289.56 1290.02	TOC Bolt
NKMW-03S	1672227.57 N37.64960	1639854.76 W97.36869	1288.11 1288.46	TOC Bolt
NKMW-03D	1672232.45 N37.64961	1639854.71 W97.36869	1288.14 1288.41	TOC Bolt

Sec. 6 T28S R1E
Sec. 1 T28S R1W

DRAFT

Path: \\bmcd\dfs\Clients\ENV\KDHE\93671_WestPawnee\GIS\Studies\Geospatial\ArcDocs\Figure4_4_Piezo_Shallow_Wells_Map_103.mxd
COPYRIGHT © 2015 BURNS & MCDONNELL ENGINEERING COMPANY, INC.



Legend <ul style="list-style-type: none">West Pawnee Monitoring WellAir Capitol Monitoring WellLUST Monitoring WellIce Masters Monitoring WellGroundwater Flow DirectionPiezometric Contour	 0 250 500 Feet	Figure 4-4 Piezometric Surface Map (Shallow) West Pawnee Site ISL C2-087-73372 S. Meridian Ave & W. Pawnee Ave. Wichita, Kansas
---------------------------------------------------------------------------------------------------------------------------------------------------------------------------------------------------------------------------------------------------------------	------------------------	-------------------------------------------------------------------------------------------------------------------------------------------------------

Source: ESRI and Burns & McDonnell Engineering.

Issued: October, 13 2016