

USE TYPEWRITER OR BALL POINT PEN-PRESS FIRMLY, PRINT CLEARLY.

T R EW sec 1/4 1/4 1/4 No.

WATER WELL RECORD  
KSA 82a-1201-1215

Kansas State Dept. Of Health  
(Water Well Contractors)  
Forbes-Bldg. 740  
Topeka, Kansas 66620

1 Location of well:	County <i>Kenosha</i>	Township name <i>RURAL</i>	Fraction <i>NW 1/4</i>	Section number <i>14</i>	Town number <i>28</i>	Range number <i>10</i>
---------------------	--------------------------	-------------------------------	---------------------------	-----------------------------	--------------------------	---------------------------

Distance and direction from nearest town or city: <i>2 miles East of Cunningham Kansas</i>	3 Owner of well: <i>FRANCIS E WILSON</i>
Street address of well location if in city: <i>2 miles South West</i>	Address: <i>CUNNINGHAM KANSAS 67035</i>

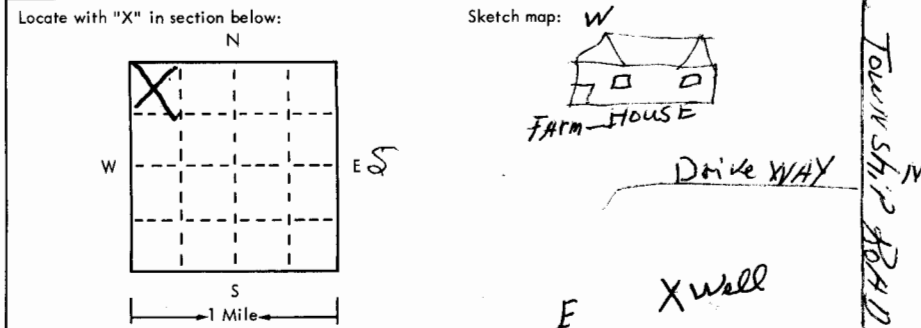

4 Well depth: <i>45</i> ft. Date of completion <i>6-27-75</i>
Well diameter <i>8</i> in.
5 <input type="checkbox"/> Cable tool <input checked="" type="checkbox"/> Rotary <input type="checkbox"/> Driven <input type="checkbox"/> Dug <input type="checkbox"/> Hollow rod <input type="checkbox"/> Jetted <input type="checkbox"/> Bored <input type="checkbox"/> Reverse rotary
6 Use: <input checked="" type="checkbox"/> Domestic <input type="checkbox"/> Public supply <input type="checkbox"/> Industry <input type="checkbox"/> Irrigation <input type="checkbox"/> Air conditioning <input type="checkbox"/> Commercial <input type="checkbox"/> Test well <input type="checkbox"/>
7 Casing: Material <i>PVC</i> Height: above/below Threaded <input type="checkbox"/> Welded <input type="checkbox"/> Surface <i>24</i> in. Diam <i>5</i> in. to <i>45</i> ft. depth Weight <i>200</i> lbs./ft. <i>1 foot</i> Drive shoe? <input type="checkbox"/> Yes <input checked="" type="checkbox"/> No

2	Type and color of material	From	To
	<i>Top Soil</i>	<i>0</i>	<i>1</i>
	<i>Brown clay</i>	<i>1</i>	<i>30</i>
	<i>Fine sand</i>	<i>30</i>	<i>35</i>
	<i>Course Gravel.</i>	<i>35</i>	<i>45</i>
	<i>45 feet TO THE Depth of well</i>		
	<i>clay Bottom</i>		
	(use a second sheet if needed)		

8 Screen: Manufacturer <i>JESS &amp; LOWELL</i> Type <i>PVC</i> Dia. <i>5"</i> Slot/gauze <i>1/16</i> Length <i>20</i> Set between <i>35</i> ft. and <i>45</i> ft. Fittings: Gravel pack <input checked="" type="checkbox"/> Yes <input type="checkbox"/> No Size range of material <i>1/4"</i>
9 Static water level: <i>35</i> ft. below land surface Date <i>6-27-75</i>
10 Pumping level below land surfaces: ____ ft. after ____ hrs. pumping ____ g.p.m. ____ ft. after <i>NA</i> hrs. pumping ____ g.p.m. Estimated maximum yield ____ g.p.m.
11 Water sample submitted: <input type="checkbox"/> Yes <input checked="" type="checkbox"/> No Date <i>6-27-75</i>
12 Well head completion: <i>WELL HOUSE</i> <input type="checkbox"/> Pitless adapter <i>24</i> inches above grade
13 Well grouted? <input checked="" type="checkbox"/> Yes <input type="checkbox"/> No <input checked="" type="checkbox"/> Neat cement <input type="checkbox"/> Bentonite <input type="checkbox"/> Depth: From <i>1</i> ft. to <i>10</i> ft.
14 Nearest source of possible contamination: ft. <i>175</i> Direction <i>SW</i> Type <i>SEPTIC TANK</i> Well disinfected upon completion? <input checked="" type="checkbox"/> Yes <input type="checkbox"/> No
15 Pump: <input type="checkbox"/> Not installed Manufacturer's name <i>BUNKS</i> Model number <i>101</i> HP <i>1/2</i> Volts <i>110</i> Length of drop pipe <i>39</i> ft. capacity <i>12</i> g.m.p. Type: <input type="checkbox"/> Submersible <input type="checkbox"/> Turbine <input checked="" type="checkbox"/> Jet <input type="checkbox"/> Reciprocating <input type="checkbox"/> Centrifugal <input type="checkbox"/> Other

16 Remarks: elevation

Topography:  
 Hill  
 Slope  
 Upland  
 Valley

17 Water well contractor's certification:  
This well was drilled under my jurisdiction and this report is true to the best of my knowledge and belief.  
*WEBER WELL SERVICE 226*  
Business name License No.  
Address *NASHVILLE KANSAS*  
Signed *John A. Weber* Date *6-27-75*  
Authorized representative