

WATER WELL RECORD

Form WWC-5

Division of Water Resources App. No.

1 LOCATION OF WATER WELL: County: Pratt	Fraction ¼ SE ¼ SW ¼ SE ¼	Section Number 4	Township No. T 28 S	Range Number R 13 <input type="checkbox"/> E <input checked="" type="checkbox"/> W
---	------------------------------	---------------------	------------------------	---

Street/Rural Address of Well Location; if unknown, distance & direction from nearest town or intersection: If at owner's address, check here .
1/2S of Pratt, KS

Global Positioning System (GPS) information:
 Latitude: (in decimal degrees)
 Longitude: (in decimal degrees)
 Elevation:
 Datum: WGS 84, NAD 83, NAD 27
 Collection Method:
 GPS unit (Make/Model:)
 Digital Map/Photo, Topographic Map, Land Survey
 Est. Accuracy: <3 m, 3-5 m, 5-15 m, >15 m

2 WATER WELL OWNER: Steve McClain
 RR#, Street Address, Box #: P O Box 1006
 City, State, ZIP Code : Pratt, KS 67124

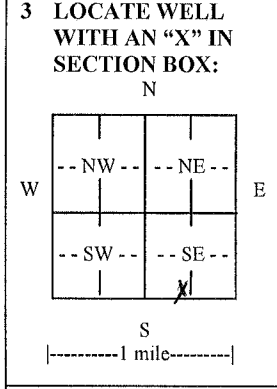

4 DEPTH OF COMPLETED WELL 35 ft.

Depth(s) Groundwater Encountered (1) 9 ft. (2) ft. (3) ft.

WELL'S STATIC WATER LEVEL 9 ft. below land surface measured on mo/day/yr. 11/01/12.....

Pump test data: Well water was ft. after hours pumping gpm

EST. YIELD 40 gpm. Well water was ft. after hours pumping gpm

Bore Hole Diameter in. to ft., and in. to ft.

WELL WATER TO BE USED AS: Public water supply Geothermal Injection well
 Domestic Feedlot Oil field water supply Dewatering Other (Specify below)
 Irrigation Industrial Domestic-lawn & garden Monitoring well

Was a chemical/bacteriological sample submitted to Department? Yes No

If yes, mo/day/yr sample was submitted.....

Water well disinfected? Yes No

5 TYPE OF CASING USED: Steel PVC Other

CASING JOINTS: Glued Clamped Welded Threaded

Casing diameter 5 in. to 25 ft., Diameter in. to ft., Diameter in. to ft.

Casing height above land surface 12 in., Weight 2.8 lbs./ft., Wall thickness or gauge No. Sch. 40

TYPE OF SCREEN OR PERFORATION MATERIAL:

Steel Stainless Steel PVC Other (Specify)

Brass Galvanized Steel None used (open hole)

SCREEN OR PERFORATION OPENINGS ARE:

Continuous slot Mill slot Gauze wrapped Torch cut Drilled holes None (open hole)
 Louvered shutter Key punched Wire wrapped Saw cut Other (specify)

SCREEN-PERFORATED INTERVALS: From 25 ft. to 35 ft., From ft. to ft.

GRAVEL PACK INTERVALS: From 23 ft. to 35 ft., From ft. to ft.

6 GROUT MATERIAL: Neat cement Cement grout Bentonite Other

Grout Intervals: From 0 ft. to 23 ft., From ft. to ft., From ft. to ft.

What is the nearest source of possible contamination:

Septic tank Lateral lines Pit privy Livestock pens Insecticide storage Other (specify below)
 Sewer lines Cesspool Sewage lagoon Fuel storage Abandoned water well
 Watertight sewer lines Seepage pit Feedyard Fertilizer storage Oil well/gas well house

Direction from well North Northwest Distance from well 87.....

FROM	TO	LITHOLOGIC LOG	FROM	TO	LITHO. LOG (cont.) or PLUGGING INTERVALS
0	1	top soil			
1	5	clay			
5	7	fine sand			
7	15	sand and gravel			
15	18	clay			
18	35	sand and gravel			

7 CONTRACTOR'S OR LANDOWNER'S CERTIFICATION: This water well was constructed, reconstructed, or plugged under my jurisdiction and was completed on (mo/day/year) 11/01/12..... and this record is true to the best of my knowledge and belief. Kansas Water Well Contractor's License No. 186..... This Water Well Record was completed on (mo/day/year) 11/11/12..... under the business name of Kelly's Water Well Service, Inc. by (signature) *Nathaniel R. Reed*

INSTRUCTIONS: Use typewriter or ball point pen. PLEASE PRESS FIRMLY and PRINT clearly. Please fill in blanks and check the correct answers. Send three copies (white, blue, pink) to Kansas Department of Health and Environment, Bureau of Water, Geology Section, 1000 SW Jackson St., Suite 420, Topeka, Kansas 66612-1367. Telephone 785-296-5524. Send one copy to WATER WELL OWNER and retain one for your records. Include fee of \$5.00 for each constructed well. Visit us at <http://www.kdheks.gov/waterwell/index.html>.

RECEIVED
JAN 02 2013
BUREAU OF WATER