

**WATER WELL RECORD**

**Form WWC-5**

Division of Water Resources App. No.

20110118

<b>1 LOCATION OF WATER WELL:</b> County: Kiowa	Fraction ¼ SW ¼ NE ¼ NE ¼	Section Number 5	Township No. T 28 S	Range Number R 18 <input type="checkbox"/> E <input checked="" type="checkbox"/> W
---	------------------------------	---------------------	------------------------	---

Street/Rural Address of Well Location; if unknown, distance & direction from nearest town or intersection: If at owner's address, check here .  
1N, 1/2W of Greensburg, KS

**Global Positioning System (GPS) information:**  
 Latitude: ..... (in decimal degrees)  
 Longitude: ..... (in decimal degrees)  
 Elevation: .....  
 Datum:  WGS 84,  NAD 83,  NAD 27  
 Collection Method:  
 GPS unit (Make/Model: .....)  
 Digital Map/Photo,  Topographic Map,  Land Survey  
 Est. Accuracy:  <3 m,  3-5 m,  5-15 m,  >15 m

**2 WATER WELL OWNER:** Dale Heft  
 RR#, Street Address, Box #: 16482 Highwav 183  
 City, State, ZIP Code : Greensburg, KS 67054

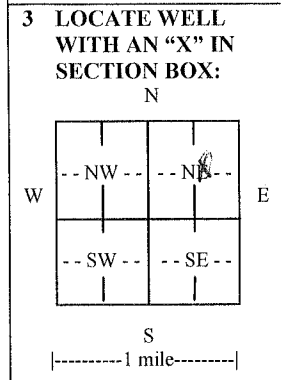

**4 DEPTH OF COMPLETED WELL** 106 ..... ft.  
 Depth(s) Groundwater Encountered (1).68 ..... ft. (2)..... ft. (3)..... ft.  
 WELL'S STATIC WATER LEVEL...68 .....ft. below land surface measured on mo/day/yr. 03/17/11.....  
 Pump test data: Well water was.....ft. after..... hours pumping..... gpm  
 EST. YIELD.70 .....gpm. Well water was.....ft. after..... hours pumping..... gpm  
 Bore Hole Diameter .....in. to .....ft., and .....in. to .....ft.  
 WELL WATER TO BE USED AS:  Public field water supply  Geothermal  Injection well  
 Domestic  Feedlot  Oil field water supply  Dewatering  Other (Specify below)  
 Irrigation  Industrial  Domestic-lawn & garden  Monitoring well .....  
 Was a chemical/bacteriological sample submitted to Department?  Yes  No  
 If yes, mo/day/yr sample was submitted.....  
 Water well disinfected?  Yes  No

**5 TYPE OF CASING USED:**  Steel  PVC  Other .....  
 CASING JOINTS:  Glued  Clamped  Welded  Threaded  
 Casing diameter .5 ..... in. to .86 ..... ft., Diameter ..... in. to ..... ft., Diameter ..... in. to ..... ft.  
 Casing height above land surface...12 ..... in., Weight 2.8 .....lbs./ft., Wall thickness or gauge No. Sch. 40.....  
 TYPE OF SCREEN OR PERFORATION MATERIAL:  
 Steel  Stainless Steel  PVC  Other (Specify) .....  
 Brass  Galvanized Steel  None used (open hole)  
 SCREEN OR PERFORATION OPENINGS ARE:  
 Continuous slot  Mill slot  Gauze wrapped  Torch cut  Drilled holes  None (open hole)  
 Louvered shutter  Key punched  Wire wrapped  Saw cut  Other (specify) .....  
 SCREEN-PERFORATED INTERVALS: From...86 ..... ft. to ...106 ..... ft., From ..... ft. to ..... ft.  
 GRAVEL PACK INTERVALS: From...23 ..... ft. to ...106 ..... ft., From ..... ft. to ..... ft.  
 From ..... ft. to ..... ft., From ..... ft. to ..... ft.

**6 GROUT MATERIAL:**  Neat cement  Cement grout  Bentonite  Other .....  
 Grout Intervals: From 0 ..... ft. to .23 ..... ft., From ..... ft. to ..... ft., From ..... ft. to ..... ft.  
 What is the nearest source of possible contamination:  
 Septic tank  Lateral lines  Pit privy  Livestock pens  Insecticide storage  Other (specify below)  
 Sewer lines  Cesspool  Sewage lagoon  Fuel storage  Abandoned water well  
 Watertight sewer lines  Seepage pit  Feedyard  Fertilizer storage  Oil well/gas well .....  
 Direction from well North ..... Distance from well ...125.....

FROM	TO	LITHOLOGIC LOG	FROM	TO	LITHO. LOG (cont.) or PLUGGING INTERVALS
0	16	top sand			
16	45	clay			Heft #2-5
45	106	sand and gravel with clay bottom			
					Sterling Drilling Company
					P O Box 1006
					Pratt, KS 67124

**7 CONTRACTOR'S OR LANDOWNER'S CERTIFICATION:** This water well was  constructed,  reconstructed, or  plugged under my jurisdiction and was completed on (mo/day/year) 03/17/11..... and this record is true to the best of my knowledge and belief. Kansas Water Well Contractor's License No. 186..... This Water Well Record was completed on (mo/day/year) 04/09/11..... under the business name of Kelly's Water Well Service, Inc..... by (signature) *Kathryn P. Hall*.....

**INSTRUCTIONS:** Use typewriter or ball point pen. PLEASE PRESS FIRMLY and PRINT clearly. Please fill in blanks and check the correct answers. Send three copies (white, blue, pink) to Kansas Department of Health and Environment, Bureau of Water, Geology Section, 1000 SW Jackson St., Suite 420, Topeka, Kansas 66612-1367. Telephone 785-296-5522. Send one copy to WATER WELL OWNER and retain one for your records. Include fee of \$5.00 for each constructed well. Visit us at <http://www.kdheks.gov/waterwell/index.html>.

5-28-18 W

**STERLING DRILLING COMPANY**

P.O. Box 1006  
Pratt, Kansas 67124-1006  
Phone (620) 672-9508  
Federal ID #: 48-1185919

WATER WELL ACCEPTANCE AGREEMENT

Water Well Name: Heft #2-5  
Water Well Location: Section 56 Township 28s Range R. 40 18w  
County Kiowa  
Water Well Location (footage): 4500' FSL & 740' FEL Section 2  
Board of Agriculture, Division of Water Resources Application Number: 20110018



This agreement between Sterling Drilling Company, P.O. Box 1006, Pratt, Kansas, 67124, and

Dale Heft

certifies that they accept the above listed water well that was drilled by Kelly's Water Well Service, Great Bend, Kansas, located approximately 4500' FSL & 740' FEL of Section 2 Township 28s Range 18w Kiowa County Kansas for domestic use only and when the well is no longer needed agrees to plug the well in accordance with the State Regulation KAR 28-30-7.

By signing this agreement, landowner releases Sterling Drilling Company from any further responsibilities relating to the water well described above. Landowner also agrees to allow Sterling Drilling use of this water well for any future drilling operations within 3,000 feet of this water well and occurring within the next 3 years from this date. A fee of \$250.00 would be paid to the landowner each time Sterling used this water well for said purpose. Sterling Drilling would be responsible for payment of any fees for state and/or county permits required at that time.

April 13, 2011  
Date

Gary M. Talbott  
Gary M Talbott  
Operations Manager  
Sterling Drilling Company

4-14-2011  
Date

Dale Heft  
Dale Heft  
Landowner

Copy of the WWC-5 and permits attached