

WATER WELL PLUGGING RECORD Form WWC-5P

KSA 82a-1212

ID NO.

IW 3

1 LOCATION OF WATER WELL: County: <u>Kiowa</u>	Fraction <u>¼ sw ¼ ne ¼ ne ¼</u>	Section Number <u>16</u>	Township Number <u>T 28 S</u>	Range Number <u>19</u> <input type="checkbox"/> E <input checked="" type="checkbox"/> W
--	-------------------------------------	-----------------------------	----------------------------------	--

Street/Rural Address of Well Location; if unknown, distance & direction from nearest town or intersection: If at owner's address, check here ANR Pipeline Company
15499 Avenue 19
Greensburg, KS 67054

Global Positioning Systems (GPS) information:
Latitude: 37.612822 (in decimal degrees)
Longitude: -99.39705 (in decimal degrees)
Elevation: 2280
Horizontal Datum: WGS84, NAD83, NAD27
Collection Method:

2 WATER WELL OWNER: ANR Pipeline Company
RR#, St. Address, Box #: 717 Texas Avenue #2400
City, State ZIP Code: Houston, TX 77002

GPS unit (Make/Model): _____
 Digital Map/Photo, Topographic Map, Land Survey
Est. Accuracy: < 3 m, 3-5 m, 5-15 m, > 15 m

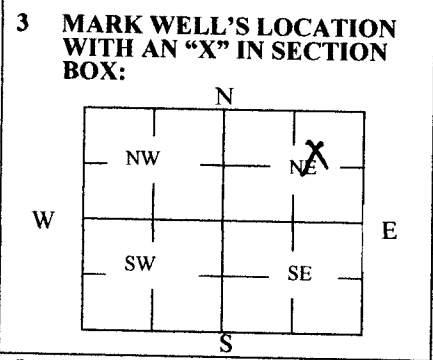

4 DEPTH OF WELL 60 ft.

WELL'S STATIC WATER LEVEL _____ ft.

WELL WAS USED AS:

<input type="checkbox"/> Domestic	<input type="checkbox"/> Public Water Supply	<input type="checkbox"/> Dewatering
<input type="checkbox"/> Irrigation	<input type="checkbox"/> Oil Field Water Supply	<input type="checkbox"/> Monitoring
<input type="checkbox"/> Feedlot	<input type="checkbox"/> Domestic (Lawn & Garden)	<input checked="" type="checkbox"/> Injection Well
<input type="checkbox"/> Industrial	<input type="checkbox"/> Air Conditioning	<input type="checkbox"/> Other <u>IW-3</u>

Was a chemical/bacteriological sample submitted to Department? Yes No

5 TYPE OF BLANK CASING USED:

<input type="checkbox"/> Steel	<input type="checkbox"/> RMP (SR)	<input type="checkbox"/> Wrought	<input type="checkbox"/> Fiberglass	<input type="checkbox"/> Other (Specify below)
<input checked="" type="checkbox"/> PVC	<input type="checkbox"/> ABS	<input type="checkbox"/> Asbestos-Cement	<input type="checkbox"/> Concrete Tile	

Blank casing diameter 2 in. Was casing pulled? Yes No If yes, how much 3-feet
Casing height above or below land surface 0 in.

6 GROUT PLUG MATERIAL: Neat cement Cement grout Bentonite Other 0.5 to 3' Topsoil/Seed

Grout Plug Intervals: From 3 ft. to 60 ft., From N/A ft. to N/A ft., From N/A ft. to N/A ft.

What is the nearest source of possible contamination:

<input type="checkbox"/> Septic tank	<input type="checkbox"/> Seepage pit	<input type="checkbox"/> Fuel storage	<input checked="" type="checkbox"/> Other (specify below)
<input type="checkbox"/> Sewer lines	<input type="checkbox"/> Pit privy	<input type="checkbox"/> Fertilizer storage	<u>Natural Gas Compressor Station</u>
<input type="checkbox"/> Watertight sewer lines	<input type="checkbox"/> Sewage lagoon	<input type="checkbox"/> Insecticide storage	
<input type="checkbox"/> Lateral lines	<input type="checkbox"/> Feedyard	<input type="checkbox"/> Abandoned water well	Direction from well? <u>Adjacent</u>
<input type="checkbox"/> Cess pool	<input type="checkbox"/> Livestock pens	<input type="checkbox"/> Oil well/Gas well	How many feet? <u>0</u> -feet

FROM	TO	PLUGGING MATERIALS	FROM	TO	PLUGGING MATERIALS
0	0.5	Topsoil/Grass Seed			
0.5	60	Bentonite (hydrated)			

7 CONTRACTOR'S OR LANDOWNER'S CERTIFICATION: This water well was plugged under my jurisdiction and was completed on (mo/day/year) 8/10/2020 and this record is true to the best of my knowledge and belief. Kansas Water Well Contractor's License No. 759. This Water Well Record was completed on (mo/day/year) 8/22/2020 under the business name of RAZEK Environmental, LLC by (signature) *[Signature]*

Send one white copy to Kansas Department of Health & Environment, Geology Section, 1000 SW Jackson Street, Ste. 420, Topeka, KS 66612-1367. Send one copy to WATER WELL OWNER and retain one for your records.
Visit us at <http://www.kdheks.gov/waterwell/index.html> Telephone 785-296-5524.